

ENFORCEMENT REGISTER INFORMATION SHEET

E/765		
APPEAL	yes	no
Plan'y Ref		

ADDRESS

LAND AT
SUNDAYS HILL FARM
BRINKWORTH

Plotted 1/2/96 SU 0064 8599

BREACH of CONTROL

SEE ATTACHED NOTICE

Issuing Authority NWDC

Date Issued 31.1.96

STOP NOTICES

Date Served

Requiring

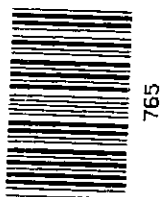

Date(s) served

31.1.96

Takes effect 10.4.96

Compliance by 10.10.96

Dates Extended by
Secretary of State

Date withdrawn

REQUIREMENTS of ENFORCEMENT

SEE ATTACHED NOTICE

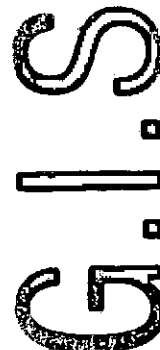

EXTENT to WHICH NOTICE COMPLIED WITH (dates)

IMPORTANT

THIS COMMUNICATION AFFECTS YOUR PROPERTY

District Secretary's Department
G C Betteridge, LL.B, FCIS, FBIM, (Solicitor)

Our Ref: PT/CG E765

*North
Wiltshire
District
Council*

Monkton Park, Chippenham
Wiltshire SN15 1 ER
Telephone (01249) 443322 (Ext 598)

31 January 1996

Dear Sir/Madam

TOWN AND COUNTY PLANNING ACT 1990

ENFORCEMENT NOTICE

Land at Sundays Hill Farm, Brinkworth, Chippenham, Wiltshire.

The Council have issued an Enforcement Notice relating to the above land and I now serve on you a copy of that Notice, in view of your interest in the land. Unless an appeal is made to the Secretary of State as described below, the Notice will take effect on the date shown below and you must then ensure that the required steps for which you may be held responsible are taken within the period or periods specified in the Notice.

If you wish to appeal against the Notice, you should first read carefully the enclosed booklet entitled "Enforcement Notice Appeals - A Guide to Procedure". Then you or your agent should complete the enclosed appeal form and send it, together with the extra copy of the Enforcement Notice enclosed herewith, to the address on the appeal form. Your appeal must be received by the Department of the Environment before the notice takes effect.

There is a requirement on the Council to specify the reasons why the local planning authority consider it expedient to issue the Notice and these reasons are set out in the Notice.

Yours faithfully

G.C. Betteridge

DISTRICT SECRETARY

*DATE ON WHICH THE NOTICE TAKES EFFECT AND BEFORE WHICH ANY APPEAL MUST BE
RECEIVED 10 April 1996*

To Mr G Vines
Sundays Hill Farm
Brinkworth
Chippenham
Wiltshire

Miss G Vines
c/o Sundays Hill Farm
Brinkworth
Chippenham
Wiltshire

E765

TOWN AND COUNTRY PLANNING ACT 1990

ENFORCEMENT NOTICE

Sundays Hill Farm, Brinkworth, Chippenham, Wiltshire

WHEREAS

1. It appears to the North Wiltshire District Council ("the Council") being the local planning authority for the purposes of Section 172 of the Town and Country Planning Act 1990 ("the Act") in this matter, that there has been a breach of planning control within the last ten years on the land or premises ("the land") described in Schedule 1 below.
2. The breach of planning control which appears to have taken place consists in the carrying out of development by the making of the material change in the use of the land described in Schedule 2 overleaf without the grant of planning permission required for that development.
3. The Council consider it expedient, having regard to the provisions of the development plan and to all other material considerations, to issue this enforcement notice, in exercise of their powers in the said Section 172 for the reasons set out in this notice.

NOTICE IS HEREBY GIVEN that the Council require that the steps specified in Schedule 3 overleaf be taken in order to remedy the breach within the period of six months from the date on which this Notice takes effect.

Subject to the provisions of Section 175(A) the Act
THIS NOTICE SHALL TAKE EFFECT on 10 APRIL 1996

G.C. Bittindge

DISTRICT SECRETARY

DATED 31 January 1996

E765

Schedule 1 - Land or Premises to which this Notice relates

Land at Sundays Hill Farm, Brinkworth, Chippenham, Wiltshire, shown stippled on the attached plan.

Schedule 2 - Alleged Breach of Planning Control

The making of an unauthorised material change of use of the land from agricultural use to that use and use for the stationing of a residential caravan.

Schedule 3 - Steps required to be taken

1. To cease the unauthorised use of the land for the stationing of a residential caravan.
2. To remove the said caravan and any associated plinth or foundation from the land
3. To restore the land to a condition suitable for agricultural use.

TIME FOR COMPLIANCE - 6 MONTHS

Reasons for the Issue of this Notice

1. The site lies outside the framework or physical limits of any established settlement, in an area in respect of which it is the policy of the local planning authority, in the interests of rural amenity that only development essential to agricultural need or otherwise appropriate to a rural area shall be permitted. Such an essential agricultural or other need has not been demonstrated.
2. The siting of the caravan constitutes isolated and sporadic development within open countryside which is detrimental to the character of this area in particular and rural amenity in general.

ENFORCEMENT NOTICE

Important - This Communication affects your PROPERTY

E (E765)

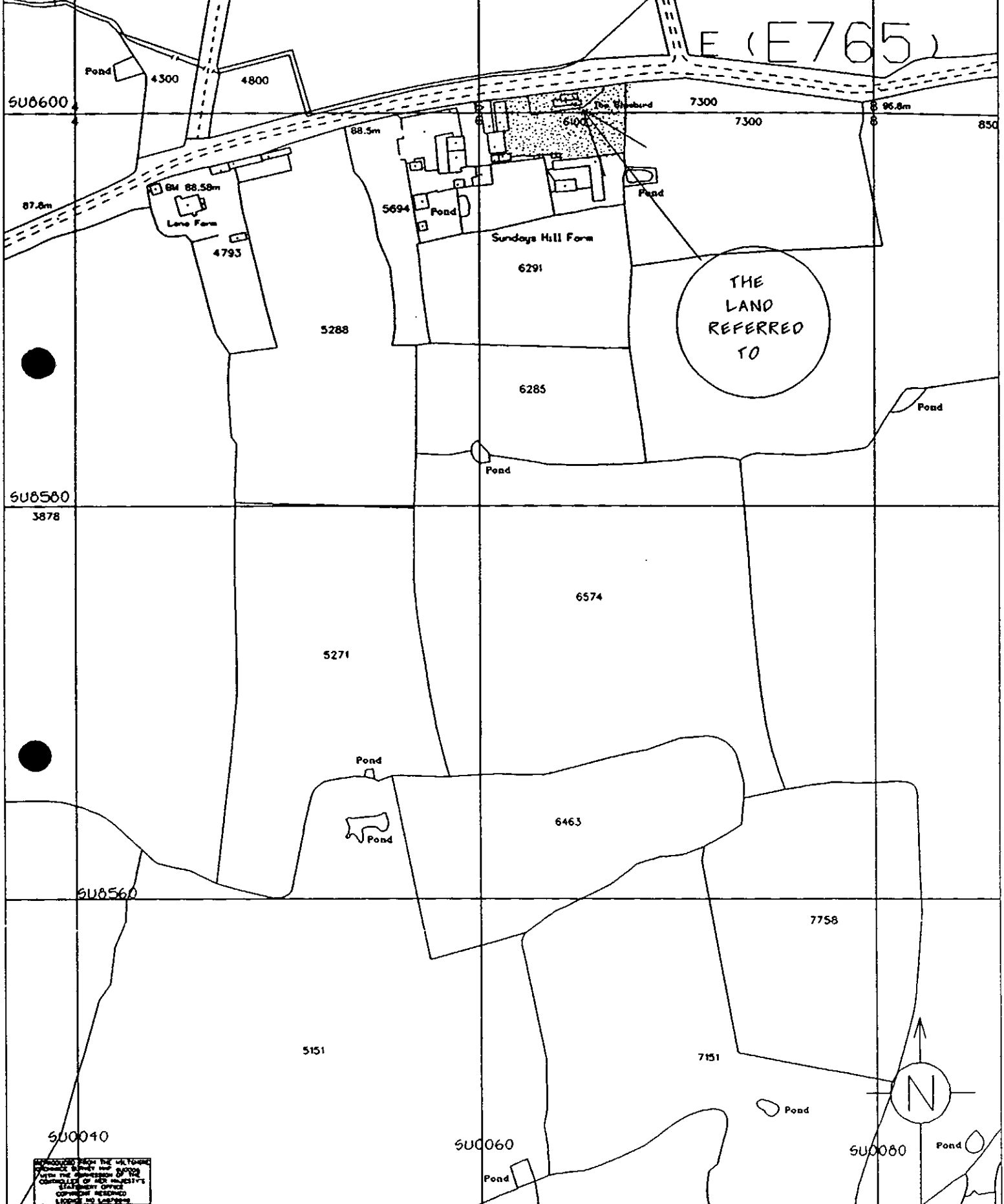

REPRODUCED FROM THE ORIGINAL
PLANNING NOTICE MAP SU0080
FOR THE PURPOSES OF THE
TOWN & COUNTRY PLANNING ACT 1990
COUNCIL'S OFFICE
COUNCIL HOUSE
WILTON, WILTSHIRE

IMPORTANT

THIS COMMUNICATION AFFECTS YOUR PROPERTY

District Secretary's Department
G C Betteridge, LL.B, FCIS, FBIM, (Solicitor)

Our Ref: PT/CG E765

31 January 1996

*North
Wiltshire
District
Council*

Monkton Park, Chippenham
Wiltshire SN15 1 ER
Telephone (01249) 443322 (Ext 598)

Dear Sir/Madam

TOWN AND COUNTY PLANNING ACT 1990

ENFORCEMENT NOTICE

Land at Sundays Hill Farm, Brinkworth, Chippenham, Wiltshire.

The Council have issued an Enforcement Notice relating to the above land and I now serve on you a copy of that Notice, in view of your interest in the land. Unless an appeal is made to the Secretary of State as described below, the Notice will take effect on the date shown below and you must then ensure that the required steps for which you may be held responsible are taken within the period or periods specified in the Notice.

If you wish to appeal against the Notice, you should first read carefully the enclosed booklet entitled "Enforcement Notice Appeals - A Guide to Procedure". Then you or your agent should complete the enclosed appeal form and send it, together with the extra copy of the Enforcement Notice enclosed herewith, to the address on the appeal form. Your appeal must be received by the Department of the Environment before the notice takes effect.

There is a requirement on the Council to specify the reasons why the local planning authority consider it expedient to issue the Notice and these reasons are set out in the Notice.

Yours faithfully

G.C. Betteridge

DISTRICT SECRETARY

DATE ON WHICH THE NOTICE TAKES EFFECT AND BEFORE WHICH ANY APPEAL MUST BE RECEIVED 10 April 1996

To Mr G Vines
Sundays Hill Farm
Brinkworth
Chippenham
Wiltshire

Miss G Vines
c/o Sundays Hill Farm
Brinkworth
Chippenham
Wiltshire

E 765

TOWN AND COUNTRY PLANNING ACT 1990

ENFORCEMENT NOTICE

Sundays Hill Farm, Brinkworth, Chippenham, Wiltshire

WHEREAS

1. It appears to the North Wiltshire District Council ("the Council") being the local planning authority for the purposes of Section 172 of the Town and Country Planning Act 1990 ("the Act") in this matter, that there has been a breach of planning control within the last ten years on the land or premises ("the land") described in Schedule 1 below.
2. The breach of planning control which appears to have taken place consists in the carrying out of development by the making of the material change in the use of the land described in Schedule 2 overleaf without the grant of planning permission required for that development.
3. The Council consider it expedient, having regard to the provisions of the development plan and to all other material considerations, to issue this enforcement notice, in exercise of their powers in the said Section 172 for the reasons set out in this notice.

NOTICE IS HEREBY GIVEN that the Council require that the steps specified in Schedule 3 overleaf be taken in order to remedy the breach within the period of six months from the date on which this Notice takes effect.

Subject to the provisions of Section 175(A) the Act
THIS NOTICE SHALL TAKE EFFECT on 10 APRIL 1996

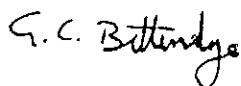

DISTRICT SECRETARY

DATED 31 January 1996

E765

Schedule 1 - Land or Premises to which this Notice relates

Land at Sundays Hill Farm, Brinkworth, Chippenham, Wiltshire, shown stippled on the attached plan.

Schedule 2 - Alleged Breach of Planning Control

The making of an unauthorised material change of use of the land from agricultural use to that use and use for the stationing of a residential caravan.

Schedule 3 - Steps required to be taken

1. To cease the unauthorised use of the land for the stationing of a residential caravan.
2. To remove the said caravan and any associated plinth or foundation from the land
3. To restore the land to a condition suitable for agricultural use.

TIME FOR COMPLIANCE - 6 MONTHS

Reasons for the Issue of this Notice

1. The site lies outside the framework or physical limits of any established settlement, in an area in respect of which it is the policy of the local planning authority, in the interests of rural amenity that only development essential to agricultural need or otherwise appropriate to a rural area shall be permitted. Such an essential agricultural or other need has not been demonstrated.
2. The siting of the caravan constitutes isolated and sporadic development within open countryside which is detrimental to the character of this area in particular and rural amenity in general.

ENFORCEMENT NOTICE

Important - This Communication affects your PROPERTY

E (E765)

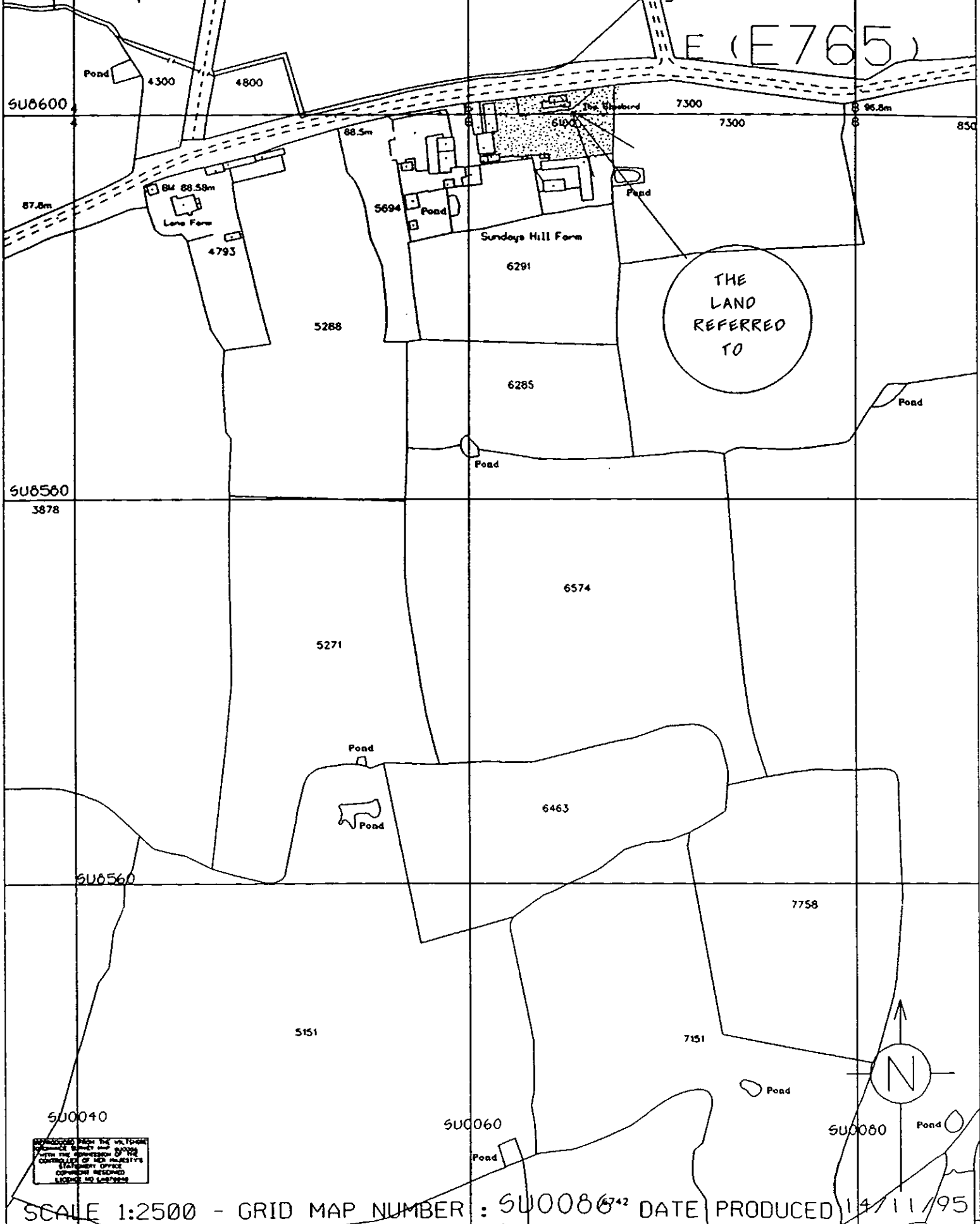

Information from the Wiltshire
Council's Survey and
Planning Department
Copyright reserved
1995 10/10/95

IMPORTANT

**THIS COMMUNICATION AFFECTS
YOUR PROPERTY**

District Secretary's Department
G C Betteridge, LL.B, FCIS, FBIM, (Solicitor)

Our Ref: PT/CG E765

E765
*North
Wiltshire
District
Council*

Monkton Park, Chippenham
Wiltshire SN15 1 ER
Telephone (01249) 443322 (Ext 598)

31 January 1996

Dear Sir/Madam

TOWN AND COUNTY PLANNING ACT 1990

ENFORCEMENT NOTICE

Land at Sundays Hill Farm, Brinkworth, Chippenham, Wiltshire.

The Council have issued an Enforcement Notice relating to the above land and I now serve on you a copy of that Notice, in view of your interest in the land. Unless an appeal is made to the Secretary of State as described below, the Notice will take effect on the date shown below and you must then ensure that the required steps for which you may be held responsible are taken within the period or periods specified in the Notice.

If you wish to appeal against the Notice, you should first read carefully the enclosed booklet entitled "Enforcement Notice Appeals - A Guide to Procedure". Then you or your agent should complete the enclosed appeal form and send it, together with the extra copy of the Enforcement Notice enclosed herewith, to the address on the appeal form. Your appeal must be received by the Department of the Environment before the notice takes effect.

There is a requirement on the Council to specify the reasons why the local planning authority consider it expedient to issue the Notice and these reasons are set out in the Notice.

Yours faithfully

G.C. Betteridge

DISTRICT SECRETARY

DATE ON WHICH THE NOTICE TAKES EFFECT AND BEFORE WHICH ANY APPEAL MUST BE RECEIVED 10 April 1996

To Mr G Vines
Sundays Hill Farm
Brinkworth
Chippenham
Wiltshire

Miss G Vines
c/o Sundays Hill Farm
Brinkworth
Chippenham
Wiltshire

E765

TOWN AND COUNTRY PLANNING ACT 1990

ENFORCEMENT NOTICE

Sundays Hill Farm, Brinkworth, Chippenham, Wiltshire

WHEREAS

1. It appears to the North Wiltshire District Council ("the Council") being the local planning authority for the purposes of Section 172 of the Town and Country Planning Act 1990 ("the Act") in this matter, that there has been a breach of planning control within the last ten years on the land or premises ("the land") described in Schedule 1 below.
2. The breach of planning control which appears to have taken place consists in the carrying out of development by the making of the material change in the use of the land described in Schedule 2 overleaf without the grant of planning permission required for that development.
3. The Council consider it expedient, having regard to the provisions of the development plan and to all other material considerations, to issue this enforcement notice, in exercise of their powers in the said Section 172 for the reasons set out in this notice.

NOTICE IS HEREBY GIVEN that the Council require that the steps specified in Schedule 3 overleaf be taken in order to remedy the breach within the period of six months from the date on which this Notice takes effect.

Subject to the provisions of Section 175(A) the Act
THIS NOTICE SHALL TAKE EFFECT on 10 APRIL 1996

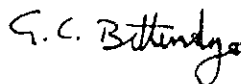

DISTRICT SECRETARY

DATED 31 January 1996

E765

Schedule 1 - Land or Premises to which this Notice relates

Land at Sundays Hill Farm, Brinkworth, Chippenham, Wiltshire, shown stippled on the attached plan.

Schedule 2 - Alleged Breach of Planning Control

The making of an unauthorised material change of use of the land from agricultural use to that use and use for the stationing of a residential caravan.

Schedule 3 - Steps required to be taken

1. To cease the unauthorised use of the land for the stationing of a residential caravan.
2. To remove the said caravan and any associated plinth or foundation from the land
3. To restore the land to a condition suitable for agricultural use.

TIME FOR COMPLIANCE - 6 MONTHS

Reasons for the Issue of this Notice

1. The site lies outside the framework or physical limits of any established settlement, in an area in respect of which it is the policy of the local planning authority, in the interests of rural amenity that only development essential to agricultural need or otherwise appropriate to a rural area shall be permitted. Such an essential agricultural or other need has not been demonstrated.
2. The siting of the caravan constitutes isolated and sporadic development within open countryside which is detrimental to the character of this area in particular and rural amenity in general.

ENFORCEMENT NOTICE

Important - This Communication affects your PROPERTY

E (E765)

