

NORTH WILTSHIRE DISTRICT COUNCIL

# ENFORCEMENT INFORMATION

# REGISTER SHEET

Plotted  
10-1-94  
8ue

APPEALED  
11/1/94

**E/** 731

APPEAL yes no

Plan's Ref

## ADDRESS

LAND AT:  
UPPER DAUNTSAY LODGE FARM  
SODOM LANE  
DAUNTSAY

## BREACH of CONTROL

SEE ATTACHED NOTICE

Issuing Authority NWDC

Date Issued 25.11.93

## STOP NOTICES

Date Served

Requiring



731

Date(s) served

25.11.93

Takes effect 5.1.94

Compliance by 5.7.94

Dates Extended by  
Secretary of State

Date withdrawn

## REQUIREMENTS of ENFORCEMENT

SEE ATTACHED NOTICE

**G.I.S.**

EXTENT to WHICH NOTICE COMPLIED WITH (dates)

**IMPORTANT -**

**THIS COMMUNICATION AFFECTS  
YOUR PROPERTY**

District Secretary's Department,

G.C. Betteridge, LL.B. (Solicitor), District Secretary

DX 34208 Fax (0249) 443152

tel: CHIPPENHAM (0249) 443322 ext: 598 Miss R. Hind

**E** 731 A

*CHARGE OF  
LOCAL DATA  
North  
Wiltshire*

**NORTH WILTSHIRE DISTRICT COUNCIL  
Monkton Park, CHIPPENHAM, SN15 1EF**

Dear Sir/Madam,

8th February 1994

**NORTH WILTSHIRE DISTRICT COUNCIL**

**TOWN AND COUNTRY PLANNING ACT 1990**

# **ENFORCEMENT NOTICE**

Land at Upper Dauntsey Lodge Farm, Sodom Lane, Dauntsey, Wiltshire

The Council have issued an Enforcement Notice relating to the above land and I now serve on you a copy of that Notice, in view of your interest in the land. Unless an appeal is made to the Secretary of State as described below, the Notice will take effect on the date shown in the box below and you must then ensure that the required steps for which you may be held responsible are taken within the period or periods specified in the Notice.

If you wish to appeal against the Notice, you should first read carefully the enclosed booklet entitled "Enforcement Notice Appeals - A Guide to Procedure". Then, you or your agent should complete the enclosed appeal form and send it, together with the extra copy of the Enforcement Notice enclosed herewith to the address on the appeal form. Your appeal **MUST BE RECEIVED** by the Department of the Environment **BEFORE THE NOTICE TAKES EFFECT**.

There is a requirement on the Council to specify the reasons why the local planning authority consider it expedient to issue the Notice and these reasons are set out in the Notice.

Yours faithfully,

*G.C. Betteridge*

District Secretary

**DATE ON WHICH NOTICE TAKES EFFECT  
AND BEFORE WHICH ANY APPEAL  
MUST BE RECEIVED** 22nd March 1994

**To:** Mr. W. D. Matthews  
Upper Dauntsey Lodge  
Dauntsey  
Nr. Chippenham  
SN16 9 AZ

Mrs. K. M. Matthews  
Upper Dauntsey Lodge  
Dauntsey  
Nr. Chippenham  
SN16 9 AZ

NORTH WILTSHIRE DISTRICT COUNCIL  
TOWN AND COUNTRY PLANNING ACT 1990  
**ENFORCEMENT NOTICE**

Land at Upper Dauntsey Lodge Farm, Sodom Lane,

Dauntsey, Nr Chippenham, Wiltshire

WHEREAS :

- (1) It appears to the North Wiltshire District Council ("the Council") being the local planning authority for the purposes of Section 172 of the Town and Country Planning Act 1990 ("the Act") in this matter, that there has been a breach of planning control within the period of four years before the date of issue of this Notice on the land or premises ("the land") described in Schedule 1 below;
- (2) The breach of planning control which appears to have taken place consists in the carrying out of development by the making of the material change in the use of the land described in Schedule 2 below, without the grant of planning permission required for that development.
- (3) The Council consider it expedient, having regard to the provisions of the development plan and to all other material considerations, to issue this enforcement notice, in exercise of their powers contained in the said Section 172, for the reasons set out below.

NOTICE IS HEREBY GIVEN that the Council require that the steps specified in Schedule 3 below be taken in order to remedy the breach within the period of SIX MONTHS from the date on which this Notice takes effect.

THIS NOTICE SHALL TAKE EFFECT, subject to the provisions of Section 175(4) of the Act, on 18th March 1994

ISSUED 8th February 1994

Signed

G.C. Bellardie

Monkton Park,  
Chippenham, SN15 1ER

SCHEDULE 1 - LAND OR PREMISES TO WHICH THIS NOTICE RELATES

Land at Upper Dauntsey Lodge Farm, Sodom Lane, Dauntsey near Chippenham, Wiltshire, shown stippled on the attached plan

SCHEDULE 2 - ALLEGED BREACH OF PLANNING CONTROL

The making of a material change in the use of part of the land, that is the building shown stippled on the attached plan, from agricultural use to residential use.

SCHEDULE 3 - STEPS REQUIRED TO BE TAKEN

To cease the residential use of the building referred to in Schedule 2 above.

REASONS FOR ISSUE

This development is contrary to policy H19 of the North East Wiltshire Sturcture Plan and policy H10 of the adopted North Wiltshire Local Plan which directs new residential development to existing settlements unless essential for the needs of agriculture. Although an agricutural case has been put forward it is not considered sufficient to overcome the strong policy considerations against new dwellings in the countryside.

E 731

997 Downbury

998

999

NORTH WILTSHIRE DISTRICT COUNCIL

TOWN AND COUNTRY PLANNING ACT 1990

ENFORCEMENT

NOTICE

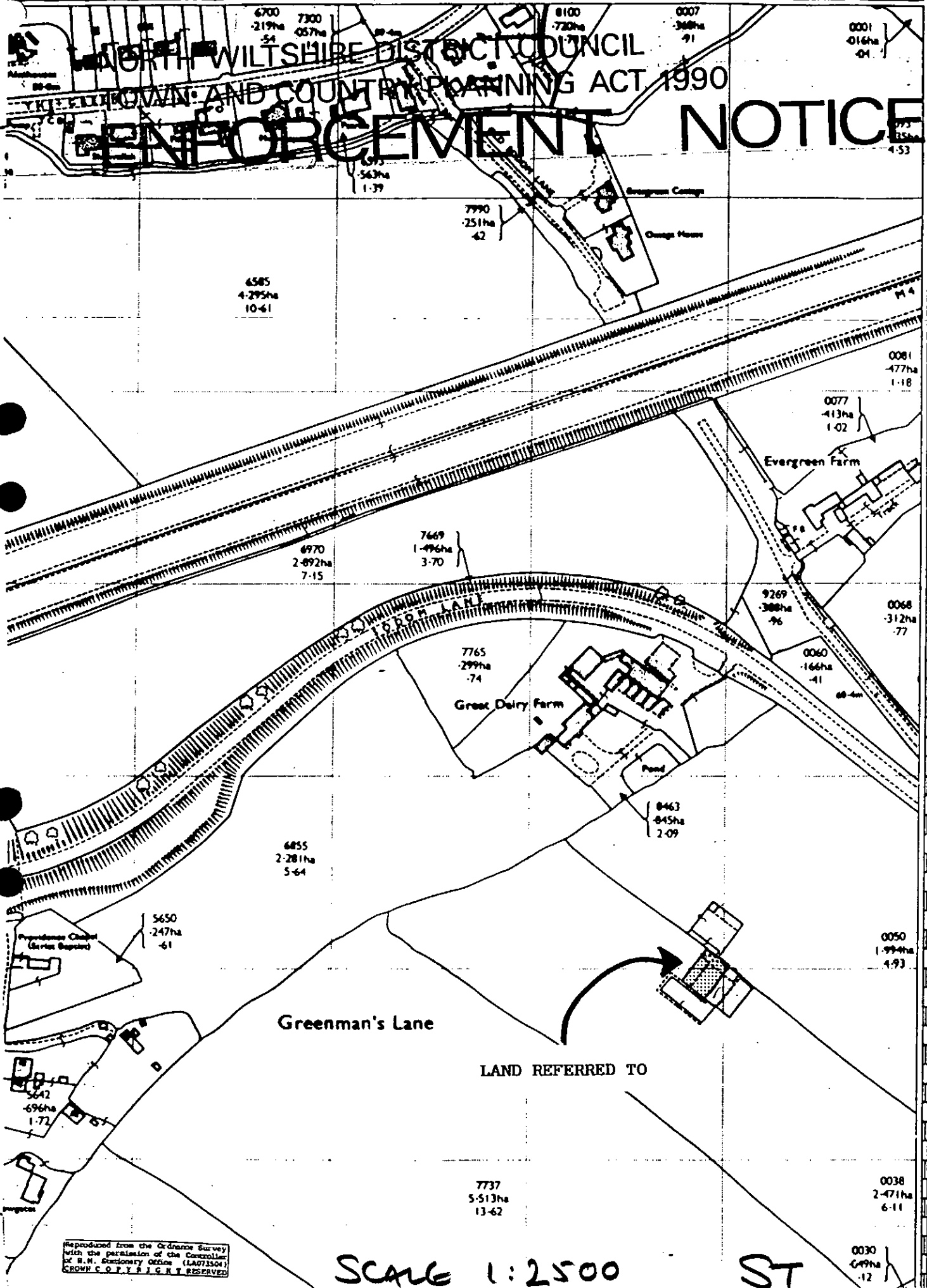

**IMPORTANT -**

**THIS COMMUNICATION AFFECTS  
YOUR PROPERTY**

District Secretary's Department,  
G.C. Betteridge, LL.B. (Solicitor), District Secretary

DX 34208 Fax (0249) 443152

tel: CHIPPENHAM (0249) 443322 ext: 598 Miss R. Hind

**E**

731

*North  
Wiltshire*

NORTH WILTSHIRE DISTRICT COUNCIL  
Monkton Park, CHIPPENHAM, SN15 1EF

Dear Sir/Madam,

25th November 1993

**NORTH WILTSHIRE DISTRICT COUNCIL**

**TOWN AND COUNTRY PLANNING ACT 1990**

# **ENFORCEMENT NOTICE**

Land at Upper Dauntsey Lodge Farm, Sodom Lane, Dauntsey, Wiltshire

The Council have issued an Enforcement Notice relating to the above land and I now serve on you a copy of that Notice, in view of your interest in the land. Unless an appeal is made to the Secretary of State as described below, the Notice will take effect on the date shown in the box below and you must then ensure that the required steps for which you may be held responsible are taken within the period or periods specified in the Notice.

If you wish to appeal against the Notice, you should first read carefully the enclosed booklet entitled "Enforcement Notice Appeals - A Guide to Procedure". Then, you or your agent should complete the enclosed appeal form and send it, together with the extra copy of the Enforcement Notice enclosed herewith to the address on the appeal form. Your appeal **MUST BE RECEIVED** by the Department of the Environment **BEFORE THE NOTICE TAKES EFFECT**.

There is a requirement on the Council to specify the reasons why the local planning authority consider it expedient to issue the Notice and these reasons are set out in the Notice.

Yours faithfully,



District Secretary

DATE ON WHICH NOTICE TAKES EFFECT  
AND BEFORE WHICH ANY APPEAL  
MUST BE RECEIVED 5th January 1994

To: Mr. W. D. Matthews  
Upper Dauntsey Lodge  
Dauntsey  
Nr. Chippenham  
SN16 9 AZ

Mrs. K. M. Matthews  
Upper Dauntsey Lodge  
Dauntsey  
Nr. Chippenham  
SN16 9 AZ

# NORTH WILTSHIRE DISTRICT COUNCIL TOWN AND COUNTRY PLANNING ACT 1990 ENFORCEMENT NOTICE

land at Upper Dauntsey Lodge Farm, Sodom Lane, Dauntsey, near

Chippenham, Wiltshire

WHEREAS :

- (1) It appears to the North Wiltshire District Council ("the Council") being the local planning authority for the purposes of Section 172 of the Town and Country Planning Act 1990 ("the Act") in this matter, that there has been a breach of planning control within the last ten years on the land or premises ("the land") described in Schedule 1 below.
- (2) The breach of planning control which appears to have taken place consists in the carrying out of development by the making of the material change in the use of the land described in Schedule 2 below, without the grant of planning permission required for that development.
- (3) The Council consider it expedient, having regard to the provisions of the development plan and to all other material considerations, to issue this enforcement notice, in exercise of their powers contained in the said Section 172, for the reasons set out below.

NOTICE IS HEREBY GIVEN that the Council require that the steps specified in Schedule 3 below be taken in order to remedy the breach within the period of SIX MONTHS from the date on which this Notice takes effect.

THIS NOTICE SHALL TAKE EFFECT, subject to the provisions of Section 175(4) of the Act, on 5th January 1994

ISSUED 25th November 1993

Signed

*E.C. Bellingham*

DISTRICT SECRETARY

Monkton Park,  
Chippenham, SN15 1ER.

/ SCHEDULE 1 . . . . .

(over)

**SCHEDULE 1 - LAND OR PREMISES TO WHICH THIS NOTICE RELATES**

Land at Upper Dauntsey Lodge Farm, Sodom Lane, Dauntsey near Chippenham, Wiltshire, shown stippled on the attached plan

**SCHEDULE 2 - ALLEGED BREACH OF PLANNING CONTROL**

The making of a material change in the use of part of the land, that is the building shown stippled on the attached plan, from agricultural use to residential use.

**SCHEDULE 3 - STEPS REQUIRED TO BE TAKEN**

To cease the residential use of the building referred to in Schedule 2 above.

**REASONS FOR ISSUE**

This development is contrary to policy H19 of the North East Wiltshire Structure Plan and policy H10 of the adopted North Wiltshire Local Plan which directs new residential development to existing settlements unless essential for the needs of agriculture. Although an agricultural case has been put forward it is not considered sufficient to overcome the strong policy considerations against new dwellings in the countryside.



E 731

ST 9989 8150

997 Downway

998

999

NORTH WILTSHIRE DISTRICT COUNCIL

TOWN AND COUNTRY PLANNING ACT 1990

ENFORCEMENT

NOTICE

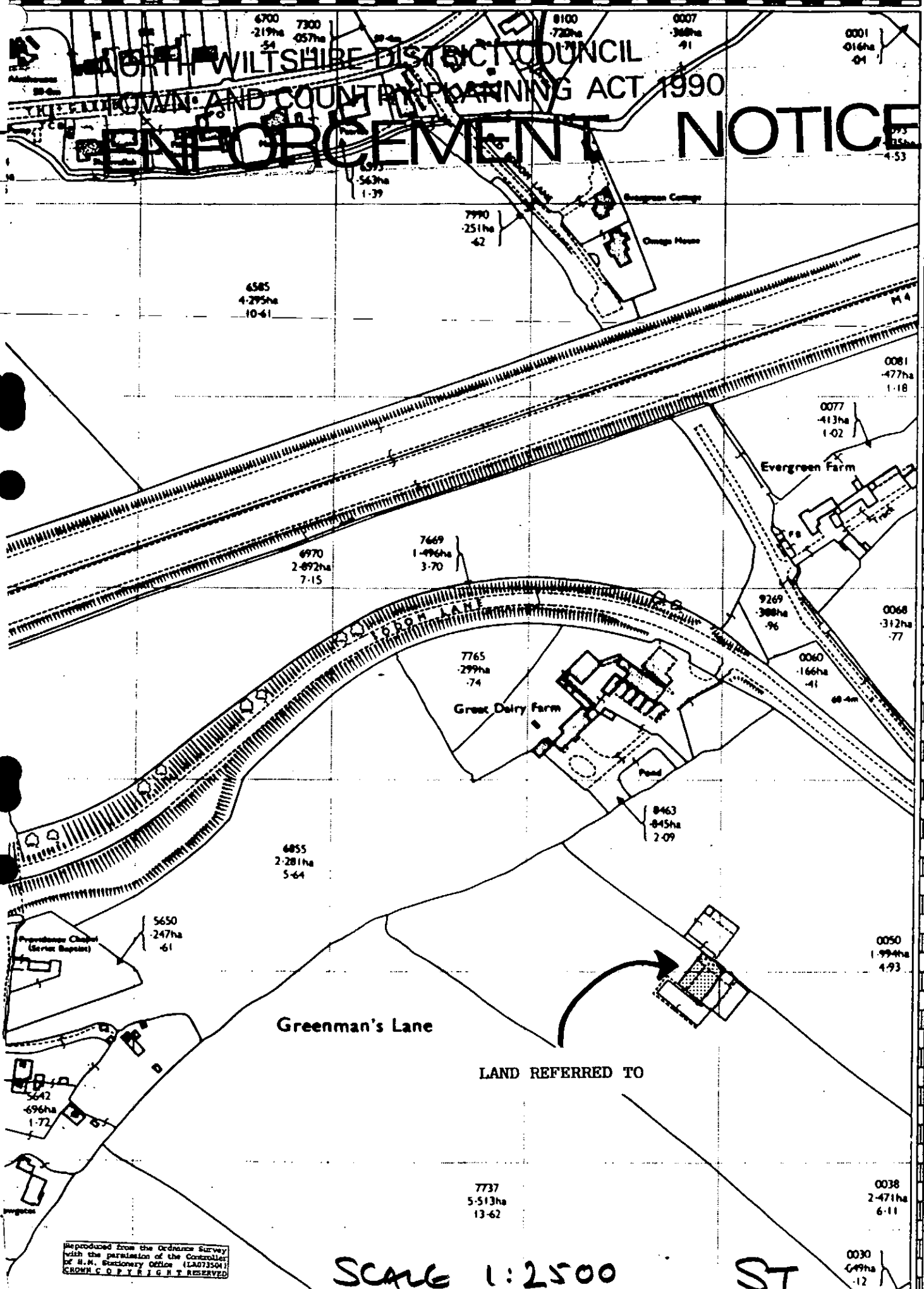

# IMPORTANT -

THIS COMMUNICATION AFFECTS  
YOUR PROPERTY.

District Secretary's Department,  
G.C. Betteridge, LL.B. (Solicitor), District Secretary

DX 34208 Fax (0249) 443152

tel: CHIPPENHAM (0249) 443322 ext: 598 Miss R. Hind

**E** 731

*North  
Wiltshire*

NORTH WILTSHIRE DISTRICT COUNCIL  
Monkton Park, CHIPPENHAM, SN15 1EF

Dear Sir/Madam,

8th February 1994

NORTH WILTSHIRE DISTRICT COUNCIL

TOWN AND COUNTRY PLANNING ACT 1990

## ENFORCEMENT NOTICE

Land at Upper Dauntsey Lodge Farm, Sodom Lane, Dauntsey, Wiltshire

The Council have issued an Enforcement Notice relating to the above land and I now serve on you a copy of that Notice, in view of your interest in the land. Unless an appeal is made to the Secretary of State as described below, the Notice will take effect on the date shown in the box below and you must then ensure that the required steps for which you may be held responsible are taken within the period or periods specified in the Notice.

If you wish to appeal against the Notice, you should first read carefully the enclosed booklet entitled "Enforcement Notice Appeals - A Guide to Procedure". Then, you or your agent should complete the enclosed appeal form and send it, together with the extra copy of the Enforcement Notice enclosed herewith to the address on the appeal form. Your appeal MUST BE RECEIVED by the Department of the Environment BEFORE THE NOTICE TAKES EFFECT.

There is a requirement on the Council to specify the reasons why the local planning authority consider it expedient to issue the Notice and these reasons are set out in the Notice.

Yours faithfully,

*G.C. Betteridge*

District Secretary

DATE ON WHICH NOTICE TAKES EFFECT  
AND BEFORE WHICH ANY APPEAL  
MUST BE RECEIVED

22nd March 1994

To: Mr. W. D. Matthews  
Upper Dauntsey Lodge  
Dauntsey  
Nr. Chippenham  
SN16 9 AZ

Mrs. K. M. Matthews  
Upper Dauntsey Lodge  
Dauntsey  
Nr. Chippenham  
SN16 9 AZ

NORTH WILTSHIRE DISTRICT COUNCIL  
TOWN AND COUNTRY PLANNING ACT 1990  
**ENFORCEMENT NOTICE**

Land at Upper Dauntsey Lodge Farm, Sodom Lane,

Dauntsey, Nr Chippenham, Wiltshire

WHEREAS :

- (1) It appears to the North Wiltshire District Council ("the Council") being the local planning authority for the purposes of Section 172 of the Town and Country Planning Act 1990 ("the Act") in this matter, that there has been a breach of planning control within the period of four years before the date of issue of this Notice on the land or premises ("the land") described in Schedule 1 below;
- (2) The breach of planning control which appears to have taken place consists in the carrying out of development by the making of the material change in the use of the land described in Schedule 2 below, without the grant of planning permission required for that development.
- (3) The Council consider it expedient, having regard to the provisions of the development plan and to all other material considerations, to issue this enforcement notice, in exercise of their powers contained in the said Section 172, for the reasons set out below.

NOTICE IS HEREBY GIVEN that the Council require that the steps specified in Schedule 3 below be taken in order to remedy the breach within the period of SIX MONTHS from the date on which this Notice takes effect.

THIS NOTICE SHALL TAKE EFFECT, subject to the provisions of Section 175(4) of the Act, on 18th March 1994

ISSUED 8th February 1994

Signed G.C. Bellard

Monkton Park,  
Chippenham, SN15 1ER

**SCHEDULE 1 - LAND OR PREMISES TO WHICH THIS NOTICE RELATES**

Land at Upper Dauntsey Lodge Farm, Sodom Lane, Dauntsey near Chippenham, Wiltshire, shown stippled on the attached plan

**SCHEDULE 2 - ALLEGED BREACH OF PLANNING CONTROL**

The making of a material change in the use of part of the land, that is the building shown stippled on the attached plan, from agricultural use to residential use.

**SCHEDULE 3 - STEPS REQUIRED TO BE TAKEN**

To cease the residential use of the building referred to in Schedule 2 above.

**REASONS FOR ISSUE**

This development is contrary to policy H19 of the North East Wiltshire Structure Plan and policy H10 of the adopted North Wiltshire Local Plan which directs new residential development to existing settlements unless essential for the needs of agriculture. Although an agricultural case has been put forward it is not considered sufficient to overcome the strong policy considerations against new dwellings in the countryside.

ST