

posted 4-11-92

ENFORCEMENT REGISTER INFORMATION SHEET

E/ 693		
APPEAL	yes	no
Plan's Ref		

ADDRESS

WHITTHAM GARDEN CENTRAL

BREACH of CONTROL

SSN ATTACHED NOTICE

Issuing Authority NWDC

Date Issued 1.10.92

STOP NOTICES

Date Served

Requiring



Date(s) served

1.10.92

Takes effect 12.11.92

Compliance by 12.12.92

Dates Extended by Secretary of State

Date withdrawn

REQUIREMENTS of ENFORCEMENT

SSN ATTACHED NOTICE.

EXTENT to WHICH NOTICE COMPLIED WITH (dates)

IMPORTANT -

THIS COMMUNICATION AFFECTS
YOUR PROPERTY

District Secretary's Department,
G.C. Beteridge, LL.B. (Solicitor), District Secretary

*North
Wiltshire*

DX 34208 Fax (0249) 443152

E 693

tel: CHIPPENHAM (0249) 443322 ext: 593 Mr. R. J. Packer

NORTH WILTSHIRE DISTRICT COUNCIL
Monkton Park, CHIPPENHAM, SN15 1ER

1st October 1992

Dear Sir/Madam,

NORTH WILTSHIRE DISTRICT COUNCIL
TOWN AND COUNTRY PLANNING ACT 1990

● ENFORCEMENT NOTICE

Land adjoining Whitehall Garden Centre, Corsham Road, Lacock, Wiltshire

The Council have issued an Enforcement Notice relating to the above land and I now serve on you a copy of that Notice, in view of your interest in the land. Unless an appeal is made to the Secretary of State as described below, the Notice will take effect on the date shown in the box below and you must then ensure that the required steps for which you may be held responsible are taken within the period or periods specified in the Notice.

If you wish to appeal against the Notice, you should first read carefully the enclosed booklet entitled "Enforcement Notice Appeals - A Guide to Procedure". Then, you or your agent should complete the enclosed appeal form and send it, together with the extra copy of the Enforcement Notice enclosed herewith to the address on the appeal form. Your appeal **MUST BE RECEIVED** by the Department of the Environment **BEFORE THE NOTICE TAKES EFFECT**.

● There is a requirement on the Council to specify the reasons why the local planning authority consider it expedient to issue the Notice and these reasons are set out in the Notice.

Yours faithfully,

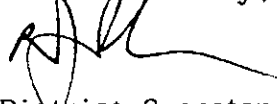
for District Secretary

DATE ON WHICH NOTICE TAKES EFFECT
AND BEFORE WHICH ANY APPEAL
MUST BE RECEIVED 12th November 1992

To: Mr. R. C. Self
Laundry Cottage
Bowden Hill
Lacock
Chippenham
Wiltshire SN15 2PP

The Company Secretary
Whitehall Garden Centre Ltd.
Corsham Road
Lacock
Chippenham
Wiltshire SN15 2LZ

NORTH WILTSHIRE DISTRICT COUNCIL TOWN AND COUNTRY PLANNING ACT 1990 ENFORCEMENT NOTICE

Land adjoining Whitehall Garden Centre, Corsham Road, Lacock, Wiltshire

WHEREAS :

- (1) It appears to the North Wiltshire District Council ("the Council") being the local planning authority for the purposes of Section 172 of the Town and Country Planning Act 1990 ("the Act") in this matter, that there has been a breach of planning control within the last ten years on the land or premises ("the land") described in Schedule 1 below.
- (2) The breach of planning control which appears to have taken place consists in the failure to comply with a limitation subject to which planning permission has been granted, that permission and the relevant condition being more fully described in Schedule 2 below.
- (3) The Council consider it expedient, having regard to the provisions of the development plan and to all other material considerations, to issue this enforcement notice, in exercise of their powers contained in the said Section 172, for the reasons set out below.

NOTICE IS HEREBY GIVEN that the Council require that the steps specified in Schedule 3 below be taken in order to remedy the breach within the period of ONE MONTH from the date on which this Notice takes effect:

THIS NOTICE SHALL TAKE EFFECT, subject to the provisions of Section 175(4) of the Act, on 12th November 1992

ISSUED 1st October 1992

Signed

G.C. Betteridge

DISTRICT SECRETARY

Monkton Park,
Chippenham SN15 1ER

/SCHEDULE 1.
(over)

SCHEDULE 1 - LAND OR PREMISES TO WHICH THIS NOTICE RELATES

Land adjoining Whitehall Garden Centre, Corsham Road, Lacock, shown stipple-edged on the attached plan

SCHEDULE 2 - ALLEGED BREACH OF PLANNING CONTROL

Failure to comply with the limitation imposed by Class B of Part 4 in Schedule 2 to the Town and Country Planning General Development Order 1988 on the permission granted by Article 3 of the said Order in that the use of the said land for car parking in association with the adjoining Garden Centre has taken place on more than 28 days in the current calendar year

SCHEDULE 3 - STEPS REQUIRED TO BE TAKEN

1. To cease the use of the said land for car parking in association with the adjoining Garden Centre for the remainder of the current calendar year
2. To refrain from using the said land for car parking in association with the adjoining Garden Centre for a period in excess of 28 days in any subsequent calendar year

STATEMENT OF REASONS WHY THE LOCAL PLANNING AUTHORITY CONSIDER IT EXPEDIENT TO
ISSUE THIS NOTICE

The use of the said land for car parking is considered to have a detrimental effect on the rural character of the area, to be visually intrusive, and to cause noise and general disturbance in the immediate vicinity of the gardens of neighbouring residents.

E 693

NORTH WILTSHIRE DISTRICT COUNCIL
TOWN AND COUNTRY PLANNING ACT 1990

ENFORCEMENT NOTICE

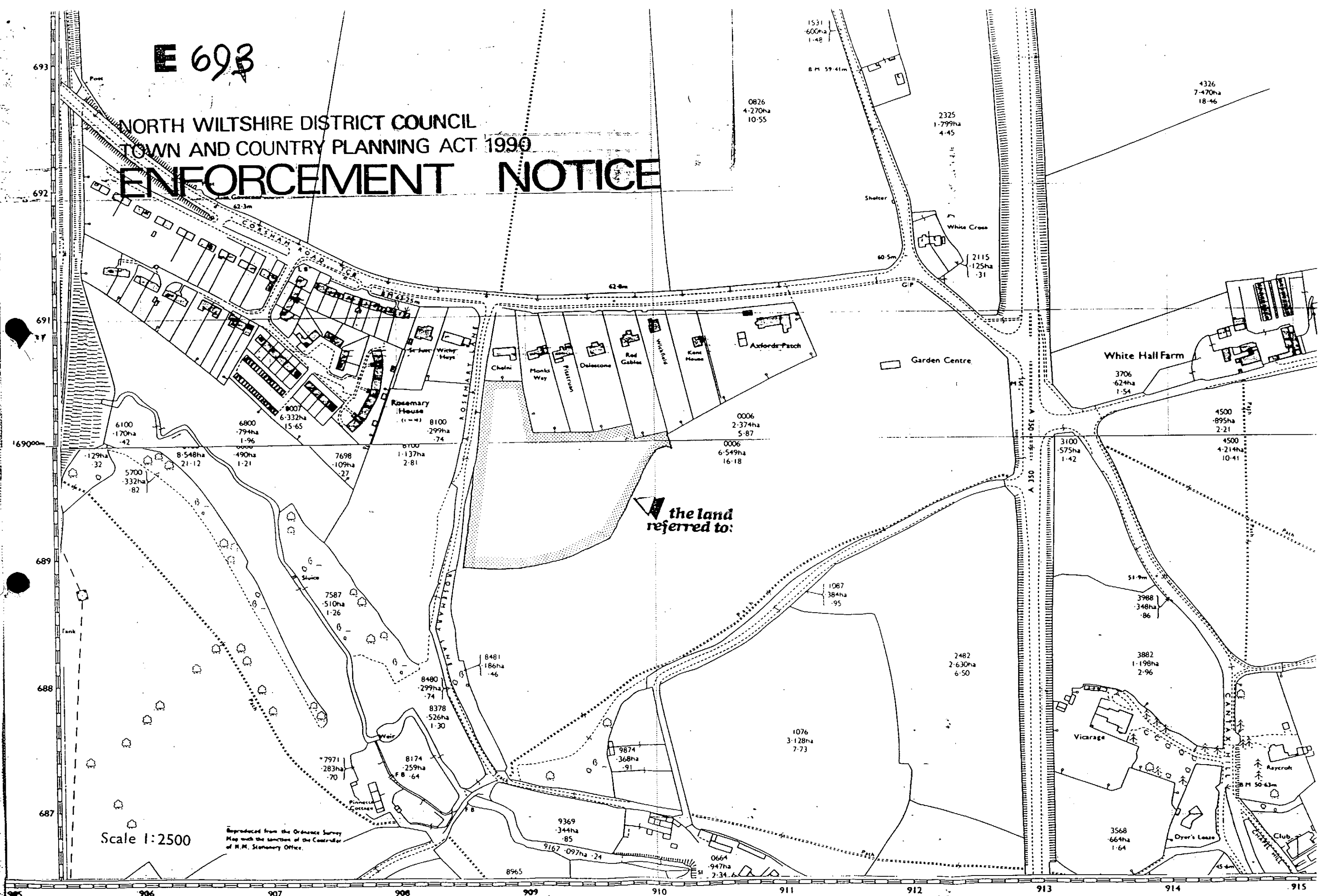

IMPORTANT -

**THIS COMMUNICATION AFFECTS
YOUR PROPERTY**

District Secretary's Department,
G.C. Betteridge, LL.B. (Solicitor), District Secretary

DX 34208 Fax (0249) 443152

E 693

tel: CHIPPENHAM (0249) 443322 ext: 593 Mr. R. J. Packer

693
*North
Wiltshire*

NORTH WILTSHIRE DISTRICT COUNCIL
Monkton Park, CHIPPENHAM, SN15 1ER

1st October 1992

Dear Sir/Madam,

**NORTH WILTSHIRE DISTRICT COUNCIL
TOWN AND COUNTRY PLANNING ACT 1990
ENFORCEMENT NOTICE**

Land adjoining Whitehall Garden Centre, Corsham Road, Lacock, Wiltshire

The Council have issued an Enforcement Notice relating to the above land and I now serve on you a copy of that Notice, in view of your interest in the land. Unless an appeal is made to the Secretary of State as described below, the Notice will take effect on the date shown in the box below and you must then ensure that the required steps for which you may be held responsible are taken within the period or periods specified in the Notice.

If you wish to appeal against the Notice, you should first read carefully the enclosed booklet entitled "Enforcement Notice Appeals - A Guide to Procedure". Then, you or your agent should complete the enclosed appeal form and send it, together with the extra copy of the Enforcement Notice enclosed herewith to the address on the appeal form. Your appeal **MUST BE RECEIVED** by the Department of the Environment **BEFORE THE NOTICE TAKES EFFECT**.

There is a requirement on the Council to specify the reasons why the local planning authority consider it expedient to issue the Notice and these reasons are set out in the Notice.

Yours faithfully,

for District Secretary

DATE ON WHICH NOTICE TAKES EFFECT
AND BEFORE WHICH ANY APPEAL
MUST BE RECEIVED 12th November 1992

To: Mr. R. C. Self
Laundry Cottage
Bowden Hill
Lacock
Chippenham
Wiltshire SN15 2PP

The Company Secretary
Whitehall Garden Centre Ltd.
Corsham Road
Lacock
Chippenham
Wiltshire SN15 2LZ

NORTH WILTSHIRE DISTRICT COUNCIL
TOWN AND COUNTRY PLANNING ACT 1990
ENFORCEMENT NOTICE

Land adjoining Whitehall Garden Centre, Corsham Road, Lacock, Wiltshire

WHEREAS :

- (1) It appears to the North Wiltshire District Council ("the Council") being the local planning authority for the purposes of Section 172 of the Town and Country Planning Act 1990 ("the Act") in this matter, that there has been a breach of planning control within the last ten years on the land or premises ("the land") described in Schedule 1 below.
- (2) The breach of planning control which appears to have taken place consists in the failure to comply with a limitation subject to which planning permission has been granted, that permission and the relevant condition being more fully described in Schedule 2 below.
- (3) The Council consider it expedient, having regard to the provisions of the development plan and to all other material considerations, to issue this enforcement notice, in exercise of their powers contained in the said Section 172, for the reasons set out below.

NOTICE IS HEREBY GIVEN that the Council require that the steps specified in Schedule 3 below be taken in order to remedy the breach within the period of ONE MONTH from the date on which this Notice takes effect.

THIS NOTICE SHALL TAKE EFFECT, subject to the provisions of Section 175(4) of the Act, on 12th November 1992

ISSUED 1st October 1992

Signed G.C. Betteridge
DISTRICT SECRETARY

Monkton Park,
Chippenham SN15 1ER

SCHEDULE 1 - LAND OR PREMISES TO WHICH THIS NOTICE RELATES

Land adjoining Whitehall Garden Centre, Corsham Road, Lacock, shown stipple-edged on the attached plan

SCHEDULE 2 - ALLEGED BREACH OF PLANNING CONTROL

Failure to comply with the limitation imposed by Class B of Part 4 in Schedule 2 to the Town and Country Planning General Development Order 1988 on the permission granted by Article 3 of the said Order in that the use of the said land for car parking in association with the adjoining Garden Centre has taken place on more than 28 days in the current calendar year

SCHEDULE 3 - STEPS REQUIRED TO BE TAKEN

1. To cease the use of the said land for car parking in association with the adjoining Garden Centre for the remainder of the current calendar year
2. To refrain from using the said land for car parking in association with the adjoining Garden Centre for a period in excess of 28 days in any subsequent calendar year

STATEMENT OF REASONS WHY THE LOCAL PLANNING AUTHORITY CONSIDER IT EXPEDIENT TO
ISSUE THIS NOTICE

The use of the said land for car parking is considered to have a detrimental effect on the rural character of the area, to be visually intrusive, and to cause noise and general disturbance in the immediate vicinity of the gardens of neighbouring residents.

E 693

**NORTH WILTSHIRE DISTRICT COUNCIL
TOWN AND COUNTRY PLANNING ACT 1990**

ENFORCEMENT NOTICE

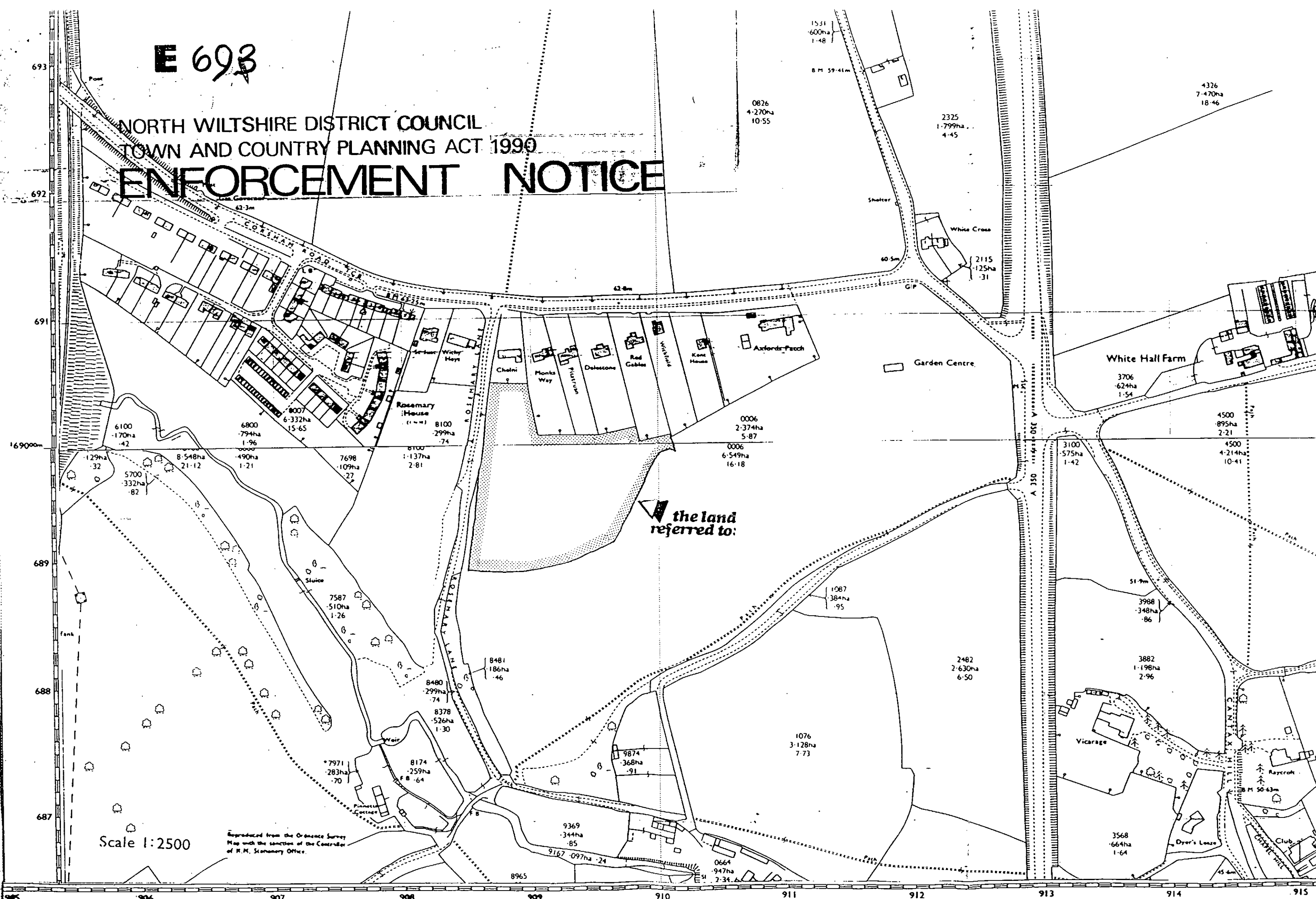

Scale 1:2500

Reproduced from the Ordnance Survey
Map with the sanction of the Controller
of H.M. Stationery Office.

CHIPPENHAM CO CONST

CT9047-9147

IMPORTANT -

**THIS COMMUNICATION AFFECTS
YOUR PROPERTY**

District Secretary's Department,
G.C. Betteridge, LL.B. (Solicitor), District Secretary

DX 34208 Fax (0249) 443152

E 693

tel: CHIPPENHAM (0249) 443322 ext: 593 Mr. R. J. Packer

M. Scott
North Wiltshire
NORTH WILTSHIRE DISTRICT COUNCIL
Monkton Park, CHIPPENHAM, SN15 1ER

1st October 1992

Dear Sir/Madam,

**NORTH WILTSHIRE DISTRICT COUNCIL
TOWN AND COUNTRY PLANNING ACT 1990**

ENFORCEMENT NOTICE

Land adjoining Whitehall Garden Centre, Corsham Road, Lacock, Wiltshire

The Council have issued an Enforcement Notice relating to the above land and I now serve on you a copy of that Notice, in view of your interest in the land. Unless an appeal is made to the Secretary of State as described below, the Notice will take effect on the date shown in the box below and you must then ensure that the required steps for which you may be held responsible are taken within the period or periods specified in the Notice.

If you wish to appeal against the Notice, you should first read carefully the enclosed booklet entitled "Enforcement Notice Appeals - A Guide to Procedure". Then, you or your agent should complete the enclosed appeal form and send it, together with the extra copy of the Enforcement Notice enclosed herewith to the address on the appeal form. Your appeal **MUST BE RECEIVED** by the Department of the Environment **BEFORE THE NOTICE TAKES EFFECT**.

There is a requirement on the Council to specify the reasons why the local planning authority consider it expedient to issue the Notice and these reasons are set out in the Notice.

Yours faithfully,

for District Secretary

**DATE ON WHICH NOTICE TAKES EFFECT
AND BEFORE WHICH ANY APPEAL
MUST BE RECEIVED** 12th November 1992

To: Mr. R. C. Self
Laundry Cottage
Bowden Hill
Lacock
Chippenham
Wiltshire SN15 2PP

The Company Secretary
Whitehall Garden Centre Ltd.
Corsham Road
Lacock
Chippenham
Wiltshire SN15 2LZ

NORTH WILTSHIRE DISTRICT COUNCIL TOWN AND COUNTRY PLANNING ACT 1990 ENFORCEMENT NOTICE

Land adjoining Whitehall Garden Centre, Corsham Road, Lacock, Wiltshire

WHEREAS :

- (1) It appears to the North Wiltshire District Council ("the Council") being the local planning authority for the purposes of Section 172 of the Town and Country Planning Act 1990 ("the Act") in this matter, that there has been a breach of planning control within the last ten years on the land or premises ("the land") described in Schedule 1 below.
- (2) The breach of planning control which appears to have taken place consists in the failure to comply with a limitation subject to which planning permission has been granted, that permission and the relevant condition being more fully described in Schedule 2 below.
- (3) The Council consider it expedient, having regard to the provisions of the development plan and to all other material considerations, to issue this enforcement notice, in exercise of their powers contained in the said Section 172, for the reasons set out below.

NOTICE IS HEREBY GIVEN that the Council require that the steps specified in Schedule 3 below be taken in order to remedy the breach within the period of ONE MONTH from the date on which this Notice takes effect.

THIS NOTICE SHALL TAKE EFFECT, subject to the provisions of Section 175(4) of the Act, on 12th November 1992

ISSUED 1st October 1992

Signed G.C. Betteridge
DISTRICT SECRETARY

Monkton Park,
Chippenham SN15 1ER

SCHEDULE 1 - LAND OR PREMISES TO WHICH THIS NOTICE RELATES

Land adjoining Whitehall Garden Centre, Corsham Road, Lacock, shown stipple-edged on the attached plan

SCHEDULE 2 - ALLEGED BREACH OF PLANNING CONTROL

Failure to comply with the limitation imposed by Class B of Part 4 in Schedule 2 to the Town and Country Planning General Development Order 1988 on the permission granted by Article 3 of the said Order in that the use of the said land for car parking in association with the adjoining Garden Centre has taken place on more than 28 days in the current calendar year

SCHEDULE 3 - STEPS REQUIRED TO BE TAKEN

1. To cease the use of the said land for car parking in association with the adjoining Garden Centre for the remainder of the current calendar year
2. To refrain from using the said land for car parking in association with the adjoining Garden Centre for a period in excess of 28 days in any subsequent calendar year

STATEMENT OF REASONS WHY THE LOCAL PLANNING AUTHORITY CONSIDER IT EXPEDIENT TO
ISSUE THIS NOTICE

The use of the said land for car parking is considered to have a detrimental effect on the rural character of the area, to be visually intrusive, and to cause noise and general disturbance in the immediate vicinity of the gardens of neighbouring residents.

