

**ENFORCEMENT
INFORMATION****REGISTER
SHEET****E/ 65.**

APPEAL

yes

no

Plan's Ref

ADDRESS

LITTLEWORTH

BUSHTON

SWINDON

BREACH of CONTROL

THE FAILURE TO COMPLY WITH A CONDITION
SUBJECT TO WHICH PLANNING PERMISSION
(ON APPN. REF APP/5408/A/78/7388.9)
WAS GRANTED ON 3.11.88. TO WIT:
CONDITION 3 SCRAP METAL SHALL NOT
BE STACKED OR DISPOSED TO A
HEIGHT EXCEEDING SIX FEET.

Issuing Authority N.W.D.C.

Date Issued 2.3.84.

STOP NOTICES

Date Served

Requiring

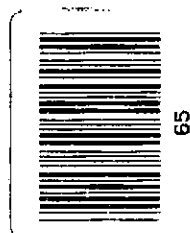

Date(s) served

5.3.84.

Takes effect 16.4.84

Compliance by 16.6.84

Dates Extended by
Secretary of State

Date withdrawn

REQUIREMENTS of ENFORCEMENT

TO REDUCE THE HEIGHT OF VEHICLE BODIES AND
OTHER SCRAP MATERIAL ON THE LAND TO SIX FEET.

EXTENT to WHICH NOTICE COMPLIED WITH (dates)

IMPORTANT

THIS COMMUNICATION AFFECTS
YOUR PROPERTY

District Secretary's Department
D. F. Lewis
Solicitor to the Council



**North Wiltshire
District Council**

Monkton Park,
Chippenham,
Wiltshire, SN15 1ER.
Tel. Chippenham (0249) 654188.
Ext. 132

Our ref **E** 65 Enquiries to Mr. McDonald

Dear Sir/Madam,

2nd March, 1984

NORTH WILTSHIRE DISTRICT COUNCIL TOWN AND COUNTRY PLANNING ACT 1971 (as amended) **ENFORCEMENT NOTICE**

Littleworth, Bushton, Swindon, Wiltshire

The Council have issued an Enforcement Notice relating to the above land and I now serve on you a copy of that Notice, in view of your interest in the land.

Unless an appeal is made to the Secretary of State, as described below, the Notice will take effect on the date shown in the box below and you must then ensure that the required steps for which you may be held responsible are taken within the period or periods specified in the Notice.

If you wish to appeal against the Notice, you should first read carefully the enclosed booklet entitled "Enforcement Notice Appeals - A Guide to Procedure". Then, you or your agent should complete the enclosed appeal form and send it, together with the extra copy of the Enforcement Notice enclosed herewith and the fee specified in the box below, to the address on the appeal form. Your appeal must be received by the Department of the Environment BEFORE the Notice takes effect.

There is a requirement on the Council to specify the reasons why the local planning authority consider it expedient to issue the Notice and these reasons are set out in the ANNEX overleaf.

Yours faithfully,

Solicitor

DATE ON WHICH NOTICE TAKES EFFECT and
BEFORE WHICH ANY APPEAL MUST BE
RECEIVED - 16th April, 1984

FEE WHICH MUST ACCOMPANY
APPEAL - NIL

To:

Mr. Henry Howard,
Manor Farm,
Marston,
Devizes,
Wiltshire.

ANNEX - (This does not form part of the Enforcement Notice).

The conspicuous storage of scrap material stacked to a height in excess of six feet in this open countryside location seriously damages rural visual amenity.

NORTH WILTSHIRE DISTRICT COUNCIL
TOWN AND COUNTRY PLANNING ACT 1971 (as amended)
ENFORCEMENT NOTICE

Littledown, Bushton, Swindon, Wiltshire

WHEREAS :

- (1) It appears to the North Wiltshire District Council ("the Council") being the local planning authority for the purposes of Section 87 of the Town and Country Planning Act 1971 ("the Act") in this matter, that there has been a breach of planning control within the period of four years before the date of issue of this Notice on the land or premises ("the land") described in Schedule 1 below.
- (2) The breach of planning control which appears to have taken place consists in the failure to comply with conditions or limitations subject to which planning permission was granted, that permission and the relevant condition being more fully described in Schedule 2 below.
- (3) The Council consider it expedient, having regard to the provisions of the development plan and to all other material considerations, to issue this enforcement notice, in exercise of their powers contained in the said Section 87, for the reasons set out in the ANNEX to this Notice.

NOTICE IS HEREBY GIVEN that the Council require that the steps specified in Schedule 3 below be taken in order to remedy the breach within the period of two months from the date on which this Notice takes effect.

THIS NOTICE SHALL TAKE EFFECT, subject to the provisions of Section 88(10) of the Act, on 16th April, 1984

ISSUED 2nd March, 1984

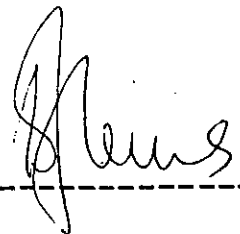
Signed 

Monkton Park,
Chippenham SN15 1ER

/SCHEDULE 1:

SCHEDULE 1 - Land or premises to which this Notice relates

The scrap yard at part O.S. parcel 0681 and part O.S. parcel 9875, Bushton in the parish of Clyffe Pypard, Wiltshire shown edged red on the attached plan.

SCHEDULE 2 - Alleged breach of planning control

The failure to comply with a condition subject to which planning permission (on appeal - ref: APP/5408/A/78/7388,9) was granted on 3rd November 1978, to wit :

"Condition 3. scrap material shall not be stacked or deposited to a height exceeding 6 ft."

SCHEDULE 3. - Steps required to be taken.

To reduce the height of vehicle bodies and other scrap material on the land to six feet.

E 65

SU

BROAD TOWN C P

NORTH WILTSHIRE DISTRICT COUNCIL
TOWN AND COUNTRY PLANNING ACT 1971 (as amended)

ENFORCEMENT NOTICE

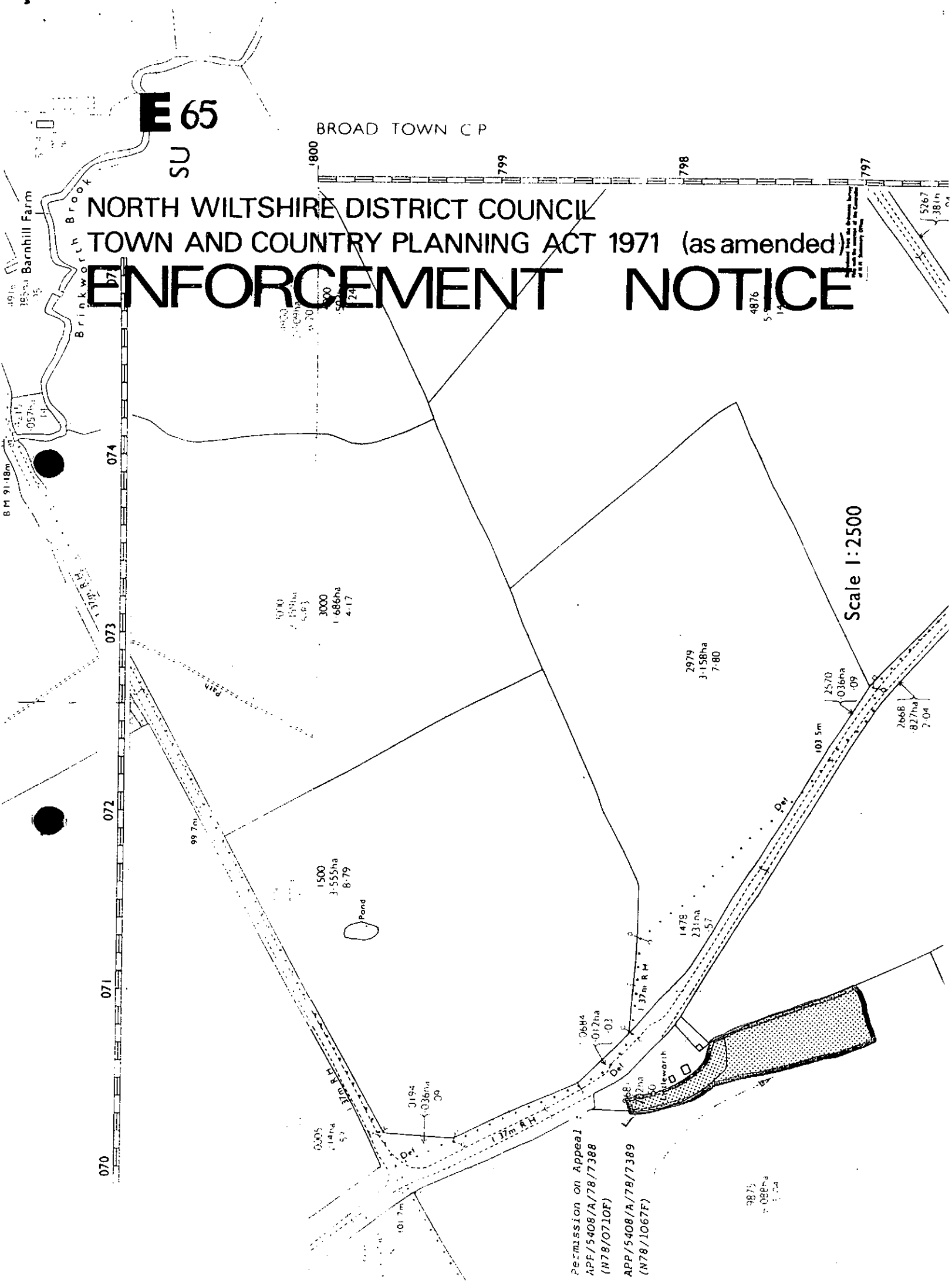

Permission on Appeal :
APP/5408/A/78/7388
(N78/0710F)

APP/5408/A/78/7389
(N78/1067F)

Plotted.
10-8-92.

ENFORCEMENT REGISTER INFORMATION SHEET

E/ 65/92		
APPEAL	yes	no
Plan's Ref		

ADDRESS

LAND AT:
LITTLA WORTH,
BUSHTON

BREACH of CONTROL

AS PER ATTACHED
NOTICE.

Issuing Authority NWDC

Date Issued 24.7.92

STOP NOTICES

Date Served

Requiring

Date(s) served

24.7.92

Takes effect 9.9.92

Compliance by 9.12.92

Dates Extended by
Secretary of State

Date withdrawn

REQUIREMENTS of ENFORCEMENT

AS PER ATTACHED NOTICE.

EXTENT to WHICH NOTICE COMPLIED WITH (dates)

IMPORTANT -

THIS COMMUNICATION AFFECTS
YOUR PROPERTY

District Secretary's Department,
G.C. Betteridge, LL.B. (Solicitor), District Secretary

*North
Wiltshire*

DX 34208 Fax (0249) 443152

E 65/92

tel: CHIPPENHAM (0249) 443322 ext: 598 Rachel Hind

NORTH WILTSHIRE DISTRICT COUNCIL
Monkton Park, CHIPPENHAM, SN15 1ER

Dear Sir/Madam,

24th July 1992

NORTH WILTSHIRE DISTRICT COUNCIL
TOWN AND COUNTRY PLANNING ACT 1990

ENFORCEMENT NOTICE

Land at Littleworth, Bushton, Wiltshire

The Council have issued an Enforcement Notice relating to the above land and I now serve on you a copy of that Notice, in view of your interest in the land. Unless an appeal is made to the Secretary of State as described below, the Notice will take effect on the date shown in the box below and you must then ensure that the required steps for which you may be held responsible are taken within the period or periods specified in the Notice.

If you wish to appeal against the Notice, you should first read carefully the enclosed booklet entitled "Enforcement Notice Appeals - A Guide to Procedure". Then, you or your agent should complete the enclosed appeal form and send it, together with the extra copy of the Enforcement Notice enclosed herewith to the address on the appeal form. Your appeal **MUST BE RECEIVED** by the Department of the Environment **BEFORE THE NOTICE TAKES EFFECT**.

There is a requirement on the Council to specify the reasons why the local planning authority consider it expedient to issue the Notice and these reasons are set out in the Notice.

Yours faithfully,



for District Secretary

DATE ON WHICH NOTICE TAKES EFFECT
AND BEFORE WHICH ANY APPEAL

MUST BE RECEIVED 9th September 1992

To:	Mr. Henry Howard	Mr. Colin Howard
	Manor Farm	Manor Farm
	Marston	Marston
	Devizes	Devizes

NORTH WILTSHIRE DISTRICT COUNCIL
TOWN AND COUNTRY PLANNING ACT 1990
ENFORCEMENT NOTICE

Land at Littleworth, Bushton, Wiltshire

WHEREAS :

- (1) It appears to the North Wiltshire District Council ("the Council") being the local planning authority for the purposes of Section 172 of the Town and Country Planning Act 1990 ("the Act") in this matter, that there has been a breach of planning control after the end of 1963 on the land or premises ("the land") described in Schedule 1 below.
- (2) The breach of planning control which appears to have taken place consists in the carrying out of development by the making of the material change in the use of the land described in Schedule 2 below, without the grant of planning permission required for that development.
- (3) The Council consider it expedient, having regard to the provisions of the development plan and to all other material considerations, to issue this enforcement notice, in exercise of their powers contained in the said Section 172, for the reasons set out below.

NOTICE IS HEREBY GIVEN that the Council require that the steps specified in Schedule 3 below be taken in order to remedy the breach within the period of THREE MONTHS from the date on which this Notice takes effect.

THIS NOTICE SHALL TAKE EFFECT, subject to the provisions of Section 175(4) of the Act, on 9th September 1992

ISSUED 24th July 1992

Signed

G. C. Betteridge

DISTRICT SECRETARY

Monkton Park,
Chippenham, SN15 1ER.

/ SCHEDULE 1

(over)

SCHEDULE 1 - LAND OR PREMISES TO WHICH THIS NOTICE RELATES

Land situated on the south western side of the C15 Wootton Bassett to Bushton road at part of O.S. parcel 9875 and part of O.S. parcel 681 "Littleworth" Bushton in the parish of Clyffe Pypard shown stipple-edged on the attached Plan A (hereinafter referred to as "the land")

SCHEDULE 2 - ALLEGED BREACH OF PLANNING CONTROL

The making of a material change in the use of the land from agricultural use to a continued use for that purpose and in addition use for the storage and dismantling of vehicles in connection with use of the adjacent site cross-hatched on the attached plan B at part of O.S. parcel 9875 and a vehicle dismantlers' site and scrapyard and of the adjacent site at part of O.S. parcel 681 as a vehicle dismantlers' site and retail scrap-yard for which planning permission was granted (on appeal - ref. APP/5408/A178/7388 and 9) on 3rd November 1978.

SCHEDULE 3 - STEPS REQUIRED TO BE TAKEN

- (1) To discontinue the use of the land for the storage and dismantling of vehicles
- (2) To remove or secure the removal of the said vehicles or parts of vehicles from the land
- (3) To restore or secure the restoration of the land to a condition suitable for the purposes of agriculture

STATEMENT OF REASONS WHY THE LOCAL AUTHORITY CONSIDER IT EXPEDIENT TO ISSUE THIS NOTICE

The site is situated within an attractive rural landscape where it is Central Government Policy and the Planning Authority's Policy to restrict new development (including the change of use of land) to that required in connection with agriculture or forestry or other uses appropriate to the rural area.

It is considered the unauthorised expansion of this site is unacceptable and the use is unsuitable, inappropriate and visually intrusive in this rural area and should be carried out in a suitable location within or attached to an existing urban area or on land specifically authorised or allocated for such a commercial use.

E 65/92

NORTH WILTSHIRE DISTRICT COUNCIL
TOWN AND COUNTRY PLANNING ACT 1990

ENFORCEMENT NOTICE

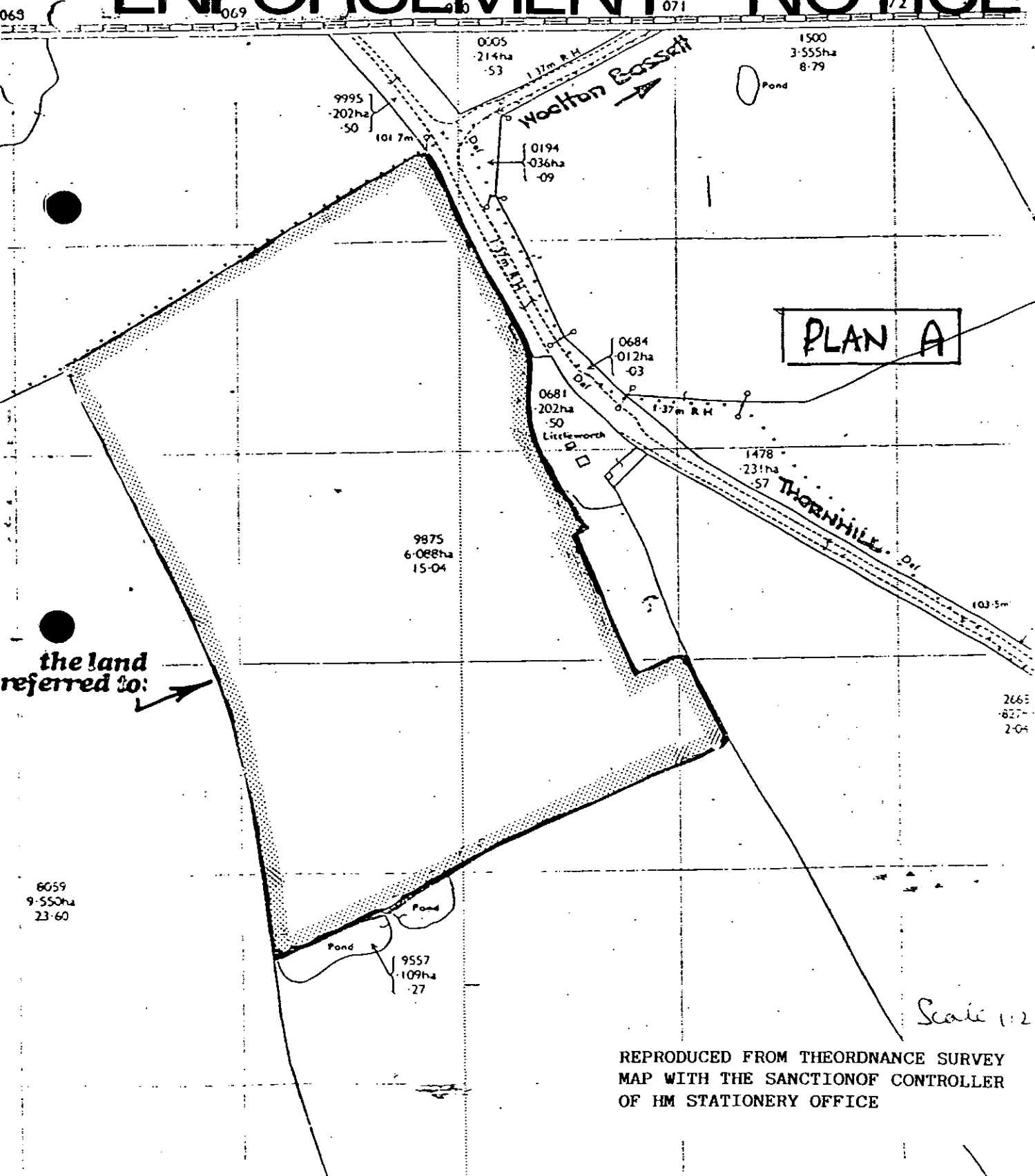

E 65/92

BROAD TOWN C P

NORTH WILTSHIRE DISTRICT COUNCIL
TOWN AND COUNTRY PLANNING ACT 1990

ENFORCEMENT NOTICE

PLAN B

Scale 1:2500

the land
referred to:

Permission on Appeal:
APP/5408/A/78/7388
(N78/0710F)
APP/5408/A/78/7389
(N78/1067F)

REPRODUCED FROM THE ORDNANCE SURVEY OF
MAP WITH THE SANCTION OF CONTROLLER OF

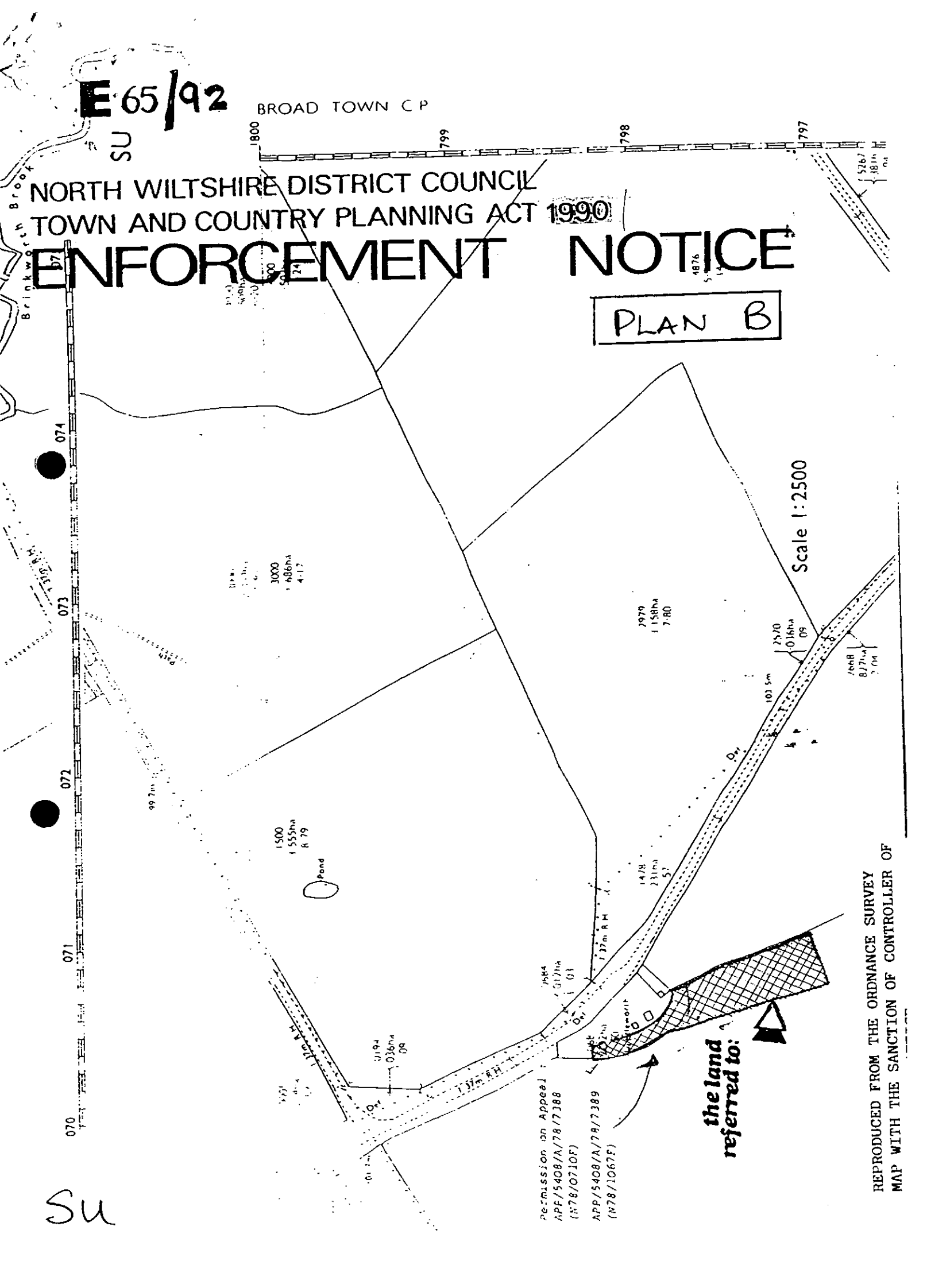

IMPORTANT -

**THIS COMMUNICATION AFFECTS
YOUR PROPERTY**

District Secretary's Department,
G.C. Betteridge, LL.B. (Solicitor), District Secretary

DX 34208 Fax (0249) 443152

tel: CHIPPENHAM (0249) 443322 ext: 598 Rachel Hind

E 65/92

*North
Wiltshire*

NORTH WILTSHIRE DISTRICT COUNCIL
Monkton Park, CHIPPENHAM, SN15 1ER

Dear Sir/Madam,

24th July 1992

**NORTH WILTSHIRE DISTRICT COUNCIL
TOWN AND COUNTRY PLANNING ACT 1990**

● ENFORCEMENT NOTICE

Land at Littleworth, Bushton, Wiltshire

The Council have issued an Enforcement Notice relating to the above land and I now serve on you a copy of that Notice, in view of your interest in the land. Unless an appeal is made to the Secretary of State as described below, the Notice will take effect on the date shown in the box below and you must then ensure that the required steps for which you may be held responsible are taken within the period or periods specified in the Notice.

If you wish to appeal against the Notice, you should first read carefully the enclosed booklet entitled "Enforcement Notice Appeals - A Guide to Procedure". Then, you or your agent should complete the enclosed appeal form and send it, together with the extra copy of the Enforcement Notice enclosed herewith to the address on the appeal form. Your appeal **MUST BE RECEIVED** by the Department of the Environment **BEFORE THE NOTICE TAKES EFFECT**.

There is a requirement on the Council to specify the reasons why the local planning authority consider it expedient to issue the Notice and these reasons are set out in the Notice.

Yours faithfully,



for District Secretary

DATE ON WHICH NOTICE TAKES EFFECT
AND BEFORE WHICH ANY APPEAL

MUST BE RECEIVED 9th September 1992

To: Mr. Henry Howard
Manor Farm
Marston
Devizes

Mr. Colin Howard
Manor Farm
Marston
Devizes

PLANNING DEPT.	
27 JUL 1992	
PASSED TO	DATE REC.

NORTH WILTSHIRE DISTRICT COUNCIL
TOWN AND COUNTRY PLANNING ACT 1990
ENFORCEMENT NOTICE

Land at Littleworth, Bushton, Wiltshire

WHEREAS :

- (1) It appears to the North Wiltshire District Council ("the Council") being the local planning authority for the purposes of Section 172 of the Town and Country Planning Act 1990 ("the Act") in this matter, that there has been a breach of planning control after the end of 1963 on the land or premises ("the land") described in Schedule 1 below.
- (2) The breach of planning control which appears to have taken place consists in the carrying out of development by the making of the material change in the use of the land described in Schedule 2 below, without the grant of planning permission required for that development.
- (3) The Council consider it expedient, having regard to the provisions of the development plan and to all other material considerations, to issue this enforcement notice, in exercise of their powers contained in the said Section 172, for the reasons set out below.

NOTICE IS HEREBY GIVEN that the Council require that the steps specified in Schedule 3 below be taken in order to remedy the breach within the period of THREE MONTHS from the date on which this Notice takes effect.

THIS NOTICE SHALL TAKE EFFECT, subject to the provisions of Section 175(4) of the Act, on 9th September 1992

ISSUED 24th July 1992

Signed

G. C. Betteridge

DISTRICT SECRETARY

Monkton Park,
Chippenham, SN15 1ER.

/ SCHEDULE 1

(over)

SCHEDULE 1 - LAND OR PREMISES TO WHICH THIS NOTICE RELATES

Land situated on the south western side of the C15 Wootton Bassett to Bushton road at part of O.S. parcel 9875 and part of O.S. parcel 681 "Littleworth" Bushton in the parish of Clyffe Pypard shown stipple-edged on the attached Plan A (hereinafter referred to as "the land")

SCHEDULE 2 - ALLEGED BREACH OF PLANNING CONTROL

The making of a material change in the use of the land from agricultural use to a continued use for that purpose and in addition use for the storage and dismantling of vehicles in connection with use of the adjacent site cross-hatched on the attached plan B at part of O.S. parcel 9875 and a vehicle dismantlers' site and scrapyard and of the adjacent site at part of O.S. parcel 681 as a vehicle dismantlers' site and retail scrap-yard for which planning permission was granted (on appeal - ref. APP/5408/A178/7388 and 9) on 3rd November 1978.

SCHEDULE 3 - STEPS REQUIRED TO BE TAKEN

- (1) To discontinue the use of the land for the storage and dismantling of vehicles
- (2) To remove or secure the removal of the said vehicles or parts of vehicles from the land
- (3) To restore or secure the restoration of the land to a condition suitable for the purposes of agriculture

STATEMENT OF REASONS WHY THE LOCAL AUTHORITY CONSIDER IT EXPEDIENT TO ISSUE THIS NOTICE

The site is situated within an attractive rural landscape where it is Central Government Policy and the Planning Authority's Policy to restrict new development (including the change of use of land) to that required in connection with agriculture or forestry or other uses appropriate to the rural area.

It is considered the unauthorised expansion of this site is unacceptable and the use is unsuitable, inappropriate and visually intrusive in this rural area and should be carried out in a suitable location within or attached to an existing urban area or on land specifically authorised or allocated for such a commercial use.

E 65/92

NORTH WILTSHIRE DISTRICT COUNCIL
TOWN AND COUNTRY PLANNING ACT 1990

ENFORCEMENT NOTICE

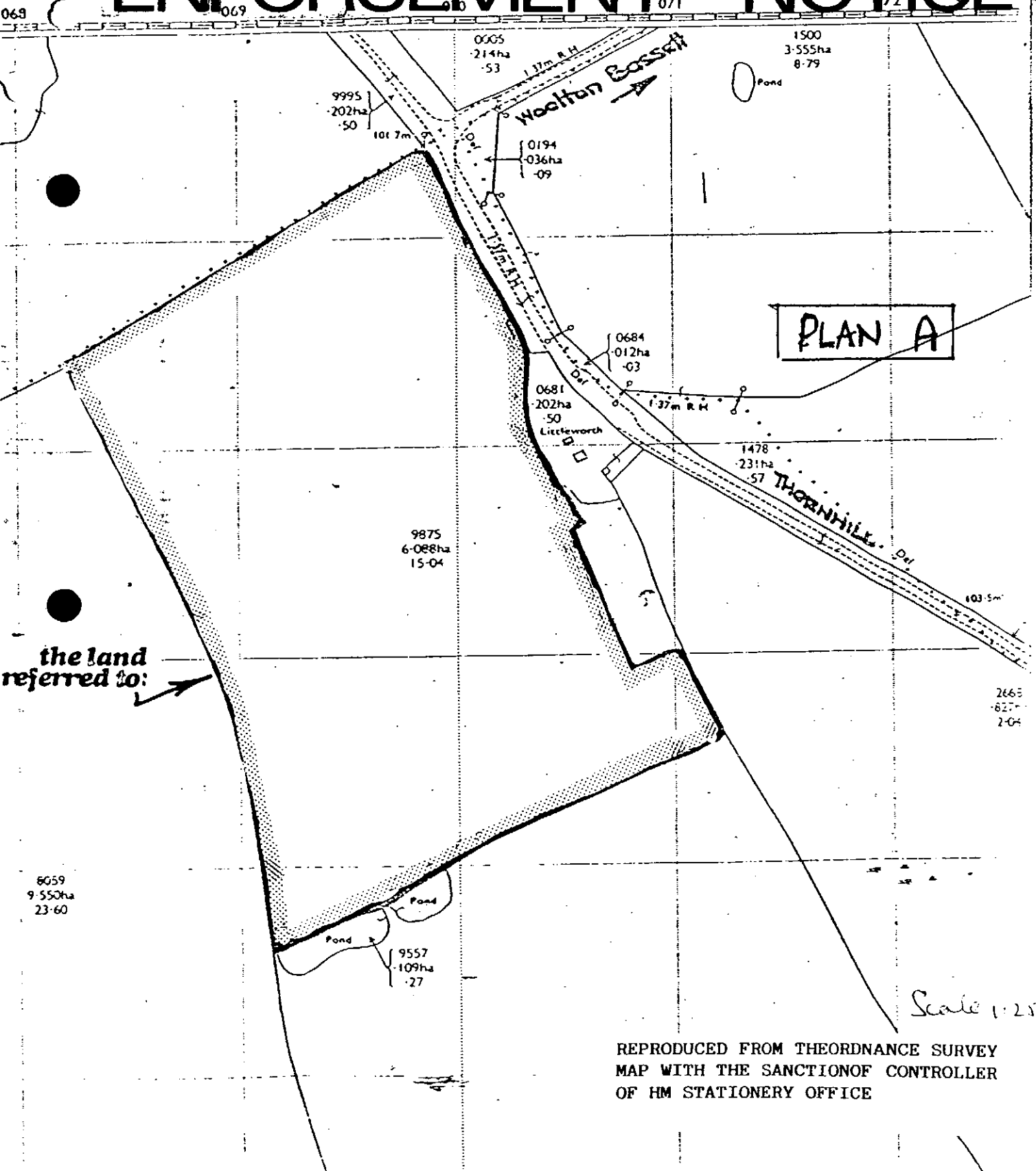

REPRODUCED FROM THE ORDNANCE SURVEY
MAP WITH THE SANCTION OF CONTROLLER
OF HM STATIONERY OFFICE

E 65/92

BROAD TOWN C P

NORTH WILTSHIRE DISTRICT COUNCIL
TOWN AND COUNTRY PLANNING ACT 1990

ENFORCEMENT NOTICE

PLAN B

Scale 1:2500

the land
referred to:

Permission on Appeal
APE/5408/A/78/7388
(N78/0710F)

APP/5408/A/78/7389
(N78/1067F)