

ENFORCEMENT REGISTER INFORMATION SHEET

E/ 617		
APPEAL	yes	no
Plan's Ref		

ADDRESS

HAND AT
PICKWICK HOUSE AND
THE GARDENS
PICKWICK
CORSHAM.

BREACH of CONTROL

Issuing Authority *nwdc*

Date Issued *25.11.91*

STOP NOTICES

Date Served

Requiring

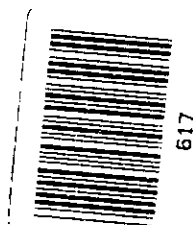

Date(s) served

25.11.91

Takes effect *6.1.92*

Compliance by *6.3.92*

Dates Extended by
Secretary of State

Date withdrawn

REQUIREMENTS of ENFORCEMENTSCHEDULE 3 - STEPS REQUIRED TO BE TAKEN

To demolish the existing rubble stone piers and erect two principal piers in Stoke Base Bath Stone Ashlar narrow jointed and flush pointed in a 1 part lime putty to 4 parts stone dust mortar, all stonework to be traditionally laid and fixed and detailed in accordance with the attached drawing No. 1053/GP

To replace missing and reconstituted stone cappings to the south boundary walls referred to in Schedule 2(2) above and shown hatched on the attached drawing no. COR 89-0140 in Combe Down Bath stone to the same dimensions and jointing of the existing original wall cappings.

- to alleviate the effect of the works which were carried out without Listed Building Consent.

Unauthorized works within the curtilage(s) of the buildings consisting of:-

- (1) The construction of two entrance piers with ball finials fronting the Bath Road (A4)
 - (2) Alterations and the removal of wall capping on the south boundary walls adjacent to the newly constructed entrance gate piers referred to in (1) above
-

IMPORTANT -

THIS COMMUNICATION AFFECTS YOUR PROPERTY

District Secretary's Department,
G. C. Betteridge, LL.B., (Solicitor),
District Secretary



**North Wiltshire
District Council**

Monkton Park,
Chippenham,
Wiltshire, SN15 1ER.
Tel. Chippenham (0249) 654188.
Ext. 598

Our ref **E** 617 Enquiries to Miss Hind

Dear Sir/Madam,

25th November 1991

NORTH WILTSHIRE DISTRICT COUNCIL TOWN AND COUNTRY PLANNING ACT 1971 (as amended) LISTED BUILDING ENFORCEMENT NOTICE

Land at Pickwick House and The Gables, Pickwick, Corsham, Wiltshire

The Council have issued a Listed Building Enforcement Notice relating to the above property and I now serve on you a copy of that Notice, in view of your interest in the premises.

Unless an Appeal is made to the Secretary of State, as described below, the Notice will take effect on the date shown in the box below and you must then ensure that the required steps for which you may be held responsible are taken within the period or periods specified in the Notice.

If you wish to appeal against the Notice, you or your agent should write to the Secretary of State for the Environment, Room 903, Tollgate House, Houlton Street, Bristol, BS2 9DJ setting out the grounds of appeal and stating briefly the facts on which it is proposed to rely in support of each of those grounds. Extracts from the Notice are copied on the accompanying papers and your attention is drawn in particular to the list of grounds of appeal at Section 97(1) (a) to (k). You should enclose with any appeal the extra copy sent herewith of the Notice. **ANY APPEAL MUST BE RECEIVED BY THE DEPARTMENT OF THE ENVIRONMENT BEFORE THE NOTICE TAKES EFFECT.**

The reasons why the local planning authority consider it expedient to issue the Notice are briefly set out in the ANNEX overleaf.

Yours faithfully,

G. C. Betteridge
District Secretary

DATE ON WHICH NOTICE TAKES EFFECT and BEFORE WHICH
ANY APPEAL MUST BE RECEIVED - 6th January 1992

To: Mrs. Lorraine J. Dichler	Mr. Simon M. Peters	Mrs. Lindsey D. Peters
The Coach House	Pickwick House	Pickwick House
Kingwell Hall	Pickwick	Pickwick
Timsbury	Corsham	Corsham
Bath BA3 1HH	SN13OHZ	SN13 OHZ

E617

ANNEX - (This does not form part of the Listed Building enforcement notice)

Reason for issue:

The quality of the finished work is very poor and is detrimental to the character and setting of the adjacent listed buildings and the Pickwick Conservation Area.

NORTH WILTSHIRE DISTRICT COUNCIL
TOWN AND COUNTRY PLANNING ACT 1971 (as amended)
**LISTED BUILDING
ENFORCEMENT NOTICE**

Land at Pickwick House and The Gables, Pickwick, Corsham, Wiltshire

WHEREAS :

- (1) It appears to the North Wiltshire District Council ("the Council") being the local planning authority for the purposes of Section 96 of the Town and Country Planning Act 1971 ("the Act") in this matter, that works have been / are being executed to the listed building in their area described in Schedule 1 below such as to involve a contravention of Section 55 of the Act.
- (2) The contravention which appears to have taken place is described in Schedule 2 below.
- (3) The Council consider it expedient, having regard to the effect of the said works on the character of the listed building as one of special architectural or historic interest and to all other material considerations, to issue this listed building enforcement notice, in exercise of their powers contained in the said Section 96, for the reasons set out in the ANNEX to this Notice.

NOTICE IS HEREBY GIVEN that the Council require that the steps specified in Schedule 3 below be taken for the purpose set out in that Schedule within the period of TWO MONTHS from the date on which this Notice takes effect.

THIS NOTICE SHALL TAKE EFFECT, subject to the provisions of Section 97 of the Act, on 6th January 1992

ISSUED 25th November 1991

Signed

G.C. Bettridge

DISTRICT SECRETARY

Monkton Park,
Chippenham, SN15 1ER

/ SCHEDULE 1

(ove

SCHEDULE 1 - LISTED BUILDINGS TO WHICH THIS NOTICE RELATES

Pickwick House and the Stable/dovecote thereto (now converted to "The Gables") Pickwick, Corsham, Wiltshire, listed Grade II, shown on the attached plan and within the curtilage(s) shown stipple-edged thereon.

SCHEDULE 2 - THE CONTRAVENTION

Unauthorised works within the curtilage(s) of the buildings consisting of:-

- (1) The construction of two entrance piers with ball finials fronting the Bath Road (A4)
- (2) Alterations and the removal of wall capping on the south boundary walls adjacent to the newly constructed entrance gate piers referred to in (1) above

SCHEDULE 3 - STEPS REQUIRED TO BE TAKEN

To demolish the existing rubble stone piers and erect two principal piers in Stoke Base Bath Stone Ashlar narrow jointed and flush pointed in a 1 part lime putty to 4 parts stone dust mortar, all stonework to be traditionally laid and fixed and detailed in accordance with the attached drawing No. 1053/GP

To replace missing and reconstituted stone cappings to the south boundary walls referred to in Schedule 2(2) above and shown hatched on the attached drawing no. COR 89-0140 in Combe Down Bath stone to the same dimensions and jointing of the existing original wall cappings.

- to alleviate the effect of the works which were carried out without Listed Building Consent.

Site Plan

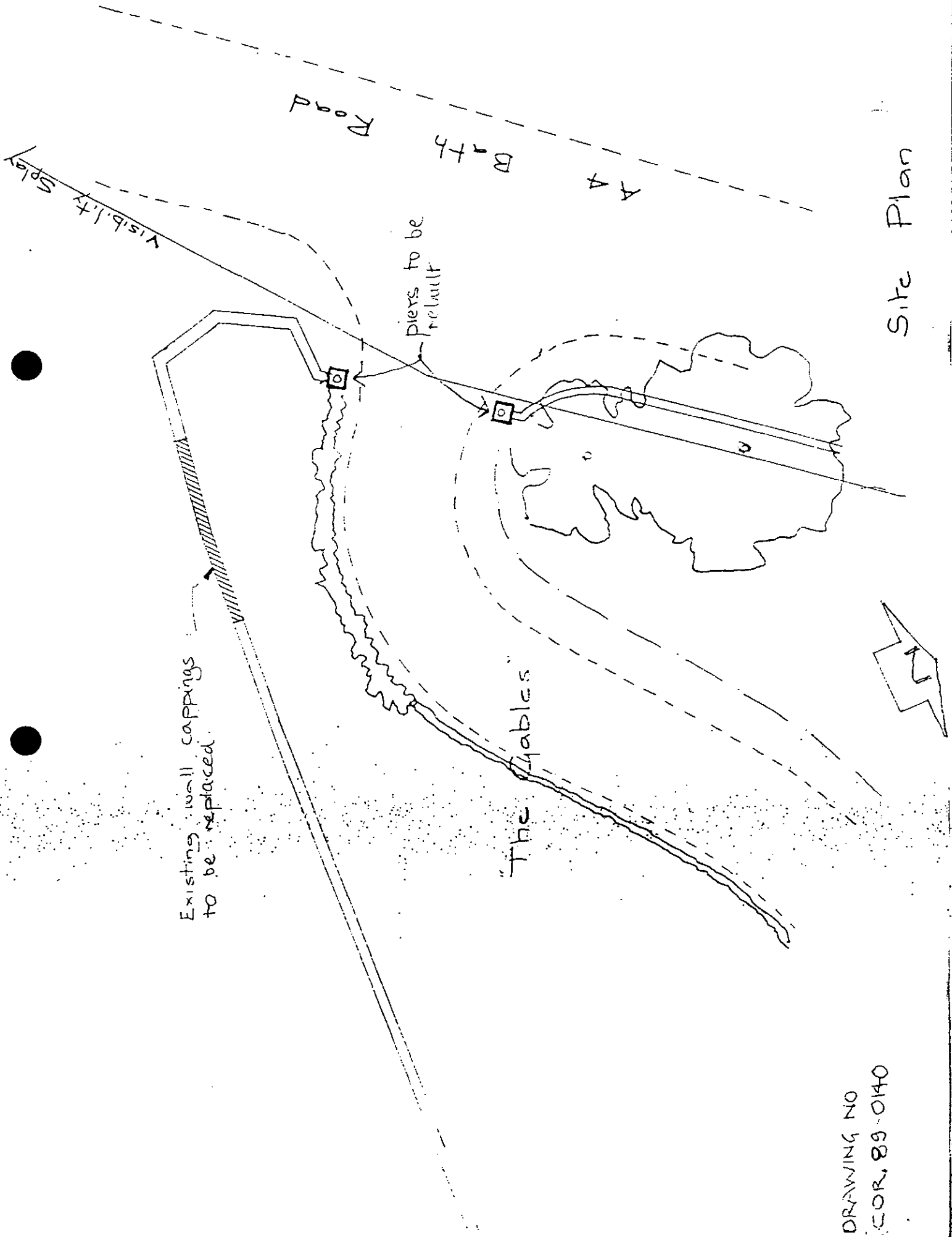

DRAWING NO
COR. 89-0140

GATE PIER

rubble stone walling 450mm thick

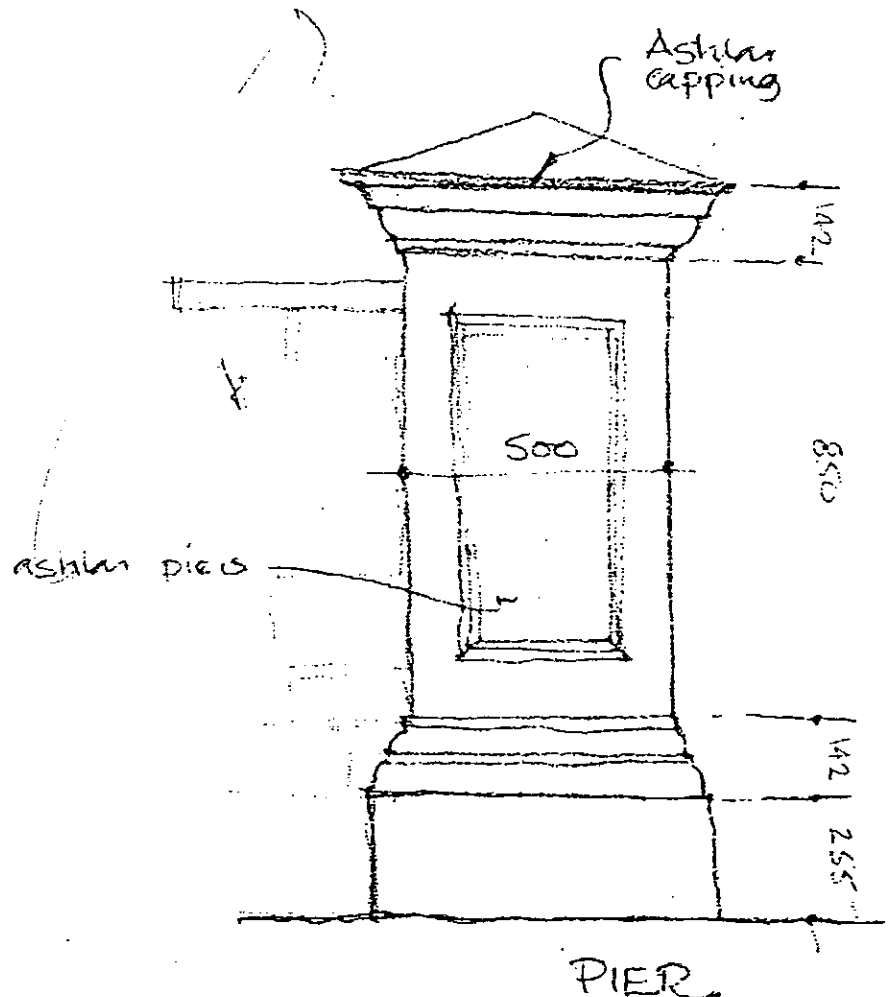

This drawing is copyright

William Bertram and Fell
5 Gay Street Bath BA1 2PH
Telephone Bath 337273
Fax 01225 333841

Detail

The Lodge
Pilkington House

Scale

N.T.S.

Drawing No

1053/GP

Date

July 20

IMPORTANT

**THIS COMMUNICATION AFFECTS
YOUR PROPERTY**

District Secretary's Department,
G. C. Betteridge, LL.B., (Solicitor),
District Secretary



**North Wiltshire
District Council**

Monkton Park,
Chippenham,
Wiltshire, SN15 1ER.
Tel. Chippenham (0249) 654188.
Ext. 598

26 NOV 1991

Our ref **E** 617

Enquiries to

Miss Hind

Dear Sir/Madam,

25th November 1991

**NORTH WILTSHIRE DISTRICT COUNCIL
TOWN AND COUNTRY PLANNING ACT 1971 (as amended)
LISTED BUILDING
ENFORCEMENT NOTICE**

Land at Pickwick House and The Gables, Pickwick, Corsham, Wiltshire

The Council have issued a Listed Building Enforcement Notice relating to the above property and I now serve on you a copy of that Notice, in view of your interest in the premises.

Unless an Appeal is made to the Secretary of State, as described below, the Notice will take effect on the date shown in the box below and you must then ensure that the required steps for which you may be held responsible are taken within the period or periods specified in the Notice.

If you wish to appeal against the Notice, you or your agent should write to the Secretary of State for the Environment, Room 903, Tollgate House, Houlton Street, Bristol, BS2 9DJ setting out the grounds of appeal and stating briefly the facts on which it is proposed to rely in support of each of those grounds. Extracts from the Act are copied on the accompanying papers and your attention is drawn in particular to the list of grounds of appeal at Section 97(1) (a) to (k). You should enclose with any appeal the extra copy sent herewith of the Notice. **ANY APPEAL MUST BE RECEIVED BY THE DEPARTMENT OF THE ENVIRONMENT BEFORE THE NOTICE TAKES EFFECT.**

The reasons why the local planning authority consider it expedient to issue the Notice are briefly set out in the ANNEX overleaf.

Yours faithfully,

G. C. Betteridge
District Secretary

DATE ON WHICH NOTICE TAKES EFFECT and BEFORE WHICH
ANY APPEAL MUST BE RECEIVED - 6th January 1992

To: Mrs. Lorraine J. Dichler	Mr. Simon M. Peters	Mrs. Lindsey D. Peters
The Coach House	Pickwick House	Pickwick House
Kingwell Hall	Pickwick	Pickwick
Timsbury	Corsham	Corsham
Bath BA3 1HH	SN130HZ	SN13 OHZ

E617

ANNEX - (This does not form part of the Listed Building enforcement notice)

Reason for issue:

The quality of the finished work is very poor and is detrimental to the character and setting of the adjacent listed buildings and the Pickwick Conservation Area.

NORTH WILTSHIRE DISTRICT COUNCIL TOWN AND COUNTRY PLANNING ACT 1971 (as amended) LISTED BUILDING ENFORCEMENT NOTICE

Land at Pickwick House and The Gables, Pickwick, Corsham, Wiltshire

WHEREAS :

- (1) It appears to the North Wiltshire District Council ("the Council") being the local planning authority for the purposes of Section 96 of the Town and Country Planning Act 1971 ("the Act") in this matter, that works have been / are being executed to the listed building in their area described in Schedule 1 below such as to involve a contravention of Section 55 of the Act.
- (2) The contravention which appears to have taken place is described in Schedule 2 below.
- (3) The Council consider it expedient, having regard to the effect of the said works on the character of the listed building as one of special architectural or historic interest and to all other material considerations, to issue this listed building enforcement notice, in exercise of their powers contained in the said Section 96, for the reasons set out in the ANNEX to this Notice.

NOTICE IS HEREBY GIVEN that the Council require that the steps specified in Schedule 3 below be taken for the purposes set out in that Schedule within the period of TWO MONTHS from the date on which this Notice takes effect.

THIS NOTICE SHALL TAKE EFFECT, subject to the provisions of Section 97 of the Act, on 6th January 1992

ISSUED 25th November 1991

Signed

G.C. Bettridge

DISTRICT SECRETARY

Monkton Park,
Chippenham, SN15 1ER

/ SCHEDULE 1

(ove

SCHEDULE 1 - LISTED BUILDINGS TO WHICH THIS NOTICE RELATES

Pickwick House and the Stable/dovecote thereto (now converted to "The Gables") Pickwick, Corsham, Wiltshire, listed Grade II, shown on the attached plan and within the curtilage(s) shown stipple-edged thereon.

SCHEDULE 2 - THE CONTRAVENTION

Unauthorised works within the curtilage(s) of the buildings consisting of:-

- (1) The construction of two entrance piers with ball finials fronting the Bath Road (A4)
- (2) Alterations and the removal of wall capping on the south boundary walls adjacent to the newly constructed entrance gate piers referred to in (1) above

SCHEDULE 3 - STEPS REQUIRED TO BE TAKEN

To demolish the existing rubble stone piers and erect two principal piers in Stoke Base Bath Stone Ashlar narrow jointed and flush pointed in a 1 part lime putty to 4 parts stone dust mortar, all stonework to be traditionally laid and fixed and detailed in accordance with the attached drawing No. 1053/GP

To replace missing and reconstituted stone cappings to the south boundary walls referred to in Schedule 2(2) above and shown hatched on the attached drawing no. COR 89-0140 in Combe Down Bath stone to the same dimensions and jointing of the existing original wall cappings.

- to alleviate the effect of the works which were carried out without Listed Building Consent.

Site Plan

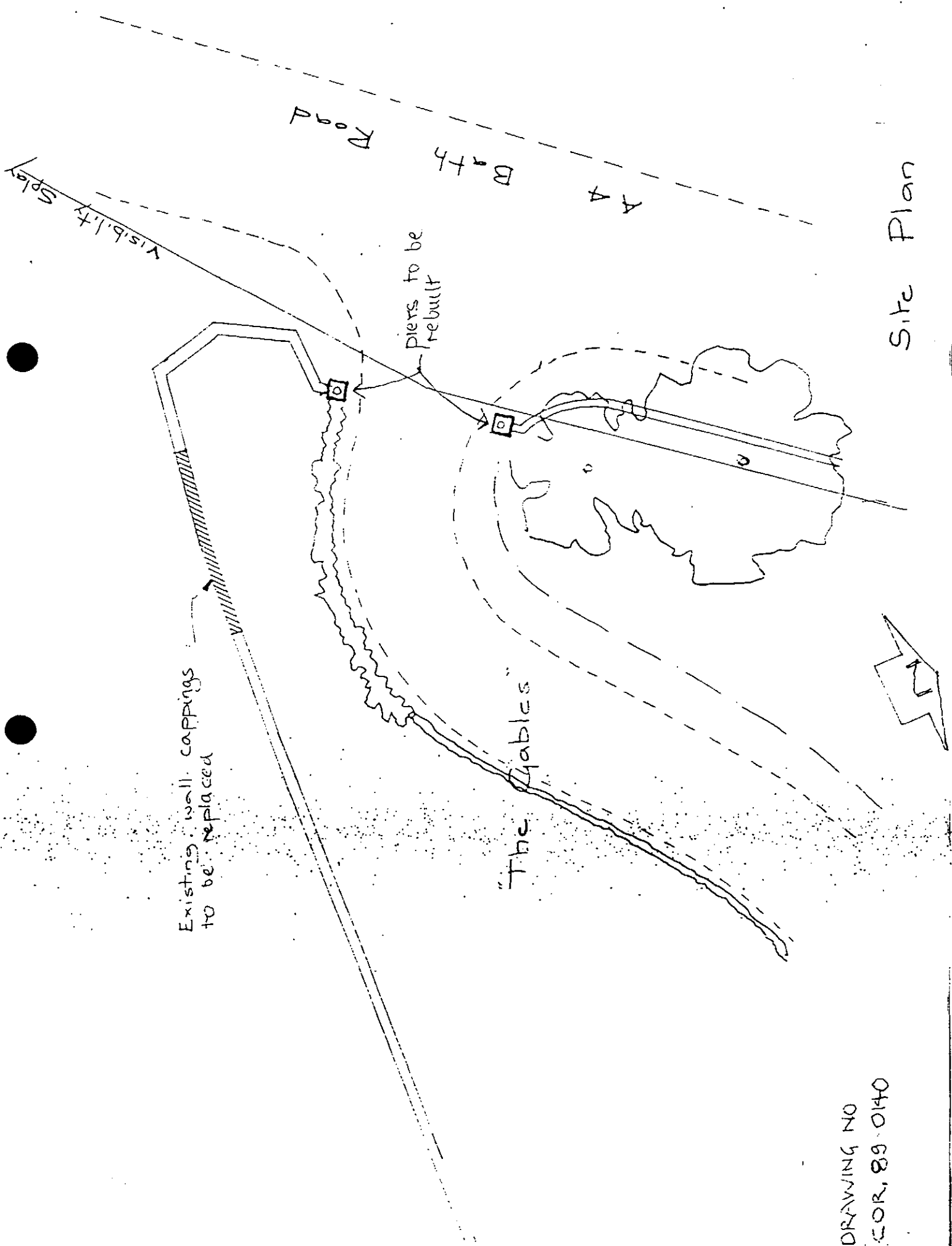

DRAWING NO
COR, 89-0140

GATE PIER

tubed stone walling 450mm thick

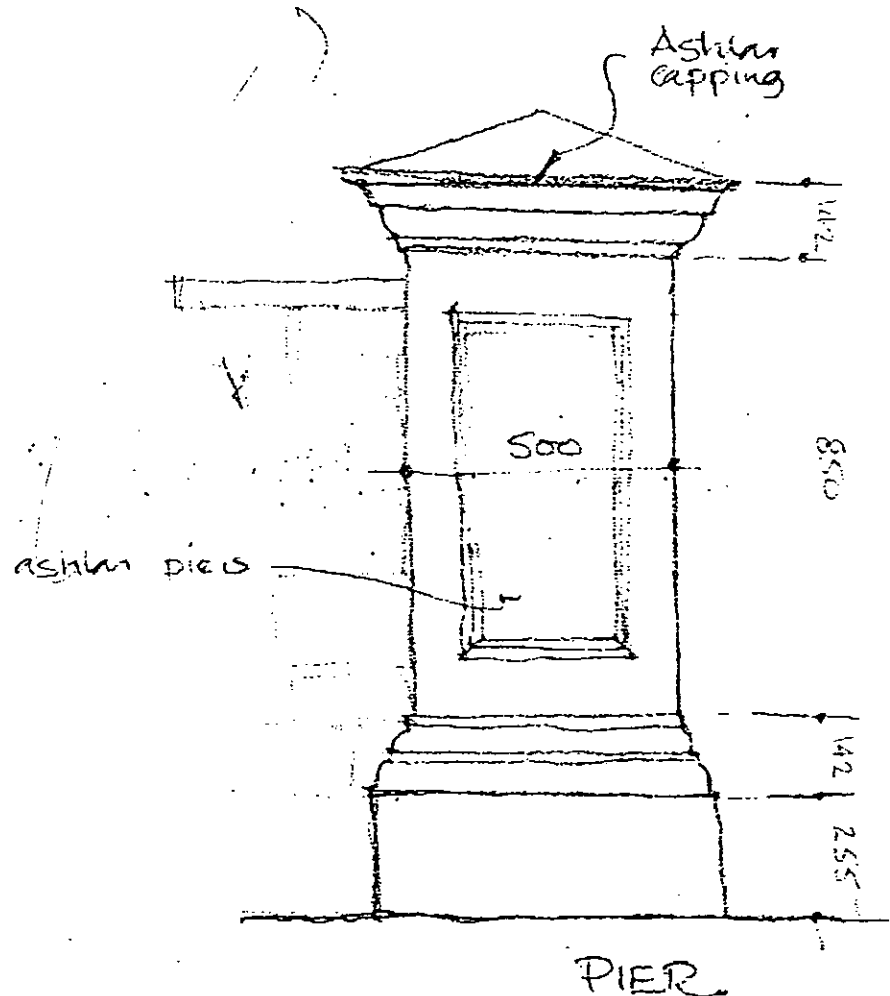

This drawing is copyright

William Bertram and Fell
5 Gay Street Bath BA1 2PH
Telephone Bath 337273
Fax 0225 373841

Detail

The Lodge
Parkwick, Henric

Scale

N.T.S.

Drawing No

1053/GP

Date

July 98

WILTSHIRE

ST 862

863

864

865

866

E 617

NORTH WILTSHIRE DISTRICT COUNCIL
TOWN AND COUNTRY PLANNING ACT 1971 (as amended)

LISTED BUILDING ENFORCEMENT NOTICE

Pickwick House and The Gables (Dovecote) Pickwick Corsham

708

707

706

Beechfield
Bath Academy of Art)

Tennis
Court

Hare
and
Hounds
(PH)

B 3353

CONSERVATION AREA
Pickwick

APPROXIMATE POSITION OF PIERS

El Sub
Sta

Highcreech

Boat Bldg
Wks
Pool

Listed Building 4/401 (Dovecote)

X
Notional revised curtilage
boundary to
Pickwick House

Listed Building 4/300 (Pickwick House)

Scale 1:1250

This drawing is taken from the 1969 Ordnance
Survey and fails to represent, in particular,
new residential development at **X** and **Y**

Reproduced from the Ordnance Survey
Map of the County of Wiltshire
at 1:25,000 Scale

IMPORTANT
THIS COMMUNICATION AFFECTS
YOUR PROPERTY

District Secretary's Department,
G. C. Betteridge, LL.B., (Solicitor),
District Secretary



**North Wiltshire
District Council**

Monkton Park,
Chippenham,
Wiltshire, SN15 1ER.
Tel. Chippenham (0249) 654188.
Ext. 598

617

Our ref **E** 617 Enquiries to Miss Hind

Dear Sir/Madam,

25th November 1991

**NORTH WILTSHIRE DISTRICT COUNCIL
TOWN AND COUNTRY PLANNING ACT 1971 (as amended)
LISTED BUILDING
ENFORCEMENT NOTICE**

Land at Pickwick House and The Gables, Pickwick, Corsham, Wiltshire

The Council have issued a Listed Building Enforcement Notice relating to the above property and I now serve on you a copy of that Notice, in view of your interest in the premises.

Unless an Appeal is made to the Secretary of State, as described below, the Notice will take effect on the date shown in the box below and you must then ensure that the required steps for which you may be held responsible are taken within the period or periods specified in the Notice.

If you wish to appeal against the Notice, you or your agent should write to the Secretary of State for the Environment, Room 903, Tollgate House, Houlton Street, Bristol, BS2 9DJ setting out the grounds of appeal and stating briefly the facts on which it is proposed to rely in support of each of those grounds. Extracts from the Act are copied on the accompanying papers and your attention is drawn in particular to the list of grounds of appeal at Section 97(1) (a) to (k). You should enclose with any appeal the extra copy sent herewith of the Notice. **ANY APPEAL MUST BE RECEIVED BY THE DEPARTMENT OF THE ENVIRONMENT BEFORE THE NOTICE TAKES EFFECT.**

The reasons why the local planning authority consider it expedient to issue the Notice are briefly set out in the ANNEX overleaf.

Yours faithfully,

G. C. Betteridge
District Secretary

DATE ON WHICH NOTICE TAKES EFFECT and BEFORE WHICH
ANY APPEAL MUST BE RECEIVED - 6th January 1992

To: Mrs. Lorraine J. Dichler	Mr. Simon M. Peters	Mrs. Lindsey D. Peters
The Coach House	Pickwick House	Pickwick House
Kingwell Hall	Pickwick	Pickwick
Timsbury	Corsham	Corsham
Bath BA3 1HH	SN130HZ	SN13 0HZ

E617

ANNEX - (This does not form part of the Listed Building enforcement notice)

Reason for issue:

The quality of the finished work is very poor and is detrimental to the character and setting of the adjacent listed buildings and the Pickwick Conservation Area.

NORTH WILTSHIRE DISTRICT COUNCIL
TOWN AND COUNTRY PLANNING ACT 1971 (as amended)
**LISTED BUILDING
ENFORCEMENT NOTICE**

Land at Pickwick House and The Gables, Pickwick, Corsham, Wiltshire

WHEREAS :

- (1) It appears to the North Wiltshire District Council ("the Council") being the local planning authority for the purposes of Section 96 of the Town and Country Planning Act 1971 ("the Act") in this matter, that works have been / are being executed to the listed building in their area described in Schedule 1 below such as to involve a contravention of Section 55 of the Act.
- (2) The contravention which appears to have taken place is described in Schedule 2 below.
- (3) The Council consider it expedient, having regard to the effect of the said works on the character of the listed building as one of special architectural or historic interest and to all other material considerations, to issue this listed building enforcement notice, in exercise of their powers contained in the said Section 96, for the reasons set out in the ANNEX to this Notice.

NOTICE IS HEREBY GIVEN that the Council require that the steps specified in Schedule 3 below be taken for the purposes set out in that Schedule within the period of TWO MONTHS from the date on which this Notice takes effect.

THIS NOTICE SHALL TAKE EFFECT, subject to the provisions of Section 97 of the Act, on 6th January 1992

ISSUED 25th November 1991

Signed

G.C. Bettridge

DISTRICT SECRETARY

Monkton Park,
Chippenham, SN15 1ER

/ SCHEDULE 1

(over)

SCHEDULE 1 - LISTED BUILDINGS TO WHICH THIS NOTICE RELATES

Pickwick House and the Stable/dovecote thereto (now converted to "The Gables") Pickwick, Corsham, Wiltshire, listed Grade II, shown on the attached plan and within the curtilage(s) shown stipple-edged thereon.

SCHEDULE 2 - THE CONTRAVENTION

Unauthorised works within the curtilage(s) of the buildings consisting of:-

- (1) The construction of two entrance piers with ball finials fronting the Bath Road (A4)
- (2) Alterations and the removal of wall capping on the south boundary walls adjacent to the newly constructed entrance gate piers referred to in (1) above

SCHEDULE 3 - STEPS REQUIRED TO BE TAKEN

To demolish the existing rubble stone piers and erect two principal piers in Stoke Base Bath Stone Ashlar narrow jointed and flush pointed in a 1 part lime putty to 4 parts stone dust mortar, all stonework to be traditionally laid and fixed and detailed in accordance with the attached drawing No. 1053/GP

To replace missing and reconstituted stone cappings to the south boundary walls referred to in Schedule 2(2) above and shown hatched on the attached drawing no. COR 89-0140 in Combe Down Bath stone to the same dimensions and jointing of the existing original wall cappings.

- to alleviate the effect of the works which were carried out without Listed Building Consent.

Site Plan

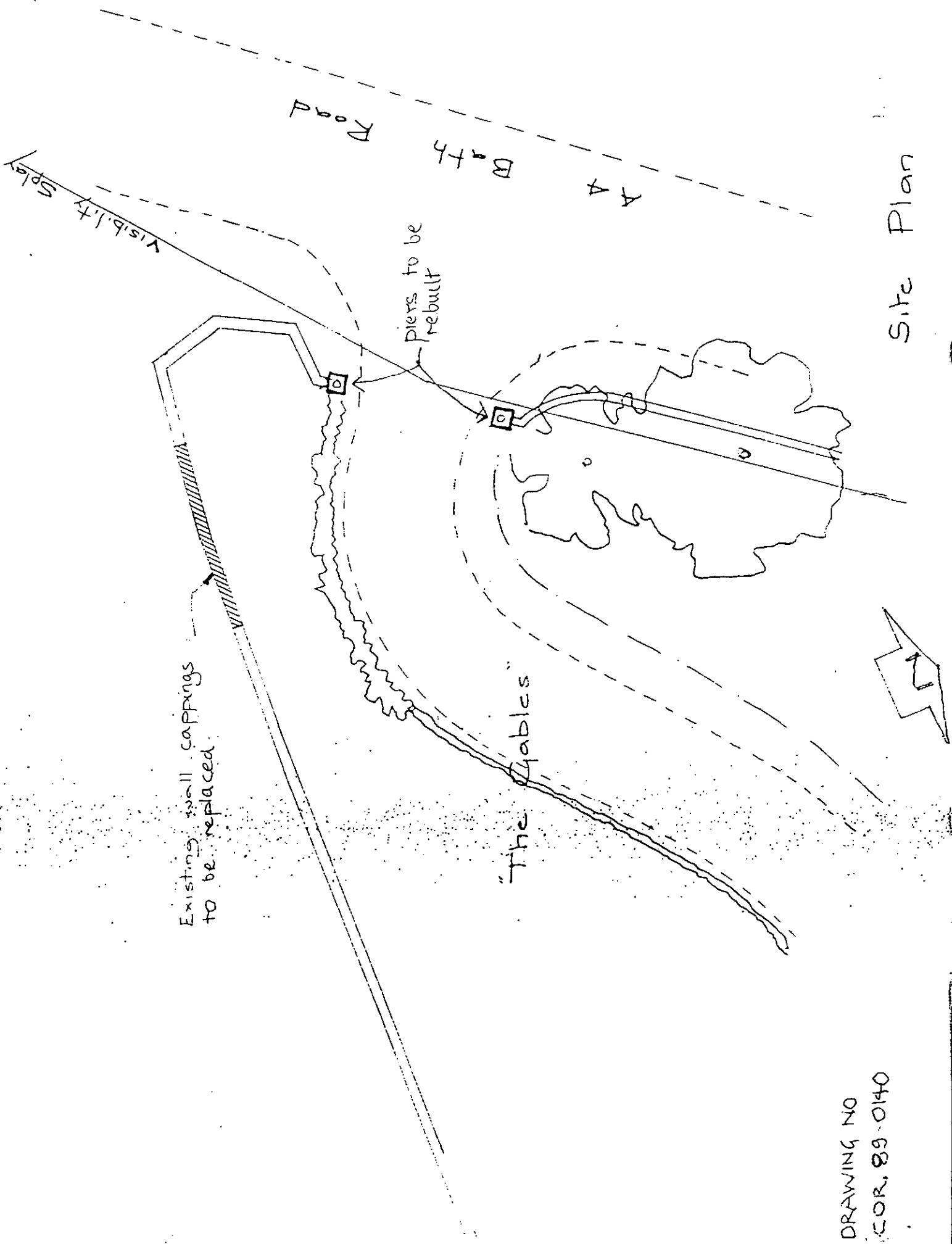

DRAWING NO
COR. 89-0140

GATE PIER

rubble stone walling 450mm thick

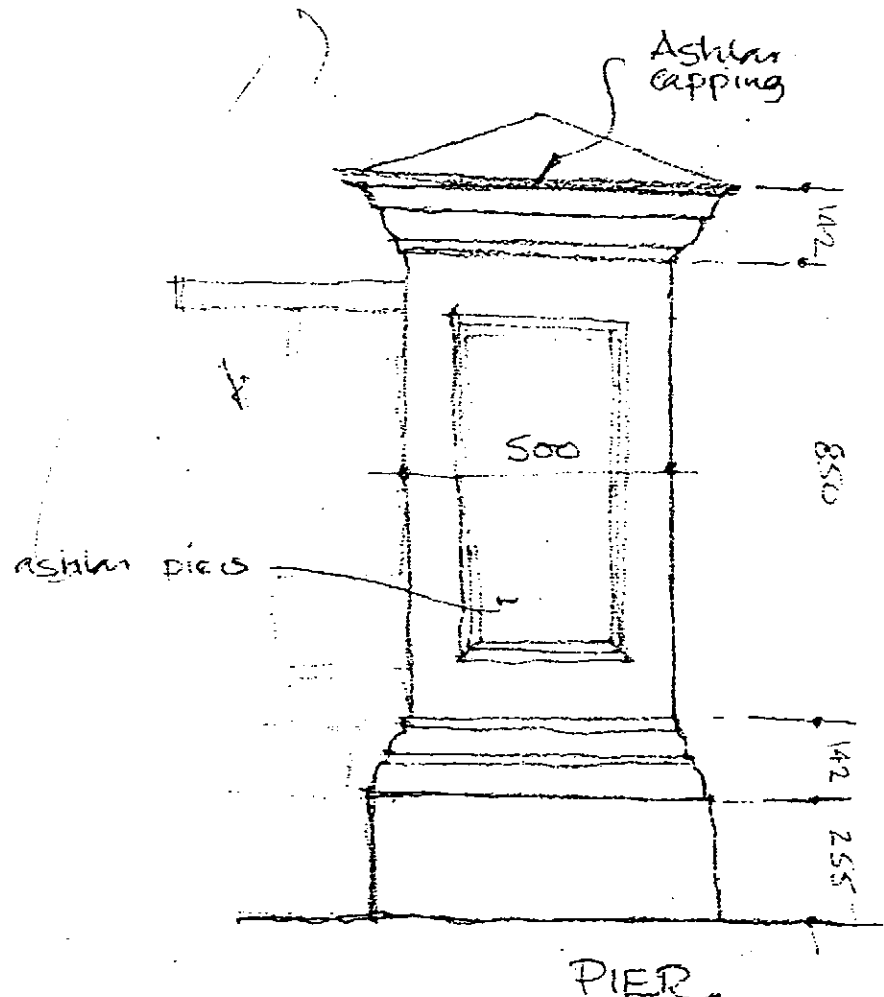

This drawing is copyright

William Bertram and Fell
5 Gay Street, Bath BA1 2PH
Telephone Bath 337273
Fax 0225 313801

Detail

The Lodge
Puckwood House

Scale

N.T.S.

Drawing No

1053/GP

Date

July 20

WILTSHIRE

ST 862

863

864

865

866

E 617

NORTH WILTSHIRE DISTRICT COUNCIL
TOWN AND COUNTRY PLANNING ACT 1971 (as amended)

LISTED BUILDING ENFORCEMENT NOTICE

Pickwick House and The Gables (Dovecote) Pickwick, Corsham

708

707

706

Beechfield
Bath Academy of Art)

Tennis
Court

Hare
and
Hounds
(PH)

B 3353

CONSERVATION AREA
Pickwick

APPROXIMATE POSITION OF PIERS

Listed Building 4/401 (Dovecote)

Listed Building 4/300 (Pickwick House)

X
Notional revised curtilage
boundary to
Pickwick House

This drawing is taken from the 1969 Ordnance
Survey and fails to represent, in particular,
new residential development at **X** and **Y**

Scale 1:1250

Extract from the Ordnance Survey
Map of the County of Wiltshire
© Crown Copyright