

**ENFORCEMENT REGISTER  
INFORMATION SHEET****E/** 15550

APPEAL    yes    no

Plan's Ref

**ADDRESS**

LAND ON EASTERN SIDE  
OF:  
MALMOSEBURY BY-PASS  
MALMOSEBURY.

**BREACH of CONTROL**

THE MAKING OF A MATERIAL CHANGE IN THE  
USE OF THE LAND FROM USE FOR THE  
PURPOSES OF AGRICULTURE TO USE FOR THAT  
PURPOSE AND IN ADDITION, THE STORAGE OF  
WASTE MATERIALS BUILDING MATERIALS AND  
OTHER WASTE MATERIALS AND OLD  
TARMACED

Issuing Authority    NWDC

Date Issued    20.10.89

**STOP NOTICES**

Date Served

Requiring



Date(s) served

20.10.89

Takes effect    4.12.89

Compliance by    4.2.90

Dates Extended by  
Secretary of State

Date withdrawn

**REQUIREMENTS of ENFORCEMENT**

(i) TO CEASE THE USE OF THE LAND FOR STORAGE  
OTHER THAN AGRICULTURAL STORAGE.

(ii) TO REMOVE FROM THE LAND THE SAID WASTE  
BUILDING MATERIALS AND OTHER WASTE MATERIALS  
AND OLD TARMACED.

EXTENT to WHICH NOTICE COMPLIED WITH (dates)

**IMPORTANT -**  
**THIS COMMUNICATION AFFECTS**  
**YOUR PROPERTY**

District Secretary's Department,  
G. C. Betteridge, LL.B., (Solicitor),  
District Secretary



**North Wiltshire**  
**District Council**

Monkton Park,  
Chippenham,  
Wiltshire, SN15 1ER.  
Tel. Chippenham (0249) 443322  
Ext. 594

Our ref **E** 550

Enquiries to

PLANNING	
24 OCT 1989	
Mr. Cox	
MS	

Your ref

20th October, 1989

Dear Sir/Madam,

**NORTH WILTSHIRE DISTRICT COUNCIL**  
**TOWN AND COUNTRY PLANNING ACT 1971 (as amended)**  
**ENFORCEMENT NOTICE**

Land on the eastern side of Malmesbury By-Pass, MALMESBURY

The Council have issued an Enforcement Notice relating to the above land and I now serve on you a copy of that Notice, in view of your interest in the land. Unless an appeal is made to the Secretary of State as described below, the Notice will take effect on the date shown in the box below and you must then ensure that the required steps for which you may be held responsible are taken within the period or periods specified in the Notice.

If you wish to appeal against the Notice, you should first read carefully the enclosed booklet entitled "Enforcement Notice Appeals - A Guide to Procedure". Then, you or your agent should complete the enclosed appeal form and send it, together with the extra copy of the Enforcement Notice enclosed herewith to the address on the appeal form. Your appeal **MUST BE RECEIVED** by the Department of the Environment **BEFORE THE NOTICE TAKES EFFECT**.

There is a requirement on the Council to specify the reasons why the local planning authority consider it expedient to issue the Notice and these reasons are set out in the ANNEX overleaf.

Yours faithfully,

District Secretary

DATE ON WHICH NOTICE TAKES EFFECT  
AND BEFORE WHICH ANY APPEAL  
MUST BE RECEIVED 4th December, 1989

To:

Mr. J.L. Cunningham  
Cowbridge Rise  
Swindon Road  
Malmesbury  
Wiltshire  
SN16 9LU

E550

ANNEX - (This does not form part of the Enforcement Notice)

The use of this prominent site for the storage of waste building materials would have a detrimental effect on the attractive rural character and visual amenity of the area, thereby creating an undesirable precedent for similar proposals.

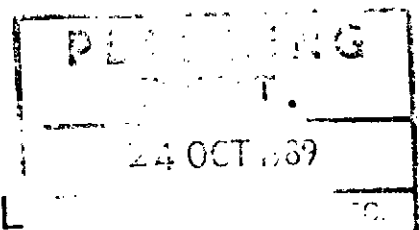

NORTH WILTSHIRE DISTRICT COUNCIL  
TOWN AND COUNTRY PLANNING ACT, 1971 (as amended)  
**ENFORCEMENT NOTICE**

Land on the eastern side of Malmesbury By-Pass, MALMESBURY

WHEREAS :

- (1) It appears to the North Wiltshire District Council ("the Council") being the local planning authority for the purposes of Section 87 of the Town and Country Planning Act 1971 ("the Act") in this matter, that there has been a breach of planning control after the end of 1963 on the land or premises ("the land") described in Schedule 1 below.
- (2) The breach of planning control which appears to have taken place consists in the carrying out of development by the making of the material change in the use of the land described in Schedule 2 below, without the grant of planning permission required for that development.
- (3) The Council consider it expedient, having regard to the provisions of the development plan and to all other material considerations, to issue this enforcement notice, in exercise of their powers contained in the said Section 87, for the reasons set out in the ANNEX to this Notice.

NOTICE IS HEREBY GIVEN that the Council require that the steps specified in Schedule 3 below be taken in order to remedy the breach within the period of TWO MONTHS from the date on which this Notice takes effect.

THIS NOTICE SHALL TAKE EFFECT, subject to the provisions of Section 88(10) of the Act, on 4th December, 1989

ISSUED 20th October, 1989

Signed G.C. Butridge

Monkton Park,  
Chippenham, SN15 1ER.

/ SCHEDULE 1 . . . . .

(over)

E550

SCHEDULE 1 - Land or premises to which this notice relates

Land comprising O.S. Parcel 7781 on the eastern side of the A429 Malmesbury to Cirencester Road (Malmesbury By-Pass), Malmesbury, Wiltshire, shown edged red on the attached plan.

SCHEDULE 2 - Alleged Breach of Planning Control

The making of a material change in the use of the land from use for the purpose of agriculture to use for that purpose and in addition, the storage of waste building materials and other waste materials and old tarmacadam.

SCHEDULE 3 - Steps required to be taken

- (i) To cease the use of the land for storage other than agricultural storage
- (ii) To remove from the land the said waste building materials and other waste materials and old tarmacadam.

Ray

**IMPORTANT -**

**THIS COMMUNICATION AFFECTS  
YOUR PROPERTY**

District Secretary's Department,  
G. C. Betteridge, LL.B., (Solicitor),  
District Secretary



**North Wiltshire  
District Council**

Monkton Park,  
Chippenham,  
Wiltshire, SN15 1ER.  
Tel. Chippenham (0249) 443322  
Ext. 594

Our ref **E** 550

Enquiries to Mr. Cox

Your ref

20th October, 1989

Dear Sir/Madam,

**NORTH WILTSHIRE DISTRICT COUNCIL**

**TOWN AND COUNTRY PLANNING ACT 1971 (as amended)**

# ● **ENFORCEMENT NOTICE**

**Land on the eastern side of Malmesbury By-Pass, MALMESBURY**

The Council have issued an Enforcement Notice relating to the above land and I now serve on you a copy of that Notice, in view of your interest in the land. Unless an appeal is made to the Secretary of State as described below, the Notice will take effect on the date shown in the box below and you must then ensure that the required steps for which you may be held responsible are taken within the period or periods specified in the Notice.

If you wish to appeal against the Notice, you should first read carefully the enclosed booklet entitled "Enforcement Notice Appeals - A Guide to Procedure". Then, you or your agent should complete the enclosed appeal form and send it, together with the extra copy of the Enforcement Notice enclosed herewith to the address on the appeal form. Your appeal **MUST BE RECEIVED** by the Department of the Environment **BEFORE THE NOTICE TAKES EFFECT**.

There is a requirement on the Council to specify the reasons why the local planning authority consider it expedient to issue the Notice and these reasons are set out in the ANNEX overleaf.

Yours faithfully,

District Secretary

DATE ON WHICH NOTICE TAKES EFFECT  
AND BEFORE WHICH ANY APPEAL  
MUST BE RECEIVED 4th December, 1989

To:

Mr. J.L. Cunningham  
Cowbridge Rise  
Swindon Road  
Malmesbury  
Wiltshire  
SN16 9LU

E550

ANNEX - (This does not form part of the Enforcement Notice)

*The use of this prominent site for the storage of waste building materials would have a detrimental effect on the attractive rural character and visual amenity of the area, thereby creating an undesirable precedent for similar proposals.*

NORTH WILTSHIRE DISTRICT COUNCIL  
TOWN AND COUNTRY PLANNING ACT 1971 (as amended)  
**ENFORCEMENT NOTICE**

Land on the eastern side of Malmesbury By-Pass, MALMESBURY

---

WHEREAS :

- (1) It appears to the North Wiltshire District Council ("the Council") being the local planning authority for the purposes of Section 87 of the Town and Country Planning Act 1971 ("the Act") in this matter, that there has been a breach of planning control after the end of 1963 on the land or premises ("the land") described in Schedule 1 below.
- (2) The breach of planning control which appears to have taken place consists in the carrying out of development by the making of the material change in the use of the land described in Schedule 2 below, without the grant of planning permission required for that development.
- (3) The Council consider it expedient, having regard to the provisions of the development plan and to all other material considerations, to issue this enforcement notice, in exercise of their powers contained in the said Section 87, for the reasons set out in the ANNEX to this Notice.

NOTICE IS HEREBY GIVEN that the Council require that the steps specified in Schedule 3 below be taken in order to remedy the breach within the period of TWO MONTHS from the date on which this Notice takes effect.

THIS NOTICE SHALL TAKE EFFECT, subject to the provisions of Section 88(10) of the Act, on 4th December, 1989

ISSUED 20th October, 1989

Signed

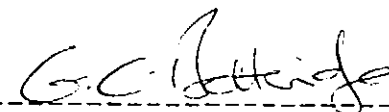

Monkton Park,  
Chippenham, SN15 1ER.

/ SCHEDULE 1 . . . . .

(over)



SCHEDULE 1 - Land or premises to which this notice relates

Land comprising O.S. Parcel 7781 on the eastern side of the A429 Malmesbury to Cirencester Road (Malmesbury By-Pass), Malmesbury, Wiltshire, shown edged red on the attached plan.

SCHEDULE 2 - Alleged Breach of Planning Control

The making of a material change in the use of the land from use for the purpose of agriculture to use for that purpose and in addition, the storage of waste building materials and other waste materials and old tarmacadam.

SCHEDULE 3 - Steps required to be taken

- (i) To cease the use of the land for storage other than agricultural storage
- (ii) To remove from the land the said waste building materials and other waste materials and old tarmacadam.

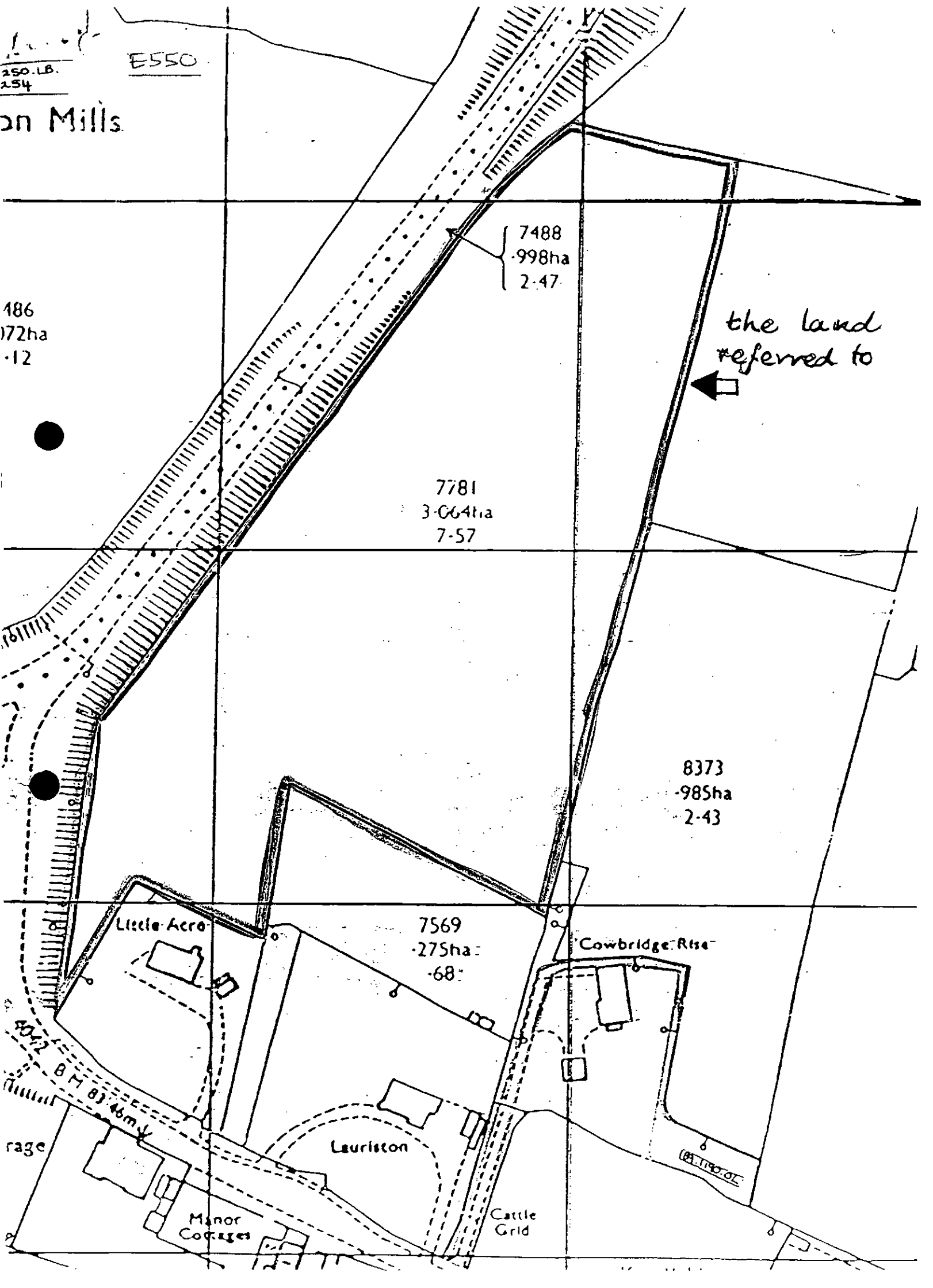

# IMPORTANT -

## THIS COMMUNICATION AFFECTS YOUR PROPERTY

District Secretary's Department,  
G. C. Betteridge, LL.B., (Solicitor),  
District Secretary



*Ray*  
550.  
**North Wiltshire  
District Council**

Monkton Park,  
Chippenham,  
Wiltshire. SN15 1ER.  
Tel. Chippenham (0249) 443322  
Ext. 594

Our ref **E** 550

Enquiries to Mr. Cox

Your ref

20th October, 1989

Dear Sir/Madam,

## NORTH WILTSHIRE DISTRICT COUNCIL TOWN AND COUNTRY PLANNING ACT 1971 (as amended) **ENFORCEMENT NOTICE**

### Land on the eastern side of Malmesbury By-Pass, MALMESBURY

The Council have issued an Enforcement Notice relating to the above land and I now serve on you a copy of that Notice, in view of your interest in the land. Unless an appeal is made to the Secretary of State as described below, the Notice will take effect on the date shown in the box below and you must then ensure that the required steps for which you may be held responsible are taken within the period or periods specified in the Notice.

If you wish to appeal against the Notice, you should first read carefully the enclosed booklet entitled "Enforcement Notice Appeals - A Guide to Procedure". Then, you or your agent should complete the enclosed appeal form and send it, together with the extra copy of the Enforcement Notice enclosed herewith to the address on the appeal form. Your appeal **MUST BE RECEIVED** by the Department of the Environment **BEFORE THE NOTICE TAKES EFFECT**.

There is a requirement on the Council to specify the reasons why the local planning authority consider it expedient to issue the Notice and these reasons are set out in the ANNEX overleaf.

Yours faithfully,

District Secretary

DATE ON WHICH NOTICE TAKES EFFECT  
AND BEFORE WHICH ANY APPEAL  
MUST BE RECEIVED 4th December, 1989

To:

Mr. J.L. Cunningham  
Cowbridge Rise  
Swindon Road  
Malmesbury  
Wiltshire  
SN16 9LU

E550

ANNEX - (This does not form part of the Enforcement Notice)

*The use of this prominent site for the storage of waste building materials would have a detrimental effect on the attractive rural character and visual amenity of the area, thereby creating an undesirable precedent for similar proposals.*

NORTH WILTSHIRE DISTRICT COUNCIL  
TOWN AND COUNTRY PLANNING ACT 1971 (as amended)  
**ENFORCEMENT NOTICE**

Land on the eastern side of Malmesbury By-Pass, MALMESBURY

---

WHEREAS :

- (1) It appears to the North Wiltshire District Council ("the Council") being the local planning authority for the purposes of Section 87 of the Town and Country Planning Act 1971 ("the Act") in this matter, that there has been a breach of planning control after the end of 1963 on the land or premises ("the land") described in Schedule 1 below.
- (2) The breach of planning control which appears to have taken place consists in the carrying out of development by the making of the material change in the use of the land described in Schedule 2 below, without the grant of planning permission required for that development.
- (3) The Council consider it expedient, having regard to the provisions of the development plan and to all other material considerations, to issue this enforcement notice, in exercise of their powers contained in the said Section 87, for the reasons set out in the ANNEX to this Notice.

NOTICE IS HEREBY GIVEN that the Council require that the steps specified in Schedule 3 below be taken in order to remedy the breach within the period of TWO MONTHS from the date on which this Notice takes effect.

THIS NOTICE SHALL TAKE EFFECT, subject to the provisions of Section 88(10) of the Act, on 4th December, 1989

ISSUED 20th October, 1989

Signed

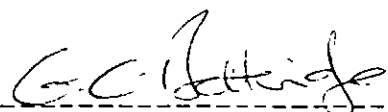

Monkton Park,  
Chippenham, SN15 1ER.

/ SCHEDULE 1 . . . . .

(over)

SCHEDULE 1 - Land or premises to which this notice relates

Land comprising O.S. Parcel 7781 on the eastern side of the A429 Malmesbury to Cirencester Road (Malmesbury By-Pass), Malmesbury, Wiltshire, shown edged red on the attached plan.

SCHEDULE 2 - Alleged Breach of Planning Control

The making of a material change in the use of the land from use for the purpose of agriculture to use for that purpose and in addition, the storage of waste building materials and other waste materials and old tarmacadam.

SCHEDULE 3 - Steps required to be taken

- (i) To cease the use of the land for storage other than agricultural storage
- (ii) To remove from the land the said waste building materials and other waste materials and old tarmacadam.

250.18.  
254

ES50

on Mills

486  
72ha  
-12

7488  
998ha  
2.47

the land  
referred to



7781  
3.664ha  
7.57

8373  
985ha  
2.43

Little Aero

7569  
275ha  
68

Cowbridge Rise

80-12  
8 M 83.46m

rage

Lauriston

Minor  
Cottages

Cattle  
Grid

18.11.19.02