

**ENFORCEMENT  
INFORMATION****REGISTER  
SHEET****E/** 432.

APPEAL

yes

no

Plan's Ref

**ADDRESS**

OAKLANDS FARM.  
BRAYDON  
WOOTTON BASSETT.

**BREACH of CONTROL**

THE MATERIAL CHANGE IN THE USE  
OF THE LAND FROM AGRICULTURAL LAND  
TO A USE FOR THAT PURPOSE AND, IN  
ADDITION, THE REPAIR OF HAULAGE  
AND OTHER VEHICLES AND THE STORAGE  
OF SUCH VEHICLES AND OFFICE USES  
IN CONNECTION WITH THAT BUSINESS

**Issuing Authority**

Date Issued 12.12.86

**STOP NOTICES**

Date Served

Requiring

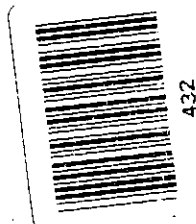

Date(s) served

12.12.86

Takes effect 23.1.87.

Compliance by 23.3.87

Dates Extended by  
Secretary of State

Date withdrawn

**REQUIREMENTS of ENFORCEMENT**

1 TO CHANGE THE USE OF THE LAND AND THE  
BUILDING THEREON FOR THE REPAIR AND  
STORAGE OF VEHICLES

2 TO REMOVE THE SAID VEHICLES

**EXTENT to WHICH NOTICE COMPLIED WITH (dates)**

**IMPORTANT -**  
**THIS COMMUNICATION AFFECTS**  
**YOUR PROPERTY**

District Secretary's Department,  
G. C. Betteridge, LL.B., (Solicitor),  
District Secretary



**North Wiltshire**  
**District Council**

Monkton Park,  
Chippenham,  
Wiltshire, SN15 1ER.  
Tel. Chippenham (0249) 654188.  
Ext. 132

Our ref **E 432**

Enquires to Mr McDonald

Your ref

12 December, 1986

Dear Sir/Madam,

**NORTH WILTSHIRE DISTRICT COUNCIL**  
**TOWN AND COUNTRY PLANNING ACT 1971 (as amended)**

**ENFORCEMENT NOTICE**

Oaklands Farm, Braydon, Wootton Bassett, Wiltshire.

The Council have issued an Enforcement Notice relating to the above land and I now serve on you a copy of that Notice, in view of your interest in the land. Unless an appeal is made to the Secretary of State as described below, the Notice will take effect on the date shown in the box below and you must then ensure that the required steps for which you may be held responsible are taken within the period or periods specified in the Notice.

If you wish to appeal against the Notice, you should first read carefully the enclosed booklet entitled "Enforcement Notice Appeals - A Guide to Procedure". Then, you or your agent should complete the enclosed appeal form and send it, together with the extra copy of the Enforcement Notice enclosed herewith to the address on the appeal form. Your appeal **MUST BE RECEIVED** by the Department of the Environment **BEFORE THE NOTICE TAKES EFFECT**.

There is a requirement on the Council to specify the reasons why the local planning authority consider it expedient to issue the Notice and these reasons are set out in the ANNEX overleaf.

Yours faithfully,

Assistant District Secretary

DATE ON WHICH NOTICE TAKES EFFECT  
AND BEFORE WHICH ANY APPEAL  
MUST BE RECEIVED 23 January 1987

To:

Mr. Alan Glead,  
Oaklands Farm,  
Braydon,  
Wootton Bassett,  
Wiltshire

ANNEX - (This does not form part of the Enforcement Notice)

Reason for Issue :-

1. The development, by virtue of the scale and design of the building and the nature of the use, is contrary to Policy Ell of the North East Wiltshire Structure Plan, which states that in the countryside the change of use of buildings to use for employment purposes will normally be permitted only where access and services are satisfactory, the scale and design of the buildings are compatible with the local environment and where the proposal will not detract from the amenities of the locality and the character of the countryside.
2. The present use of the building and the associated land is, by reason of noise and visual intrusion, damaging to the amenity which can reasonably be expected in this location.

NORTH WILTSHIRE DISTRICT COUNCIL  
TOWN AND COUNTRY PLANNING ACT 1971 (as amended)  
**ENFORCEMENT NOTICE**

Oaklands Farm, Braydon, Wootton Bassett, Wiltshire.

-----

WHEREAS :

- (1) It appears to the North Wiltshire District Council ("the Council"), being the local planning authority for the purposes of Section 87 of the Town and Country Planning Act 1971 ("the Act") in this matter, that there has been a breach of planning control after the end of 1963 on the land or premises ("the land") described in Schedule 1 below.
- (2) The breach of planning control which appears to have taken place consists in the carrying out of development by the making of the material change in the use of the land described in Schedule 2 below, without the grant of planning permission required for that development.
- (3) The Council consider it expedient, having regard to the provisions of the development plan and to all other material considerations, to issue this enforcement notice, in exercise of their powers contained in the said Section 87, for the reasons set out in the ANNEX to this Notice.

NOTICE IS HEREBY GIVEN that the Council require that the steps specified in Schedule 3 below be taken in order to remedy the breach within the period of two months from the date on which this Notice takes effect.

THIS NOTICE SHALL TAKE EFFECT, subject to the provisions of Section 88(10) of the Act, on 23 January 1987

-----

ISSUED 12 December 1986

-----

Signed

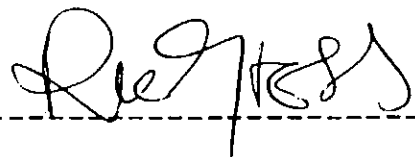

Monkton Park,  
Chippenham, SN15 1ER.

/ SCHEDULE 1 . . . . .

(over)

SCHEDULE 1 - LAND OR PREMISES TO WHICH THIS NOTICE RELATES

Land including an agricultural building thereon being part of Oaklands Farm, Braydon, Wootton Bassett, Wiltshire shown stipple-edged on the attached plan.

SCHEDULE 2 - ALLEGED BREACH OF PLANNING CONTROL

The material change in the use of the land from agricultural land to a use for that purpose and, in addition, the repair of haulage and other vehicles and the storage of such vehicles and office uses in connection with that business.

SCHEDULE 3 - STEPS REQUIRED TO BE TAKEN

- (i) To cease the use of the land and the building thereon for the repair and storage of vehicles.
- (ii) To remove the said vehicles

**E 432**

**NORTH WILTSHIRE DISTRICT COUNCIL  
TOWN AND COUNTRY PLANNING ACT 1971 (as amended)  
ENFORCEMENT NOTICE**

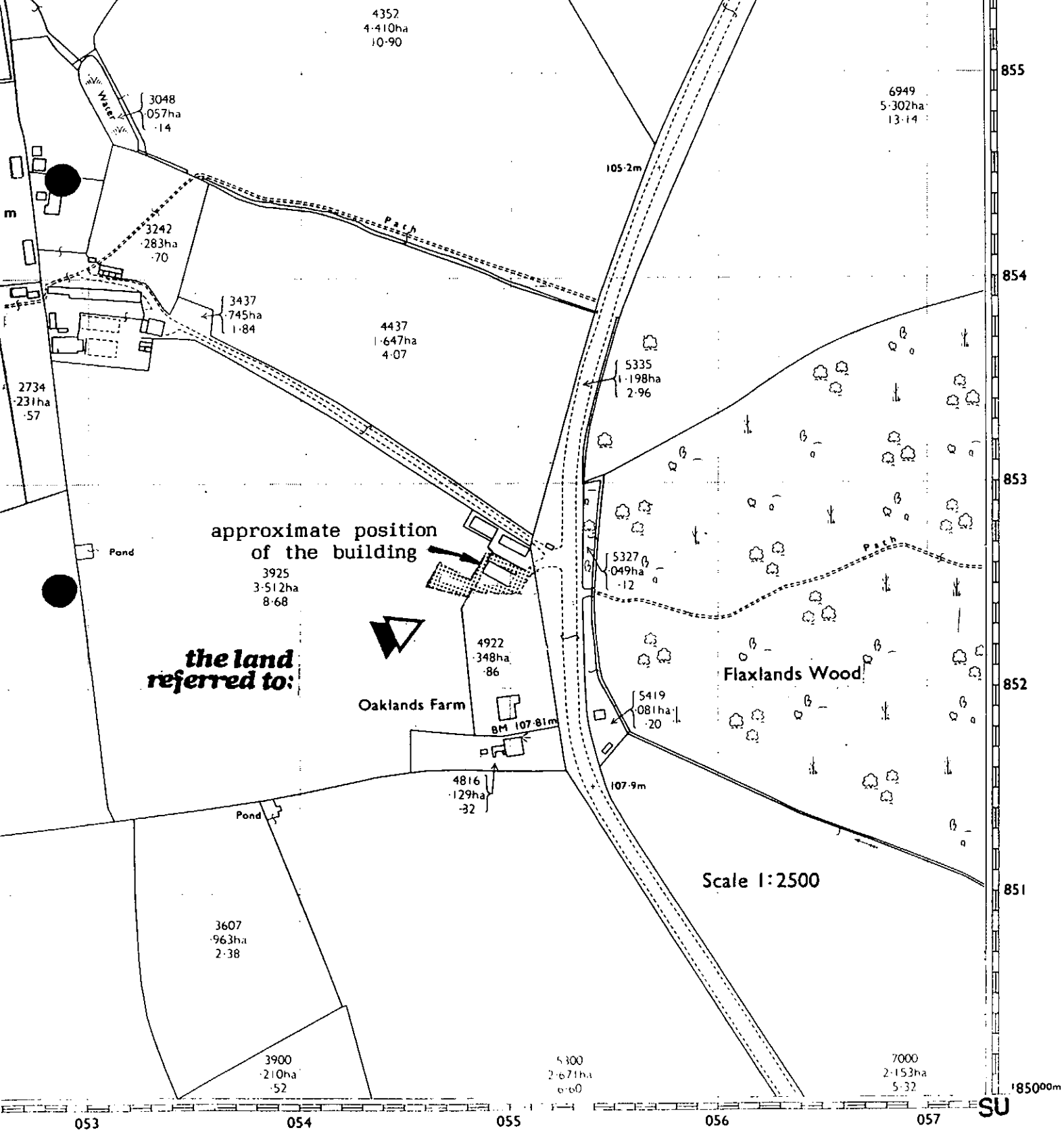

**IMPORTANT -**

**THIS COMMUNICATION AFFECTS  
YOUR PROPERTY**

District Secretary's Department,  
G. C. Betteridge, LL.B., (Solicitor),  
District Secretary



**North Wiltshire  
District Council**

Monkton Park,  
Chippenham,  
Wiltshire, SN15 1ER.  
Tel. Chippenham (0249) 654188.  
Ext. 132

Our ref **E 432**

Enquiries to Mr McDonald

Your ref

12 December, 1986

Dear Sir/Madam,

**NORTH WILTSHIRE DISTRICT COUNCIL  
TOWN AND COUNTRY PLANNING ACT 1971 (as amended)  
ENFORCEMENT NOTICE**

Oaklands Farm, Braydon, Wootton Bassett, Wiltshire.

The Council have issued an Enforcement Notice relating to the above land and I now serve on you a copy of that Notice, in view of your interest in the land. Unless an appeal is made to the Secretary of State as described below, the Notice will take effect on the date shown in the box below and you must then ensure that the required steps for which you may be held responsible are taken within the period or periods specified in the Notice.

If you wish to appeal against the Notice, you should first read carefully the enclosed booklet entitled "Enforcement Notice Appeals - A Guide to Procedure". Then, you or your agent should complete the enclosed appeal form and send it, together with the extra copy of the Enforcement Notice enclosed herewith to the address on the appeal form. Your appeal **MUST BE RECEIVED** by the Department of the Environment **BEFORE THE NOTICE TAKES EFFECT**.

There is a requirement on the Council to specify the reasons why the local planning authority consider it expedient to issue the Notice and these reasons are set out in the ANNEX overleaf.

Yours faithfully,

Assistant District Secretary

DATE ON WHICH NOTICE TAKES EFFECT  
AND BEFORE WHICH ANY APPEAL  
MUST BE RECEIVED 23 January 1987

To:

Mr. Alan Gleed,  
Oaklands Farm,  
Braydon,  
Wootton Bassett,  
Wiltshire

ANNEX - (This does not form part of the Enforcement Notice)

Reason for Issue :-

1. The development, by virtue of the scale and design of the building and the nature of the use, is contrary to Policy E11 of the North East Wiltshire Structure Plan, which states that in the countryside the change of use of buildings to use for employment purposes will normally be permitted only where access and services are satisfactory, the scale and design of the buildings are compatible with the local environment and where the proposal will not detract from the amenities of the locality and the character of the countryside.
2. The present use of the building and the associated land is, by reason of noise and visual intrusion, damaging to the amenity which can reasonably be expected in this location.



NORTH WILTSHIRE DISTRICT COUNCIL  
TOWN AND COUNTRY PLANNING ACT 1971 (as amended)  
**ENFORCEMENT NOTICE**

Oaklands Farm, Braydon, Wootton Bassett, Wiltshire.

-----

WHEREAS :

- (1) It appears to the North Wiltshire District Council ("the Council") being the local planning authority for the purposes of Section 87 of the Town and Country Planning Act 1971 ("the Act") in this matter, that there has been a breach of planning control after the end of 1963 on the land or premises ("the land") described in Schedule 1 below.
- (2) The breach of planning control which appears to have taken place consists in the carrying out of development by the making of the material change in the use of the land described in Schedule 2 below, without the grant of planning permission required for that development.
- (3) The Council consider it expedient, having regard to the provisions of the development plan and to all other material considerations, to issue this enforcement notice, in exercise of their powers contained in the said Section 87, for the reasons set out in the ANNEX to this Notice.

NOTICE IS HEREBY GIVEN that the Council require that the steps specified in Schedule 3 below be taken in order to remedy the breach within the period of two months-----  
from the date on which this Notice takes effect.

THIS NOTICE SHALL TAKE EFFECT, subject to the provisions of Section 88(10) of the Act, on 23 January 1987-----

ISSUED 12 December 1986-----

Signed

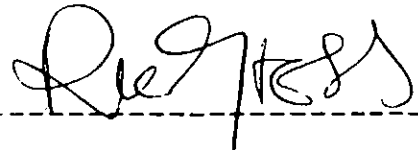

Monkton Park,  
Chippenham, SN15 1ER.

/ SCHEDULE 1 . . . . .

(over)

SCHEDULE 1 - LAND OR PREMISES TO WHICH THIS NOTICE RELATES

Land including an agricultural building thereon being part of Oaklands Farm, Braydon, Wootton Bassett, Wiltshire shown stipple-edged on the attached plan.

SCHEDULE 2 - ALLEGED BREACH OF PLANNING CONTROL

The material change in the use of the land from agricultural land to a use for that purpose and, in addition, the repair of haulage and other vehicles and the storage of such vehicles and office uses in connection with that business.

SCHEDULE 3 - STEPS REQUIRED TO BE TAKEN

- (i) To cease the use of the land and the building thereon for the repair and storage of vehicles.
- (ii) To remove the said vehicles

E 432

**NORTH WILTSHIRE DISTRICT COUNCIL**  
**TOWN AND COUNTRY PLANNING ACT 1971 (as amended)**  
**ENFORCEMENT NOTICE**

