

Bremhill

NORTH WILTSHIRE DISTRICT COUNCIL

ENFORCEMENT REGISTER INFORMATION SHEET

E/ 417.

APPEAL yes no

Plan's Ref

ADDRESS

BOSMARD FARM.
WASS TYTHARTON

BREACH of CONTROL

SNS SCHEDULE 2
ATTACHED.

Issuing Authority N.W.D.C.

Date Issued 7. 11. 84

STOP NOTICES

Date Served

Requiring

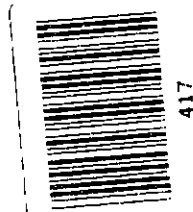

Date(s) served

7. 11. 84

Takes effect 7. 12. 84

Compliance by 7. 1. 85.

Dates Extended by
Secretary of State

Date withdrawn

REQUIREMENTS of ENFORCEMENT

SNS SCHEDULE 3. ATTACHED.

EXTENT to WHICH NOTICE COMPLIED WITH (dates)

IMPORTANT

R. Barton

**THIS COMMUNICATION AFFECTS
YOUR PROPERTY**

District Secretary's Department
D. F. Lewis
Solicitor to the Council



**North Wiltshire
District Council**

Monkton Park,
Chippenham,
Wiltshire, SN15 1ER.
Tel. Chippenham (0249) 654188.
Ext. 144

Our ref **E** 417

Enquires to Mrs. M. Nettleton

Dear Sir/Madam,

7th November, 1984

**NORTH WILTSHIRE DISTRICT COUNCIL
TOWN AND COUNTRY PLANNING ACT 1971 (as amended)
LISTED BUILDING
ENFORCEMENT NOTICE**

Bosmere Farm, West Tytherton

The Council have issued a Listed Building Enforcement Notice relating to the above property and I now serve on you a copy of that Notice, in view of your interest in the premises.

Unless an Appeal is made to the Secretary of State, as described below, the Notice will take effect on the date shown in the box below and you must then ensure that the required steps for which you may be held responsible are taken within the period or periods specified in the Notice.

If you wish to appeal against the Notice, you or your agent should write to the Secretary of State for the Environment, Room 903, Tollgate House, Houlton Street, Bristol, BS2 9DJ setting out the grounds of appeal and stating briefly the facts on which it is proposed to rely in support of each of those grounds. Extracts from the Act are copied on the accompanying papers and your attention is drawn in particular to the list of grounds of appeal at Section 97(1) (a) to (k). You should enclose with any appeal the extra copy sent herewith of the Notice. **ANY APPEAL MUST BE RECEIVED BY THE DEPARTMENT OF THE ENVIRONMENT BEFORE THE NOTICE TAKES EFFECT.**

The reasons why the local planning authority consider it expedient to issue the Notice are briefly set out in the ANNEX overleaf.

Yours faithfully,

D. F. Lewis
Solicitor

**DATE ON WHICH NOTICE TAKES EFFECT and BEFORE WHICH
ANY APPEAL MUST BE RECEIVED - 6th December 1984**

To:

D.G. Hudd Building Contractors
Box Farm,
Heddington,
Calne.

The Company Secretary
Arlington Temple Exporters Ltd.
63 Ballards Lane,
London.

Mr. D. Hilmi
Bosmere Farm,
West Tytherton,
Chippenham

The Company Secretary,
Bosmere Farm Limited
West Tytherton,
Chippenham.

ANNEX - (This does not form part of the Listed Building Enforcement Notice)

Reasons for Issue:-

1. *The works undertaken are considered unsympathetic and detrimental to the appearance and character of the building which is listed by the Department of the Environment as being of special architectural or historic interest.*

NORTH WILTSHIRE DISTRICT COUNCIL

TOWN AND COUNTRY PLANNING ACT 1971 (as amended)

LISTED BUILDING
ENFORCEMENT NOTICE

Bosmere Farm House, West Tytherton

WHEREAS :

- (1) It appears to the North Wiltshire District Council ("the Council") being the local planning authority for the purposes of Section 96 of the Town and Country Planning Act 1971 ("the Act") in this matter, that works have been / ~~are being~~ executed to the listed building in their area described in Schedule 1 below such as to involve a contravention of Section 55 of the Act.
- (2) The contravention which appears to have taken place is described in Schedule 2 below.
- (3) The Council consider it expedient, having regard to the effect of the said works on the character of the listed building as one of special architectural or historic interest and to all other material considerations, to issue this listed building enforcement notice, in exercise of their powers contained in the said Section 96, for the reasons set out in the ANNEX to this Notice.

NOTICE IS HEREBY GIVEN that the Council require that the steps specified in Schedule 3 below be taken for the purposes set out in that Schedule within the period of one month from the date on which this Notice takes effect.

THIS NOTICE SHALL TAKE EFFECT, subject to the provisions of Section 97 of the Act, on 7th December, 1984

ISSUED 7th November 1984

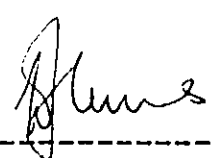
Signed 

Monkton Park,
Chippenham, SN15 1ER

/ SCHEDULE 1
(over)

SCHEDULE 1 - LISTED BUILDING TO WHICH THIS ENFORCEMENT NOTICE RELATES

The early C18th Grade II Listed Building known as Bosmere Farmhouse situate at Bosmere Farm, West Tytherton, Pewsham and shown coloured red on the attached plan.

SCHEDULE 2 - THE CONTRAVENTION

The contravention comprises of

1. The demolition of two lean-to extensions to the rear south eastern and southern elevation of the main building.
2. The rebuilding of the rear south eastern lean-to extension to the main building with an extension of similar size and the commencement of building works to the rear southern corner of the main building with an extension of a greater size.
3. The demolition and rebuilding of the gable chimney stack to the rear south eastern elevation of the main building.
4. The installation of a stairway leading to the roof space.
5. The removal of three windows and frames to the rear, first floor, south and south eastern elevation and their replacement with reconstituted stone mullion surrounds.
6. The removal and renewal of the timber roof structure.

SCHEDULE 3 - STEPS REQUIRED TO BE TAKEN FOR THE PURPOSE OF ALLEVIATING THE EFFECT OF THE WORKS WHICH HAVE BEEN CARRIED OUT WITHOUT LISTED BUILDING CONSENT.

1. The complete demolition to foundation level of the rear gable extension to the south east elevation of the main building.
2. The complete demolition to foundation level of the partially erected extension to the rear southern corner of the main building.
3. To rebuild the former single storey lean-to rear extensions to the south-east and south elevations of the main building. All exterior masonry walling shall be grey to buff coloured Cotswold rubble limestone laid to horizontal courses in a lime mortar and bag jointed in the traditional manner. Outer corners shall be constructed in natural stone ashlar long and short flush quoins.

The roof shall be constructed at a 42° - 47° pitch, sprocketed and covered in sound natural Cotswold stone slates laid to regularly diminishing courses from eaves to ridge to present unbroken horizontal lines. Eaves and verge details to be plain with no fascia or barge boards.

All window openings shall be traditional 2 and 3 light timber casements with single bisecting horizontal glazing bar set in timber frames. Doors shall be plain boarded ledged and braced.

4. The complete demolition to ground level of the gable chimney stack to the south east rear gable elevation. The reinstatement of the aforementioned stack in natural stone ashlar block with a moulded cap. Stonework to be bedded and fine jointed in the traditional manner.
5. The removal of one reconstituted stone mullion window surround to the first floor south-east rear gable elevation. The removal of two reconstituted stone mullion window surrounds to the first floor south elevations. The replacement of the aforementioned with traditional 2 and 3 light timber casement windows with single bisecting horizontal glazing bar set in timber frames.

E417

NORTH WILTSHIRE DISTRICT COUNCIL
TOWN AND COUNTRY PLANNING ACT 1971 (as amended)

LISTED BUILDING ENFORCEMENT NOTICE

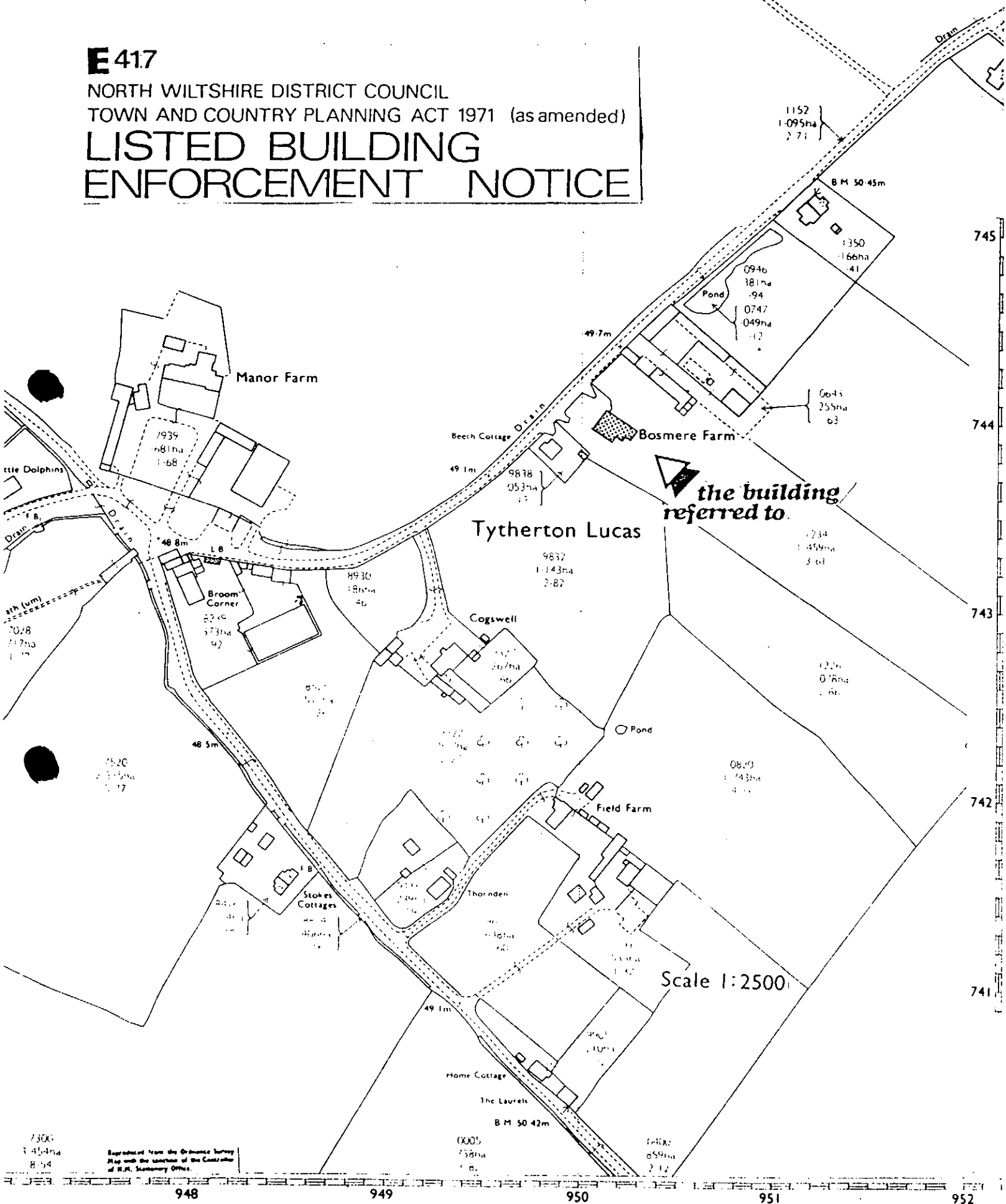

IMPORTANT
THIS COMMUNICATION AFFECTS
YOUR PROPERTY

District Secretary's Department
D. F. Lewis
Solicitor to the Council



**North Wiltshire
District Council**

Monkton Park,
Chippenham,
Wiltshire, SN15 1ER.
Tel. Chippenham (0249) 654188.
Ext. 144

R BURTON
417

Our ref **E** 417

Enquiries to Mrs. M. Nettleton

Dear Sir/Madam,

7th November, 1984

**NORTH WILTSHIRE DISTRICT COUNCIL
TOWN AND COUNTRY PLANNING ACT 1971 (as amended)
LISTED BUILDING
ENFORCEMENT NOTICE**

Bosmere Farm, West Tytherton

The Council have issued a Listed Building Enforcement Notice relating to the above property and I now serve on you a copy of that Notice, in view of your interest in the premises.

Unless an Appeal is made to the Secretary of State, as described below, the Notice will take effect on the date shown in the box below and you must then ensure that the required steps for which you may be held responsible are taken within the period or periods specified in the Notice.

If you wish to appeal against the Notice, you or your agent should write to the Secretary of State for the Environment, Room 903, Tollgate House, Houlton Street, Bristol, BS2 9DJ setting out the grounds of appeal and stating briefly the facts on which it is proposed to rely in support of each of those grounds. Extracts from the Act are copied on the accompanying papers and your attention is drawn in particular to the list of grounds of appeal at Section 97(1) (a) to (k). You should enclose with any appeal the extra copy sent herewith of the Notice. **ANY APPEAL MUST BE RECEIVED BY THE DEPARTMENT OF THE ENVIRONMENT BEFORE THE NOTICE TAKES EFFECT.**

The reasons why the local planning authority consider it expedient to issue the Notice are briefly set out in the ANNEX overleaf.

Yours faithfully,

D. F. Lewis
Solicitor

**DATE ON WHICH NOTICE TAKES EFFECT and BEFORE WHICH
ANY APPEAL MUST BE RECEIVED - 6th December 1984**

To:

D.G. Hudd Building Contractors
Box Farm,
Heddington,
Calne.

The Company Secretary
Arlington Temple Exporters Ltd.
63 Ballards Lane,
London.

Mr. D. Hilmi
Bosmere Farm,
West Tytherton,
Chippenham

The Company Secretary,
Bosmere Farm Limited
West Tytherton,
Chippenham.

ANNEX - (This does not form part of the Listed Building Enforcement Notice)

Reasons for Issue:-

1. *The works undertaken are considered unsympathetic and detrimental to the appearance and character of the building which is listed by the Department of the Environment as being of special architectural or historic interest.*

NORTH WILTSHIRE DISTRICT COUNCIL TOWN AND COUNTRY PLANNING ACT 1971 (as amended) LISTED BUILDING ENFORCEMENT NOTICE

Bosmere Farm House, West Tytherton

WHEREAS :

- (1) It appears to the North Wiltshire District Council ("the Council") being the local planning authority for the purposes of Section 96 of the Town and Country Planning Act 1971 ("the Act") in this matter, that works have been / ~~are being~~ executed to the listed building in their area described in Schedule 1 below such as to involve a contravention of Section 55 of the Act.
- (2) The contravention which appears to have taken place is described in Schedule 2 below.
- (3) The Council consider it expedient, having regard to the effect of the said works on the character of the listed building as one of special architectural or historic interest and to all other material considerations, to issue this listed building enforcement notice, in exercise of their powers contained in the said Section 96, for the reasons set out in the ANNEX to this Notice.

NOTICE IS HEREBY GIVEN that the Council require that the steps specified in Schedule 3 below be taken for the purposes set out in that Schedule within the period of one month from the date on which this Notice takes effect.

THIS NOTICE SHALL TAKE EFFECT, subject to the provisions of Section 97 of the Act, on 7th December, 1984

ISSUED 7th November 1984

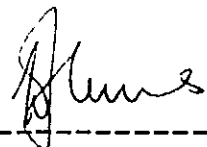
Signed 

Monkton Park,
Chippenham, SN15 1ER

/ SCHEDULE 1
(over)

SCHEDULE 1 - LISTED BUILDING TO WHICH THIS ENFORCEMENT NOTICE RELATES

The early C18th Grade II Listed Building known as Bosmere Farmhouse situate at Bosmere Farm, West Tytherton, Pewsham and shown coloured red on the attached plan.

SCHEDULE 2 - THE CONTRAVENTION

The contravention comprises of

1. The demolition of two lean-to extensions to the rear south eastern and southern elevation of the main building.
2. The rebuilding of the rear south eastern lean-to extension to the main building with an extension of similar size and the commencement of building works to the rear southern corner of the main building with an extension of a greater size.
3. The demolition and rebuilding of the gable chimney stack to the rear south eastern elevation of the main building.
4. The installation of a stairway leading to the roof space.
5. The removal of three windows and frames to the rear, first floor, south and south eastern elevation and their replacement with reconstituted stone mullion surrounds.
6. The removal and renewal of the timber roof structure.

SCHEDULE 3 - STEPS REQUIRED TO BE TAKEN FOR THE PURPOSE OF ALLEVIATING THE EFFECT OF THE WORKS WHICH HAVE BEEN CARRIED OUT WITHOUT LISTED BUILDING CONSENT.

1. The complete demolition to foundation level of the rear gable extension to the south east elevation of the main building.
2. The complete demolition to foundation level of the partially erected extension to the rear southern corner of the main building.
3. To rebuild the former single storey lean-to rear extensions to the south-east and south elevations of the main building. All exterior masonry walling shall be grey to buff coloured Cotswold rubble limestone laid to horizontal courses in a lime mortar and bag jointed in the traditional manner. Outer corners shall be constructed in natural stone ashlar long and short flush quoins.

The roof shall be constructed at a 42° - 47° pitch, sprocketed and covered in sound natural Cotswold stone slates laid to regularly diminishing courses from eaves to ridge to present unbroken horizontal lines. Eaves and verge details to be plain with no fascia or barge boards.

All window openings shall be traditional 2 and 3 light timber casements with single bisecting horizontal glazing bar set in timber frames. Doors shall be plain boarded ledged and braced.

4. The complete demolition to ground level of the gable chimney stack to the south east rear gable elevation. The reinstatement of the aforementioned stack in natural stone ashlar block with a moulded cap. Stonework to be bedded and fine jointed in the traditional manner.
5. The removal of one reconstituted stone mullion window surround to the first floor south-east rear gable elevation. The removal of two reconstituted stone mullion window surrounds to the first floor south elevations. The replacement of the aforementioned with traditional 2 and 3 light timber casement windows with single bisecting horizontal glazing bar set in timber frames.

E417

NORTH WILTSHIRE DISTRICT COUNCIL
TOWN AND COUNTRY PLANNING ACT 1971 (as amended)

LISTED BUILDING ENFORCEMENT NOTICE

