

# ENFORCEMENT REGISTER INFORMATION SHEET

E/396 C.

APPEAL

yes

no

Plan's Ref

## ADDRESS

LAND AT THE STREET.

LYDIARD MILLCOTT.

## BREACH of CONTROL

THE MAKING OF A MATERIAL CHANGE  
IN THE USE OF THE LAND FROM  
USE FOR THE PURPOSE OF AGRICULTURE  
TO USE FOR THAT PURPOSE AND,  
IN ADDITION, FOR THE STORAGE  
OF BUILDER'S MATERIALS AND PLANTS

Issuing Authority N W D C

Date Issued 4.7.84

## STOP NOTICES

Date Served

Requiring



Date(s) served

4.7.84

Takes effect 10.8.84

Compliance by 10.2.85

Dates Extended by  
Secretary of State

Date withdrawn

## REQUIREMENTS of ENFORCEMENT

1 TO CEASE THE USE OF THE LAND FOR STORAGE  
OTHER THAN AGRICULTURAL STORAGE.

2 TO REMOVE FROM THE LAND THE SAID  
BUILDER'S MATERIALS AND PLANTS.

EXTENT to WHICH NOTICE COMPLIED WITH (dates)

**IMPORTANT**  
THIS COMMUNICATION AFFECTS  
YOUR PROPERTY

District Secretary's Department  
D. F. Lewis  
Solicitor to the Council



**North Wiltshire  
District Council**

Monkton Park,  
Chippenham,  
Wiltshire, SN15 1ER.  
Tel. Chippenham (0249) 654188.  
Ext. 132

Our ref **E** 396 C Enquiries to Mr. McDonald

Dear Sir/Madam,

4th July, 1984

**NORTH WILTSHIRE DISTRICT COUNCIL  
TOWN AND COUNTRY PLANNING ACT 1971 (as amended)  
ENFORCEMENT NOTICE**

**LAND AT THE STREET, LYDIARD MILLICENT**

The Council have issued an Enforcement Notice relating to the above land and I now serve on you a copy of that Notice, in view of your interest in the land.

Unless an appeal is made to the Secretary of State, as described below, the Notice will take effect on the date shown in the box below and you must then ensure that the required steps for which you may be held responsible are taken within the period or periods specified in the Notice.

If you wish to appeal against the Notice, you should first read carefully the enclosed booklet entitled "Enforcement Notice Appeals - A Guide to Procedure". Then, you or your agent should complete the enclosed appeal form and send it, together with the extra copy of the Enforcement Notice enclosed herewith and the fee specified in the box below, to the address on the appeal form. Your appeal must be received by the Department of the Environment BEFORE the Notice takes effect.

There is a requirement on the Council to specify the reasons why the local planning authority consider it expedient to issue the Notice and these reasons are set out in the ANNEX overleaf.

Yours faithfully,

  
Solicitor

DATE ON WHICH NOTICE TAKES EFFECT and  
BEFORE WHICH ANY APPEAL MUST BE  
RECEIVED - 10th August, 1984

FEE WHICH MUST ACCOMPANY  
APPEAL - £47.

To:

Mr. D. Bailey,  
186 Moredon Road,  
Moredon,  
Swindon,  
Wilts.

ANNEX - (This does not form part of the Enforcement Notice)

REASONS FOR ISSUE:-

1. The development introduces a use of commercial nature into an area where it is the policy of the local planning authority that existing uses should remain for the most part undisturbed and only development essential to agricultural need should normally be permitted.
2. The development conflicts with the provisions of the Cricklade and Purton District Plan.
3. The development, by reason of activities together with associated traffic movements to and from the site is seriously detrimental to the amenities and environment of nearby residential properties.
4. The development has a detrimental effect on the pleasant character and appearance of this area of Lydiard Millicent and visual amenity in general. If permitted the development would set a precedent for further similar incursions into the countryside to the increasing detriment of the village and the surrounding rural area.

NORTH WILTSHIRE DISTRICT COUNCIL  
TOWN AND COUNTRY PLANNING ACT 1971 (as amended)  
**ENFORCEMENT NOTICE**

LAND AT THE STREET, LYDIARD MILLICENT.

WHEREAS :

- (1) It appears to the North Wiltshire District Council ("the Council") being the local planning authority for the purposes of Section 87 of the Town and Country Planning Act 1971 ("the Act") in this matter, that there has been a breach of planning control after the end of 1963 on the land or premises ("the land") described in Schedule 1 below.
- (2) The breach of planning control which appears to have taken place consists in the carrying out of development by the making of the material change in the use of the land described in Schedule 2 below, without the grant of planning permission required for that development.
- (3) The Council consider it expedient, having regard to the provisions of the development plan and to all other material considerations, to issue this enforcement notice, in exercise of their powers contained in the said Section 87, for the reasons set out in the ANNEX to this Notice.

NOTICE IS HEREBY GIVEN that the Council require that the steps specified in Schedule 3 below be taken in order to remedy the breach within the period of six months from the date on which this Notice takes effect.

THIS NOTICE SHALL TAKE EFFECT, subject to the provisions of Section 88(10) of the Act, on 10th August, 1984

ISSUED 4th July, 1984

Signed

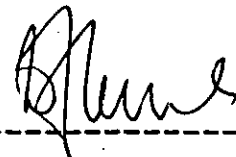

Monkton Park,  
Chippenham, SN15 1ER.

/ SCHEDULE 1 . . . . .

(over)

SCHEDULE 1 - Land or premises to which this Notice relates

Land identified as Ordnance Survey parcels 4988 (part), 4879 and 4375  
Lydiard Millicent, Swindon, Wiltshire shown edged red on the attached plan.

SCHEDULE 2 - Alleged breach of planning control

The making of a material change in the use of the land from use for the  
purpose of agriculture to use for that purpose and, in addition, for  
the storage of builders' materials and plant.

SCHEDULE 3 - Steps required to be taken

1. To cease the use of the land for storage other than agricultural  
storage.
2. To remove from the land the said builders' materials and plant.

8057  
6564  
142

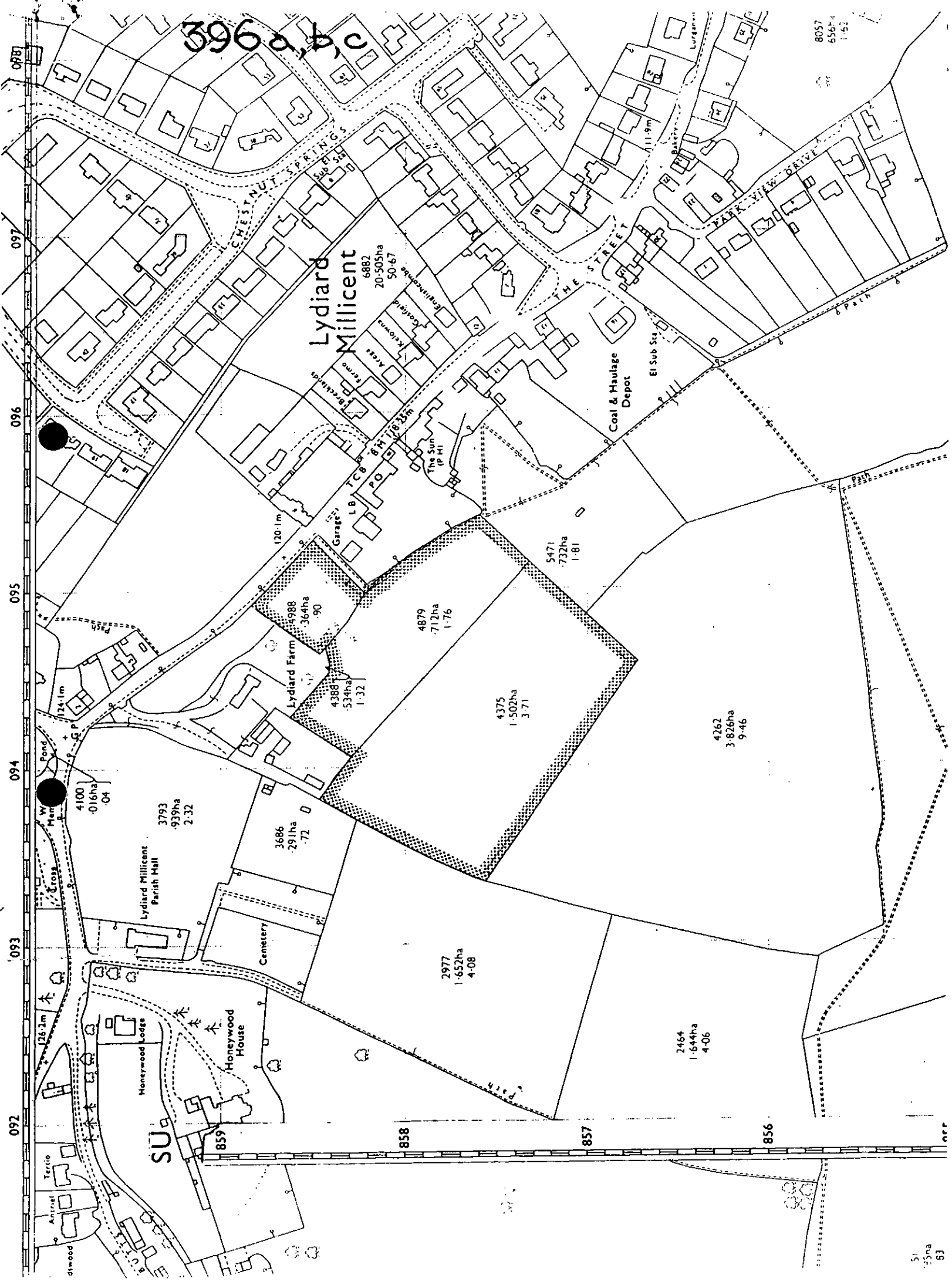

**IMPORTANT**

**THIS COMMUNICATION AFFECTS  
YOUR PROPERTY**

District Secretary's Department  
D. F. Lewis  
Solicitor to the Council



**North Wiltshire  
District Council**

Monkton Park,  
Chippenham,  
Wiltshire, SN15 1ER.  
Tel. Chippenham (0249) 654188.  
Ext. 132

Our ref **E** 396 C Enquiries to Mr. McDonald

Dear Sir/Madam,

4th July, 1984

**NORTH WILTSHIRE DISTRICT COUNCIL  
TOWN AND COUNTRY PLANNING ACT 1971 (as amended)  
ENFORCEMENT NOTICE**

**LAND AT THE STREET, LYDIARD MILLICENT**

The Council have issued an Enforcement Notice relating to the above land and I now serve on you a copy of that Notice, in view of your interest in the land.

Unless an appeal is made to the Secretary of State, as described below, the Notice will take effect on the date shown in the box below and you must then ensure that the required steps for which you may be held responsible are taken within the period or periods specified in the Notice.

If you wish to appeal against the Notice, you should first read carefully the enclosed booklet entitled "Enforcement Notice Appeals - A Guide to Procedure". Then, you or your agent should complete the enclosed appeal form and send it, together with the extra copy of the Enforcement Notice enclosed herewith and the fee specified in the box below, to the address on the appeal form. Your appeal must be received by the Department of the Environment BEFORE the Notice takes effect.

There is a requirement on the Council to specify the reasons why the local planning authority consider it expedient to issue the Notice and these reasons are set out in the ANNEX overleaf.

Yours faithfully,

  
Solicitor

DATE ON WHICH NOTICE TAKES EFFECT and  
BEFORE WHICH ANY APPEAL MUST BE  
RECEIVED - 10th August, 1984

FEE WHICH MUST ACCOMPANY  
APPEAL - £47.

To:

Mr. D. Bailey,  
186 Moredon Road,  
Moredon,  
Swindon,  
Wilts.

ANNEX - (This does not form part of the Enforcement Notice)

REASONS FOR ISSUE:-

1. The development introduces a use of commercial nature into an area where it is the policy of the local planning authority that existing uses should remain for the most part undisturbed and only development essential to agricultural need should normally be permitted.
2. The development conflicts with the provisions of the Cricklade and Purton District Plan.
3. The development, by reason of activities together with associated traffic movements to and from the site is seriously detrimental to the amenities and environment of nearby residential properties.
4. The development has a detrimental effect on the pleasant character and appearance of this area of Lydiard Millicent and visual amenity in general. If permitted the development would set a precedent for further similar incursions into the countryside to the increasing detriment of the village and the surrounding rural area.



# NORTH WILTSHIRE DISTRICT COUNCIL TOWN AND COUNTRY PLANNING ACT 1971 (as amended) ENFORCEMENT NOTICE

LAND AT THE STREET, LYDIARD MILLICENT.

WHEREAS :

- (1) It appears to the North Wiltshire District Council ("the Council") being the local planning authority for the purposes of Section 87 of the Town and Country Planning Act 1971 ("the Act") in this matter, that there has been a breach of planning control after the end of 1963 on the land or premises ("the land") described in Schedule 1 below.
- (2) The breach of planning control which appears to have taken place consists in the carrying out of development by the making of the material change in the use of the land described in Schedule 2 below, without the grant of planning permission required for that development.
- (3) The Council consider it expedient, having regard to the provisions of the development plan and to all other material considerations, to issue this enforcement notice, in exercise of their powers contained in the said Section 87, for the reasons set out in the ANNEX to this Notice.

NOTICE IS HEREBY GIVEN that the Council require that the steps specified in Schedule 3 below be taken in order to remedy the breach within the period of six months from the date on which this Notice takes effect.

THIS NOTICE SHALL TAKE EFFECT, subject to the provisions of Section 88(10) of the Act, on 10th August, 1984

ISSUED 4th July, 1984

Signed

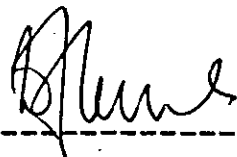

Monkton Park,  
Chippenham, SN15 1ER.

/ SCHEDULE 1 . . . . .

(over)

SCHEDULE 1 - Land or premises to which this Notice relates

Land identified as Ordnance Survey parcels 4988 (part), 4879 and 4375  
Lydiard Millicent, Swindon, Wiltshire shown edged red on the attached plan.

SCHEDULE 2 - Alleged breach of planning control

The making of a material change in the use of the land from use for the  
purpose of agriculture to use for that purpose and, in addition, for  
the storage of builders' materials and plant.

SCHEDULE 3 - Steps required to be taken

1. To cease the use of the land for storage other than agricultural  
storage.
2. To remove from the land the said builders' materials and plant.

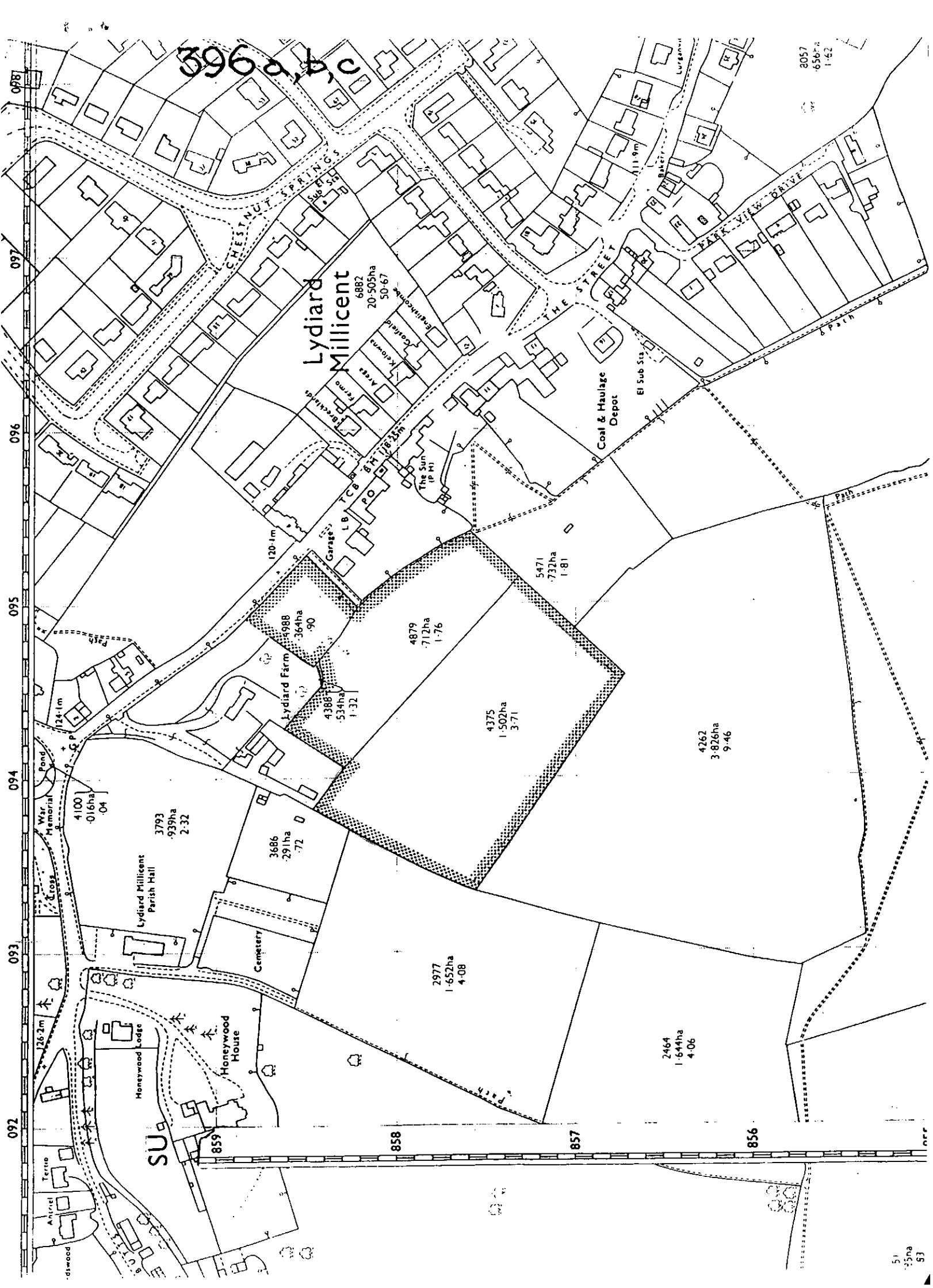

396 a, b, c

Lydiard Millicent

6882  
20.505ha  
50.67

Lydiard Farm

4988  
3.64ha  
9.0

Lydiard Millicent Parish Hall

3793  
9.39ha  
2.32

Cemetery

3686  
2.91ha  
7.2

Honeywood Lodge

859

Honeywood House

Coal & Haulage Depot

4879  
7.12ha  
1.76

4375  
1.502ha  
3.71

4262  
3.826ha  
9.46

2464  
1.644ha  
4.06

2977  
1.652ha  
4.08

5471  
7.32ha  
1.81

8057  
6.56ha  
1.42