

NORTH WILTSHIRE DISTRICT COUNCIL

ENFORCEMENT REGISTER INFORMATION SHEET

E/ 333.		
APPEAL	yes	no
Plan's Ref		

ADDRESS

CALNS TOWN FOOTBALL CLUB
BREMILL VIEW
CALNS.

BREACH of CONTROL

Issuing Authority *N.W.D.C.*

Date Issued *16.2.83*

STOP NOTICES

Date Served

Date(s) served

16.2.83.

Requiring

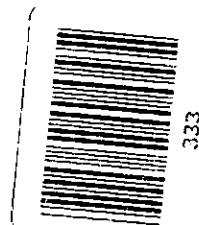

Takes effect *30.3.83.*

Compliance by *AS*
SCM 24.3

Dates Extended by
Secretary of State

Date withdrawn

REQUIREMENTS of ENFORCEMENT

Steps required to be taken

1. To submit to the Council for approval within one month, on a 1:500 block plan, detailed proposals for landscaping incorporating the planting of such suitable locally indigenous species of trees and hedging plants to the north east and south east of the clubhouse as will be sufficient to give the appearance of a naturally occurring screen.
2. After approval of the said proposals for landscaping referred to in paragraph 1 above by the Council to secure their implementation within one month of the first available planting season thereafter and maintain the same for a period of not less than five years. Any tree or hedging plant which dies within that period shall be replaced within one month of the first available planting season following the said plants demise and thereafter be maintained for a further period of five years.

EXTENDED to 9.5.83
SON HMO 24.3.83
REFUS 16.2

Alleged breach of planning control

2A. The Condition which has not been complied with

Condition No. 1.

Prior to the commencement of any works on site a landscaping scheme shall be submitted to and approved by the local planning authority. The approved scheme shall be implemented in the first available planting season following completion of the building works and shall be maintained thereafter for a period of not less than five years. Any tree or shrub which dies within that period shall be replaced to the satisfaction of the local planning authority and maintained for a further period of five years.

2B Alleged Breach of Condition

Condition No. 1 set out above has not been complied with in that works on site commenced on the 23rd April 1982 without a landscaping scheme first having been submitted to and approved by the local planning authority.

NORTH WILTSHIRE DISTRICT COUNCIL

ENFORCEMENT

OFFICER

TOWN AND COUNTRY PLANNING ACT 1971 (as amended)

ENFORCEMENT NOTICE

Calne Town Football Club Ground, Bremhill View, Calne.

WHEREAS:

- (1) It appears to the North Wiltshire District Council ("the Council") being the local planning authority for the purposes of Section 87 of the Town and Country Planning Act 1971 ("the Act") in this matter that there has been a breach of planning control within the period of four weeks before the day of issue of this notice on the land or premises (hereinafter referred to as "the land") described in Schedule 1 below.
- (2) The breach of planning control which appears to have taken place consists in the failure to comply with the conditions set out in Schedule 2A below relating to the development of the land subject to which planning permission No. N/81/1936/F was granted on the 25th January 1981 in the respect set out in schedule 2B below.
- (3) The Council consider it expedient, having regard to the provisions of the development plan and to all other material considerations, to issue this enforcement notice, in exercise of their powers contained in the said section for the reasons set out in the annex to this notice.

NOTICE IS HEREBY GIVEN that the Council require that the steps specified in Schedule 3 below be taken in order to remedy the breach within the period specified in respect of each step in that Schedule.

THIS NOTICE SHALL TAKE EFFECT, subject to the provisions of section 88(10) of the Act, on the 30th March, 1983.

Issued 16th February, 1983.

Signed

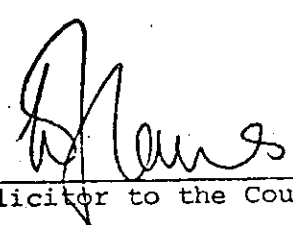
Solicitor to the Council.

North Wiltshire District Council,
Monkton Park,
Chippenham,
Wiltshire.

For E J L
for Register

PL	24/2
RB.	
24 FEB 1983	

Schedule 1

Land or premises to which this notice relates

The land situate at Grid Reference St. 993 719 and known as Calne Town Football Club Ground, Bremhill View, Calne in the County of Wiltshire which is more particularly delineated on the plan attached hereto and thereon edged red.

Schedule 2

Alleged breach of planning control

2A. The Condition which has not been complied with

Condition No. 1.

Prior to the commencement of any works on site a landscaping scheme shall be submitted to and approved by the local planning authority. The approved scheme shall be implemented in the first available planting season following completion of the building works and shall be maintained thereafter for a period of not less than five years. Any tree or shrub which dies within that period shall be replaced to the satisfaction of the local planning authority and maintained for a further period of five years.

2B Alleged Breach of Condition

Condition No. 1 set out above has not been complied with in that works on site commenced on the 23rd April 1982 without a landscaping scheme first having been submitted to and approved by the local planning authority.

Schedule 3

Steps required to be taken

1. To submit to the Council for approval within one month, on a 1:500 block plan, detailed proposals for landscaping incorporating the planting of such suitable locally indigenous species of trees and hedging plants to the north east and south east of the clubhouse as will be sufficient to give the appearance of a naturally occurring screen.
2. After approval of the said proposals for landscaping referred to in paragraph 1 above by the Council to secure their implementation within one month of the first available planting season thereafter and maintain the same for a period of not less than five years. Any tree or hedging plant which dies within that period shall be replaced within one month of the first available planting season following the said plants demise and thereafter be maintained for a further period of five years.

EXTENDED TO 9.5.83
H

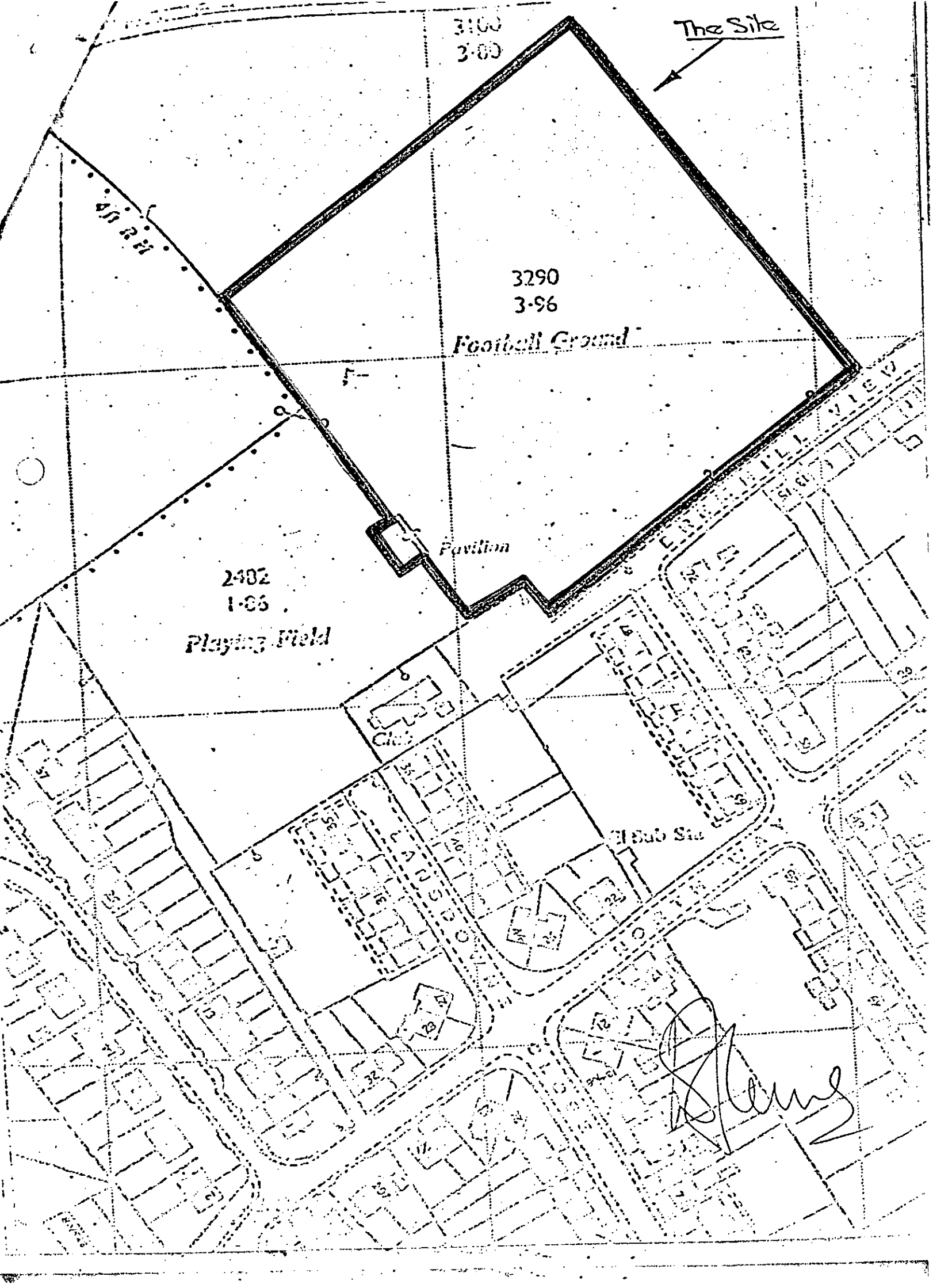

3100
3-00

The Site

3290
3-96

Football Ground

Pavilion

2402
1-06

Playing Field

15th St

[Handwritten Signature]

THE ANNEX

(NOTE: This does not form part of the Enforcement Notice)

STATEMENT OF REASONS

Without adequate planting to aid the integration of the development and thereby reduce its visual impact in this prominent open situation the development is detrimental to the visual amenity of the area.