

NORTH WILTSHIRE DISTRICT COUNCIL

INTERNAL MEMORANDUM

From SOLICITOR Date 29th May, 1981
To CHIEF PLANNING OFFICER Ourref: MMN/NK/E249

Re: "High View", Stonehill, Charlton, Nr. Malmesbury

Further to your memorandum of the 2nd April, 1981, I attach for your information copies of the Enforcement Notices which have been served in connection with the above mentioned matter.

Solicitor

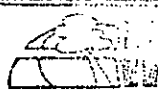

249

 PLANNING DEPARTMENT No 40422	TO	DATE
	DA	1/6
	CAW	
- 1 JUN 1981		

NORTH WILTSHIRE DISTRICT COUNCIL
TOWN AND COUNTRY PLANNING ACT 1971
ENFORCEMENT NOTICE

C. Waller

To: Mr. John Frederick Halford,
Highview,
Stonehill,
Charlton, Nr. Malmesbury, Wiltshire

The North Wiltshire District Council (hereinafter called "the Council") being the local planning authority for the purposes of Section 87 of the Town and Country Planning Act 1971 in this matter HEREBY GIVE YOU NOTICE as a person **occupying** the land described in Schedule 1 hereto (hereinafter referred to as "the said land") that:-

1. (i) On the first day of January, 1973 outline planning permission numbered 72/UC/362/0 was granted under Part III of the Town and Country Planning Act 1971 for the construction of two agricultural dwellings on land forming part of parcel 270 (Wilts. O.S. Sheet IX.9 1923) at Stonehill, Charlton, near Malmesbury in the County of Wiltshire subject to the following condition among others
"The occupation of the dwellings shall be limited to persons employed or last employed wholly or mainly locally in agriculture as defined in Section 290(1) of the Town and Country Planning Act 1971 or a dependant of such a person residing with him (but including a widow or widower of such a person)"
 - (ii) It appears to the Council that within a period of four years before the date of service of this notice there has been a breach of planning control in that the condition recited above has not been complied with in the respect set out in Schedule 2 hereto
2. The Council in pursuance of the powers contained in the said Section 87 and considering it expedient to do so, having regard to the provisions of the development plan and to all other material considerations, HEREBY REQUIRE you within nine months of the date when this notice takes effect to take the following steps to remedy the said breach of planning control namely:-
To secure the discontinuance of the occupation of the said dwellinghouse by persons being neither wholly nor mainly employed or last employed locally in agriculture as defined by Section 290(1) of the Town and Country Planning Act 1971 or a dependant or widow or widower of such a person

THIS NOTICE SHALL TAKE EFFECT subject to the provisions of Section 88(3) of the Town and Country Planning Act 1971 at the end of the period of twenty eight days beginning with the 8th day of June, 1981

The land forming part of parcel 270 (^{SCHEDULE 1} Wilts O.S. Sheet IX.9 1923) and now known together with the dwellinghouse now constructed thereon as "High View" Stonehill Charlton near Malmesbury in the County of Wiltshire which is more particularly delineated on the attached plan and thereon edged black

The occupation of the said dwelling is by ^{SCHEDULE 2} persons who are neither wholly nor mainly employed or last employed locally in agriculture as defined in Section 290(1) of the Town and Country Planning Act 1971 or the dependant or widow or widower of such a person contrary to the said condition

DATED this

29th

day of

May

1981

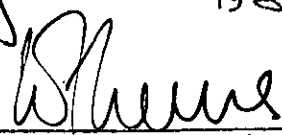
Solicitor to the Council

North Wiltshire District Council,
Monkton Park, Chippenham, Wilts.
(the address to which all communications
should be sent)

YOUR ATTENTION IS DIRECTED TO THE ATTACHED NOTES WHICH EXPLAIN
YOUR RIGHT OF APPEAL AGAINST THIS NOTICE. YOU SHOULD READ THEM CAREFULLY.

The Site

315
9.619

278
3.793

317
5.703

277
4.673

280
.909

278
.700

Cock Root Farm

281
10.783

275
7.999

270
11.003

282
4.271

273
5.736

274
.481

289
.446

288
.887

287
.953

286
4.930

318
174

S t o n e

H i l l

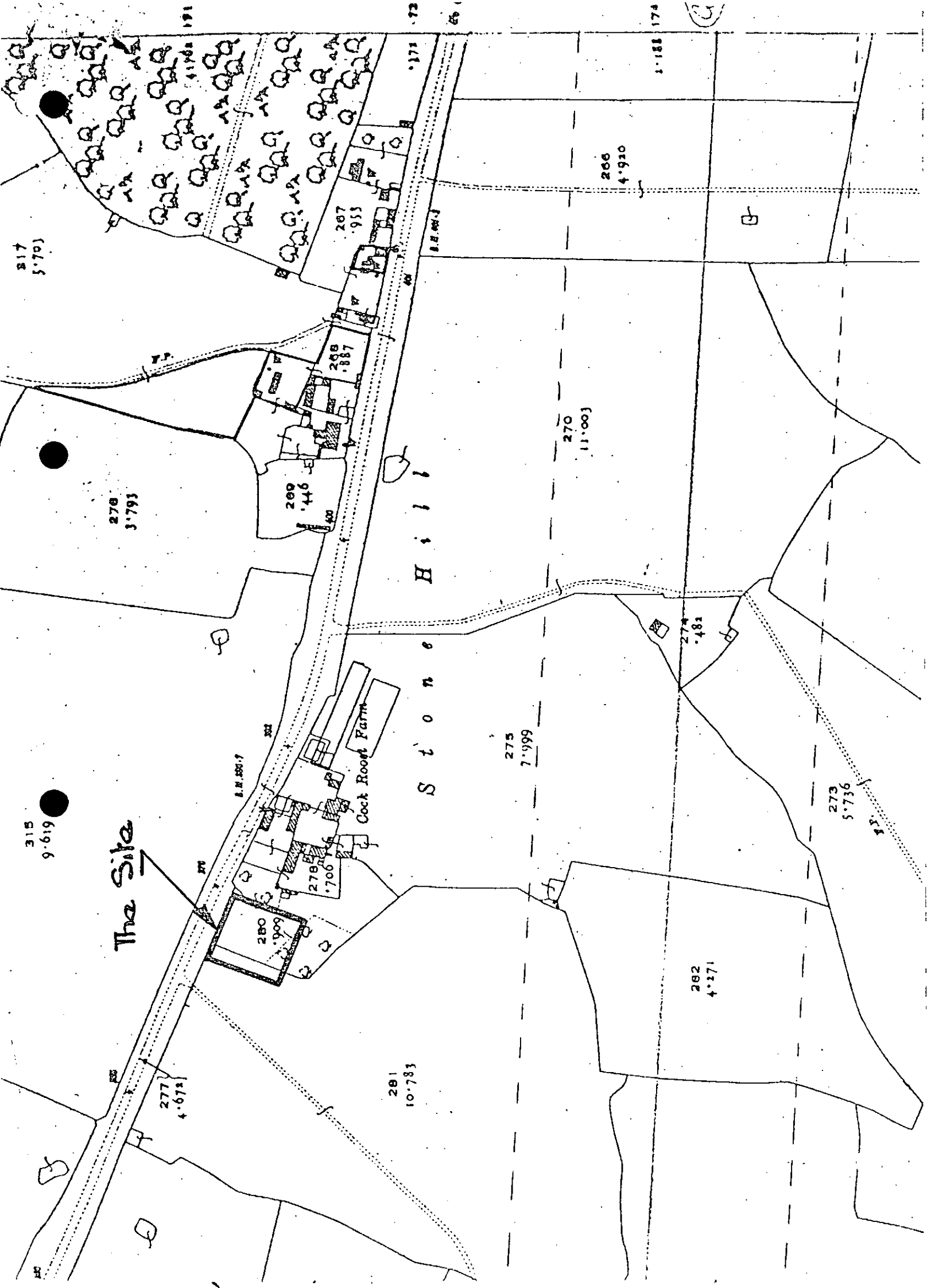

NORTH WILTSHIRE DISTRICT COUNCIL
TOWN AND COUNTRY PLANNING ACT 1971
ENFORCEMENT NOTICE

C. Waller.

To: **Mr. David John Akers,**
16 Balliffs Place,
Cricklade, Wiltshire

The North Wiltshire District Council (hereinafter called "the Council") being the local planning authority for the purposes of Section 87 of the Town and Country Planning Act 1971 in this matter **HEREBY GIVE YOU NOTICE** as a person **owning** the land described in Schedule 1 hereto (hereinafter referred to as "the said land") that:-

1. (i) **On the first day of January 1973 outline planning permission numbered 72/UC/362/0 was granted under Part III of the Town and Country Planning Act 1971 for the construction of two agricultural dwellings on land forming part of parcel 270 (Wilts. O.S. Sheet IX.9 1923) at Stonehill, Charlton near Malmesbury in the County of Wiltshire subject to the following condition among others**
"The occupation of the dwellings shall be limited to persons employed or last employed wholly or mainly locally in agriculture as defined in Section 290(1) of the Town and Country Planning Act 1971 or a dependant of such a person residing with him (but including a widow or widower of such a person)"
(ii) **It appears to the Council that within a period of four years before the date of service of this notice there has been a breach of planning control in that the condition recited above has not been complied with in the respect set out in Schedule 2 hereto.**
2. The Council in pursuance of the powers contained in the said Section 87 and considering it expedient to do so, having regard to the provisions of the development plan and to all other material considerations, **HEREBY REQUIRE** you within **nine months** of the date when this notice takes effect to take the following steps to remedy the said breach of planning control namely:-
To secure the discontinuance of the occupation of the said dwellinghouse by persons being neither wholly nor mainly employed or last employed locally in agriculture as defined by Section 290(1) of the Town and Country Planning Act 1971 or a dependant or widow or widower of such a person

THIS NOTICE SHALL TAKE EFFECT subject to the provisions of Section 88(3) of the Town and Country Planning Act, 1971 at the end of the period of twenty eight days beginning with the **29th day of June, 1981.**

The land forming part of parcel 270 (Wilts. O.S. Sheet IX.9 1923) and now known together with the dwellinghouse now constructed thereon as "High View" Stonehill Charlton near Malmesbury in the County of Wiltshire which is more particularly delineated on the attached plan and thereon edged black

The occupation of the said dwelling is by persons who are neither wholly nor mainly employed or last employed locally in agriculture as defined in Section 290(1) of the Town and Country Planning Act 1971 or the dependant or widow or widower of such a person contrary to the said condition

DATED this

29th

day of

May 1981.

Solicitor to the Council

North Wiltshire District Council,
Monkton Park, Chippenham, Wilts.
(the address to which all communications
should be sent)

**YOUR ATTENTION IS DIRECTED TO THE ATTACHED NOTES WHICH EXPLAIN
YOUR RIGHT OF APPEAL AGAINST THIS NOTICE. YOU SHOULD READ THEM CAREFULLY.**

