

Chief Executive: Bob Marshall

Director: Bob Gwilliam
Director: Jeff Penfold

Monkton Park
Chippenham
Wilts SN15 1ER
Tel: Chippenham (01249) 706594
Fax: Chippenham (01249) 460810
DX No. 34208

Enquiries to: Mrs C A Garrett
Our Ref: 03/00194/EMIN
Your Ref:

North Wiltshire District Council



Dear Sir/Madam

ENFORCEMENT NOTICES AT FILANDS FARM, FILANDS, MALMESBURY, WILTS

The Council have issued an Enforcement Notice relating to the above Land and I now serve on you copies of this Notice, in view of your interest in the Land.

Unless an appeal is made, as set out in the Annex, the Notice will take effect on the date shown in Paragraph 7 of the Notice and you must ensure that the required steps for which you may be held responsible are taken within the period or periods specified. There is no fee payable in respect of any appeal as a fee was paid under planning application number 03.01555.FUL

Yours faithfully

Implementation Team Leader

To Airwave mm O₂ Ltd
Welling Street
Slough
Berkshire
SL1 1YP

E M Panting
Filands Farm
Filands
Malmesbury
Wilts

M A Panting
Filands Farm
Filands
Malmesbury
Wilts

Cheltenham & Gloucester PLC
Barnett Way
Gloucester
GL4 3RL



INVESTOR IN PEOPLE

E:03/00194/EMIN

IMPORTANT - THIS COMMUNICATION AFFECTS YOUR PROPERTY

**TOWN AND COUNTRY PLANNING ACT 1990
(as amended by the Planning and Compensation Act 1991)**

ENFORCEMENT NOTICE

ISSUED BY: North Wiltshire District Council

1. **THIS NOTICE** is issued by the Council because it appears to them that there has been a breach of planning control, within paragraph (a) of section 171A(1) of the above Act, at the land described below. They consider that it is expedient to issue this notice, having regard to the provisions of the development plan and to other material planning considerations. The Annex at the end of the notice and the enclosures to which it refers contain important additional information.
2. **THE LAND TO WHICH THE NOTICE RELATES**

Land at Filands Farm, Filands, Malmesbury, Wiltshire, shown hatched grey on the attached plan.
3. **THE MATTERS WHICH APPEAR TO CONSTITUTE THE BREACH OF PLANNING CONTROL**

Without planning permission, the erection of a 22m high monopole telecommunications mast, fencing, equipment cabin and associated equipment
4. **REASONS FOR ISSUING THIS NOTICE**
 - a) It appears to the Council that the above breach of planning control has occurred within the last four years.
 - b) The development is contrary to Policy RC11 of the adopted North Wiltshire Local Plan in that by virtue of its scale and location demonstrable harm is caused to the amenities of nearby properties and landscape of the area.

5. WHAT YOU ARE REQUIRED TO DO

To remove the telecommunications mast, fencing, equipment cabin and all associated equipment permanently from the land and to reinstate the land to its former state.

6. TIME FOR COMPLIANCE

Two months from the date on which the notices take effect

7. WHEN THIS NOTICE TAKES EFFECT

This notice takes effect on 4 September 2003 unless an appeal is made against it beforehand.

Dated : 24 July 2003

Signed :

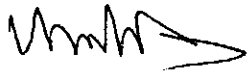
A handwritten signature in black ink, appearing to be 'V. M. H.' followed by a long horizontal stroke.

on behalf of North Wiltshire District Council

ANNEX

YOUR RIGHT OF APPEAL

You can appeal against this notice, but any appeal must be received, or posted in time to be **received**, by the Secretary of State **before** the date specified in paragraph 7 of the notice. The enclosed booklet "Enforcement Notice Appeals - A Guide to Procedure" sets out your rights. You may use the enclosed appeal forms.

- (a) One is for you to send to the Secretary of State if you decide to appeal, together with a copy of this enforcement notice.
- (b) The second copy of the appeal form should be sent to the Council.
- (c) The third copy is for your own records.

WHAT HAPPENS IF YOU DO NOT APPEAL

If you do not appeal against this enforcement notice, it will take effect on the date specified in paragraph 7 of the notice and you must then ensure that the required steps for complying with it, for which you may be held responsible, are taken within the period specified in paragraph 6 of the notice. Failure to comply with an enforcement notice which has taken effect can result in prosecution and/or remedial action by the Council.

393437

Enforcement Notice

4479

6375

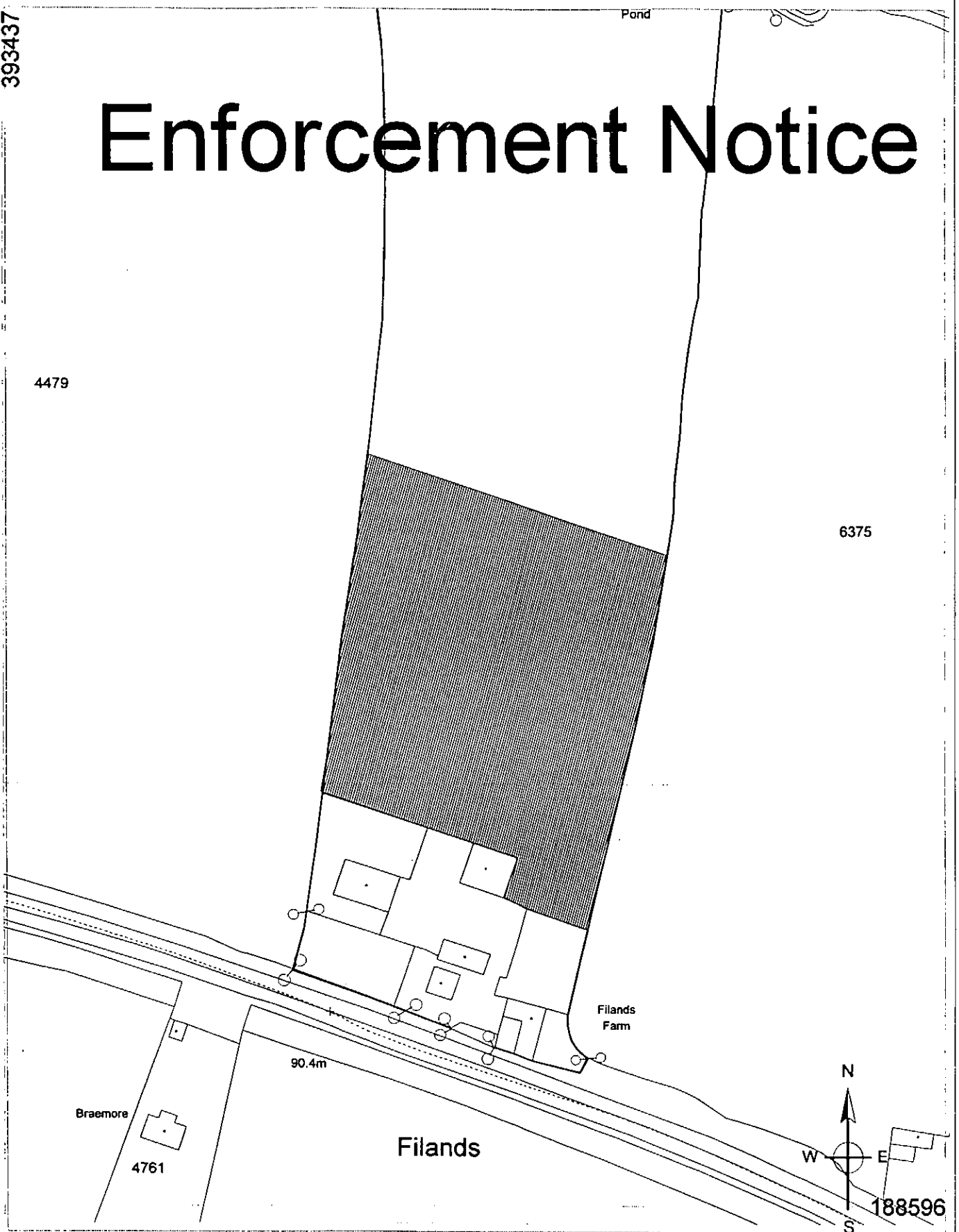

*North
Wiltshire
District
Council*

Filands Farm, Filands, Malmesbury, Wilts
SCALE:1:1250

Grid Ref: ST9352 8871 03/00194/EMIN

Planning Services 21/7/03

Reproduced from the Ordnance Survey mapping with the permission of Her Majesty's Stationery Office
© Crown Copyright. Unauthorised reproduction infringes Crown Copyright and may lead to prosecution or civil proceedings.
NORTH WILTSHIRE DISTRICT COUNCIL - LA078840 2003