

Chief Executive: Bob Marshall
Director: Bob Gwilliam
Director: Jeff Penfold

Business Manager: Laurie Bell

Our Ref:

Your Ref:

Enquiries to: Mrs C A Garrett

Date: 30 September, 2002

The Company Secretary
Liquid Leisure Ltd
Clarks Mill
Stallard Street
Trowbridge
BA14 8HH

02.00139.ELB
*North
Wiltshire
District
Council*

Planning Services
Monkton Park
Chippenham
Wiltshire SN15 1ER

Tel: 01249 706594
Fax: 01249 460810
email: cgarrett@northwiltshire.gov.uk
www.northwiltshire.gov.uk

Dear Sir/Madam

ENFORCEMENT NOTICE IN RESPECT OF THE CHEQUERS INN, MARKET PLACE, BOX

The Council issued an Enforcement Notice in respect of the above on 13 August 2002.

That notice is hereby withdrawn and a new notice is issued today. I attach a copy of this new notice for your attention.

Yours faithfully

C. A. Garrett

Carolyn Garrett
Technical Administration Officer



INVESTOR IN PEOPLE

IMPORTANT

THIS COMMUNICATION AFFECTS YOUR PROPERTY

*North
Wiltshire
District
Council*

Nigel Daniels
Implementation Team Leader

Monkton Park, Chippenham
Wiltshire SN15 1 JN
Telephone (01249)706594

Our Ref: 02.00139.ELB

30 September, 2002

The Company Secretary
Liquid Leisure Ltd
Clarks Mill
Stallard Street
Trowbridge
BA14 8HH

Dear Sir/Madam

PLANNING (LISTED BUILDING AND CONSERVATION AREAS) ACT 1990 LISTED BUILDING ENFORCEMENT NOTICE

Listed Building known as Chequers Inn, Market Place, Box, Corsham, Wilts SN13 8NZ

The Council have issued a Listed Building Enforcement Notice relating to the above land and I now serve on you a copy of that Notice, in view of your interest in the land. Unless an appeal is made to the Secretary of State as described below, the Notice will take effect on the date shown below and you must then ensure that the required steps for which you may be held responsible are taken within the period or periods specified in the Notice.

If you wish to appeal against the Notice, you or your agent should send appeal forms to the Planning Inspectorate, Customer Support Unit, Temple Quay House, 2 The Square, Temple Quay, Bristol BS1 6PN setting out the grounds of your appeal and, in brief, the facts on which you rely for support. The statutory grounds of appeal available are set out in Section 39 of the Act, which are shown in section 8 of the appeal form. Any appeal should have with it the extra copy of the Notice that has been provided. **AN APPEAL SHOULD BE RECEIVED BY THE PLANNING INSPECTORATE BEFORE THE NOTICE TAKES EFFECT.**

There is a requirement on the Council to specify the reasons why the local planning authority consider it expedient to issue the Notice and these reasons are set out in the Notice.

Yours faithfully



Nigel Daniels
Implementation Team Leader

DATE ON WHICH THE NOTICE TAKES EFFECT AND BEFORE WHICH ANY APPEAL MUST BE RECEIVED 4 November 2002



INVESTOR IN PEOPLE

02.00139.ELB

**PLANNING (LISTED BUILDING AND CONSERVATION AREAS) ACT 1990
LISTED BUILDING ENFORCEMENT NOTICE**

Land at Chequers Inn, Market Place, Box, Corsham, Wilts

WHEREAS

It appears to the North Wiltshire District Council ("the Council") being the local planning authority for the purposes of Section 38 of the Planning (Listed Buildings and Conservation Areas) Act 1990 ("the Act") in this matter, that works have been or are being executed to the listed building, described in Schedule 1 overleaf, such as to involve a contravention of Section 7 of the Act.

The contravention which appears to have taken place is described in Schedule 2 overleaf.

The Council consider it expedient, having regard to the effect of the said works on the character of the listed building as one of special architectural or historic interest and to all other material considerations, to issue this listed building enforcement notice, in exercise of their powers in the said Section 38 for the reasons set out in this notice.

NOTICE IS HEREBY GIVEN that the Council require that the steps specified in Schedule 3 overleaf be taken for the purposes set out in that Schedule within the period or periods there specified from the date on which this notice takes effect.

Subject to the provisions of Section 39 of the Act
THIS NOTICE SHALL TAKE EFFECT on 4 November 2002

Signed



**Nigel Daniels, Implementation Team
Leader
Planning Services**

Date 30 September 2002

Monkton Park, Chippenham,
Wiltshire SN15 1ER

02.00139.ELB

SCHEDULE 1 – THE LAND TO WHICH THIS NOTICE RELATES

Chequers Inn, Market Place, Box, Corsham, Wiltshire SN13 8NZ shown hatched on the attached plan marked "Plan I".

Areas 1, 2, 2a, 2b and 3 referred to below as delineated on the attached plan marked "Plan II"

SCHEDULE 2 – THE CONTRAVENTION

- a) Removal of nineteenth century brickwork wall forming passage to beer cellar shown hatched within the area marked "Area 1" on Plan II.
- b) Laying of artificial flagstones (Areas 1, 2 and 2a).
- c) Removal of ceiling plaster (Areas 2b and 3).
- d) Erection of large metal barrier across the adjoining driveway in the position marked "Metal Barrier" on Plan II.

SCHEDULE 3 - REASONS FOR ISSUING THIS NOTICE

It is considered that the unauthorised works described in Schedule 2 have detracted from the character and appearance of the listed building in that:-

- a) the brickwork wall is integral to its functional character as a public house;
- b) the artificial flagstones are out of keeping with the appearance of the original flooring;
- c) the textural quality of the traditional lime plaster ceiling is integral to the character of the building; and
- d) the metal barrier is a crudely detailed modern feature which is incongruous and detracts from the character of the listed building.

SCHEDULE 4 – STEPS REQUIRED TO BE TAKEN TO REMEDY THE CONTRAVENTION

- 1) Reinstall the said brick wall and lime-plaster the western face using materials to be approved in writing by the Council.
- 2) Remove the said flagstones or apply either a concrete finish or other floor covering thereto.

- 3) Replace the lath and plaster ceiling.
- 4) Remove the said barrier.

TIME FOR COMPLIANCE –

Three months from the date of this Notice.

Enforcement Notice

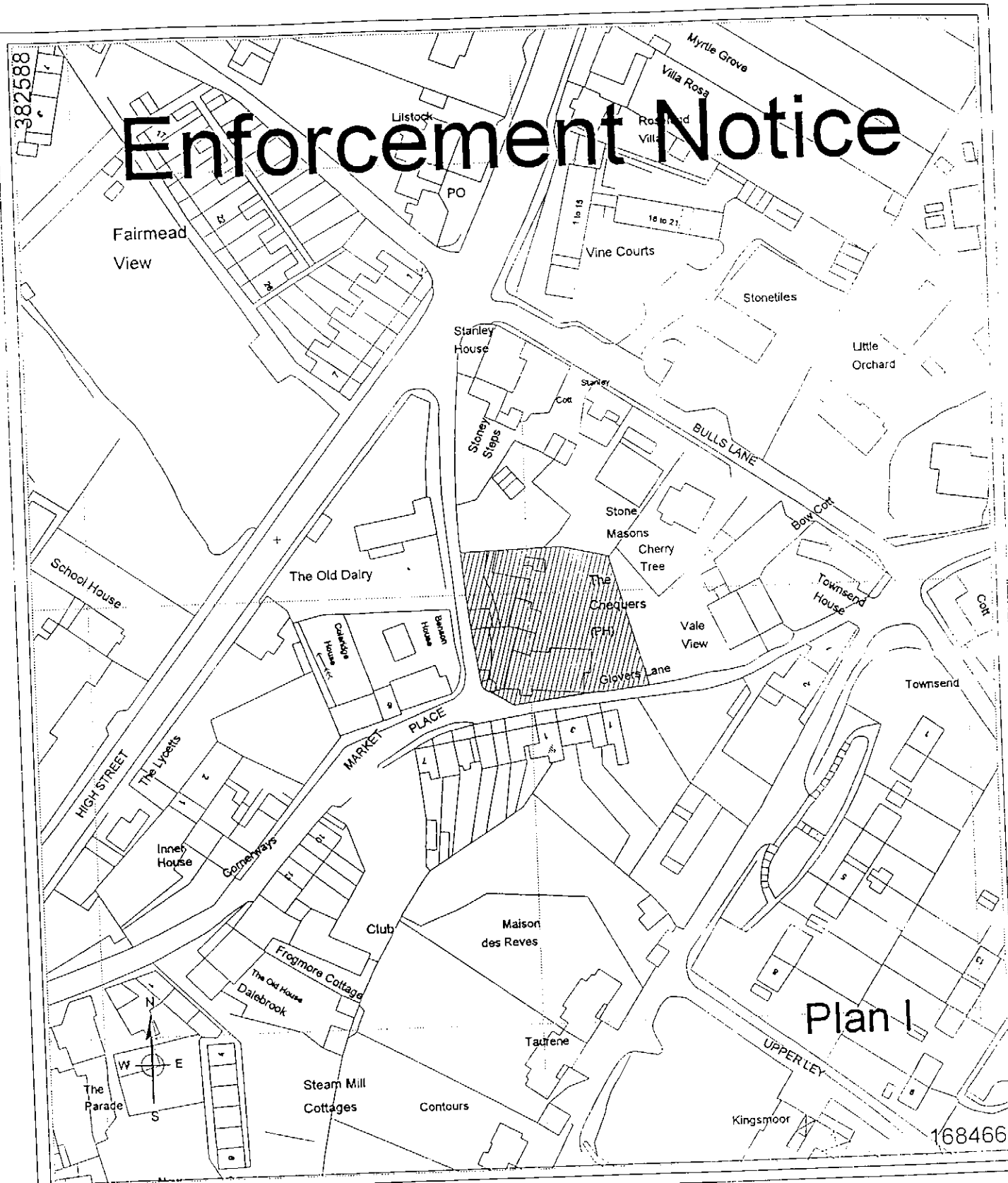

Plan I

*North
Wiltshire
District
Council*

The Chequers Inn, Market Place, Box
SCALE:1:1250

ST8270 6859 02.00139.ELB

Planning Services

12/8/2002

Reproduced from the Ordnance Survey mapping with the permission of Her Majesty's Stationery Office
© Crown Copyright. Unauthorised reproduction infringes Crown Copyright and may lead to prosecution or civil proceedings
NORTH WILTSHIRE DISTRICT COUNCIL - LA018840 2002

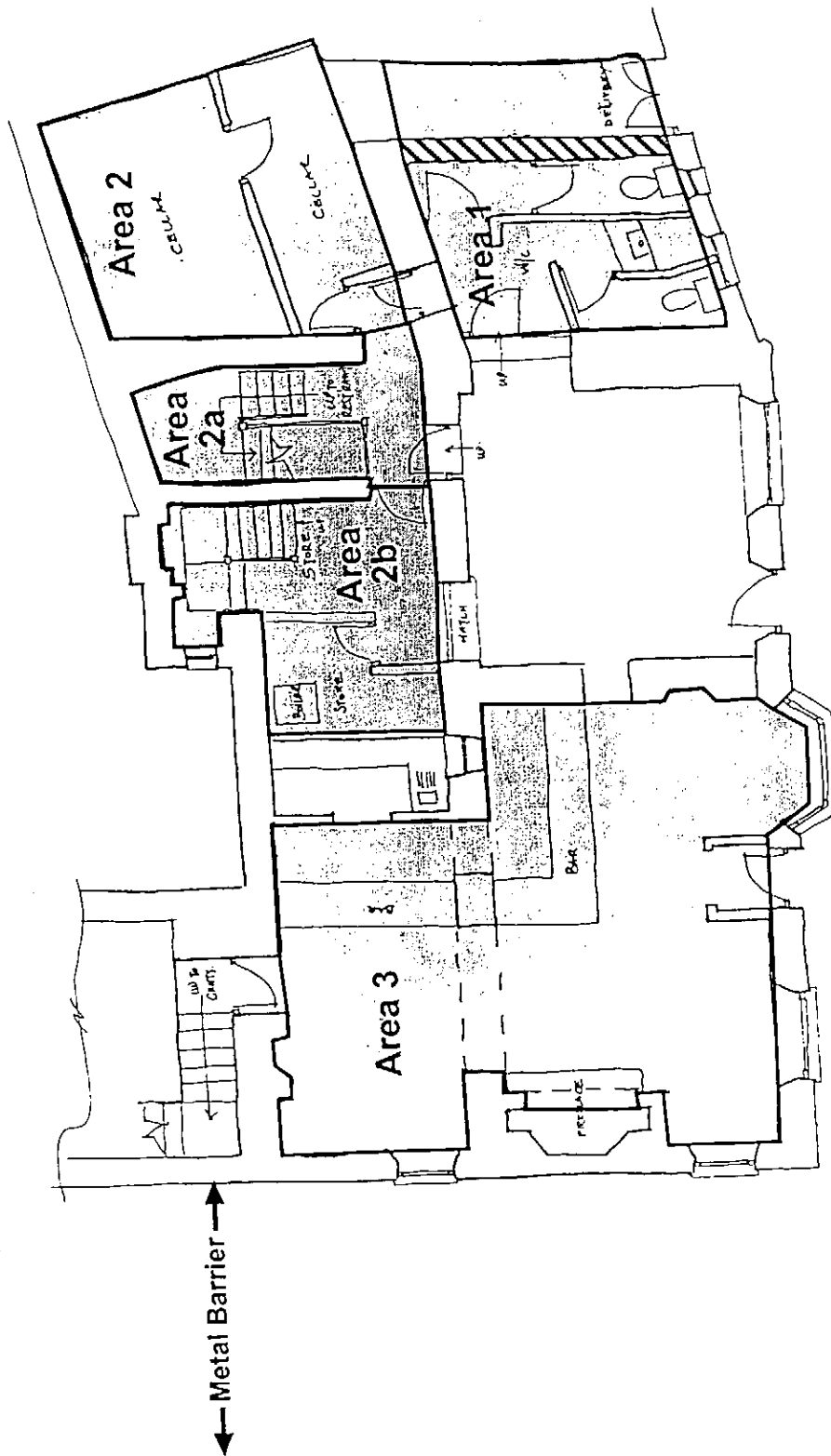

Plan II

The Chequers Inn
Market Place
Box

Scale 1:100

Ref: 02/00139/ELB

August 2002

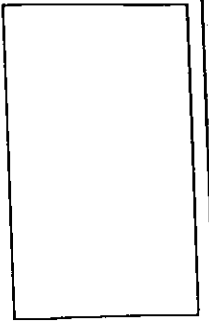

IMPORTANT

THIS COMMUNICATION AFFECTS YOUR PROPERTY

Nigel Daniels
Implementation Team Leader

Monkton Park, Chippenham
Wiltshire SN15 1 JN
Telephone (01249)706594

Our Ref: 02.00139.ELB

13 August, 2002

The Company Secretary
Liquid Leisure Ltd
Clarks Mill
Stallard Street
Trowbridge
BA14 8HH

Dear Sir/Madam

PLANNING (LISTED BUILDING AND CONSERVATION AREAS) ACT 1990 LISTED BUILDING ENFORCEMENT NOTICE

Listed Building known as Chequers Inn, Market Place, Box, Corsham, Wilts SN13 8NZ

The Council have issued a Listed Building Enforcement Notice relating to the above land and I now serve on you a copy of that Notice, in view of your interest in the land. Unless an appeal is made to the Secretary of State as described below, the Notice will take effect on the date shown below and you must then ensure that the required steps for which you may be held responsible are taken within the period or periods specified in the Notice.

If you wish to appeal against the Notice, you or your agent should send appeal forms to the Planning Inspectorate, Customer Support Unit, Temple Quay House, 2 The Square, Temple Quay, Bristol BS1 6PN setting out the grounds of your appeal and, in brief, the facts on which you rely for support. The statutory grounds of appeal available are set out in Section 39 of the Act, which are shown in section 8 of the appeal form. Any appeal should have with it the extra copy of the Notice that has been provided. **AN APPEAL SHOULD BE RECEIVED BY THE PLANNING INSPECTORATE BEFORE THE NOTICE TAKES EFFECT.**

There is a requirement on the Council to specify the reasons why the local planning authority consider it expedient to issue the Notice and these reasons are set out in the Notice.

Yours faithfully



Nigel Daniels
Implementation Team Leader

DATE ON WHICH THE NOTICE TAKES EFFECT AND BEFORE WHICH ANY APPEAL MUST BE RECEIVED 17 September 2002



INVESTOR IN PEOPLE

02/00139/ELB
*North
Wiltshire
District
Council*

02.00139.ELB

**PLANNING (LISTED BUILDING AND CONSERVATION AREAS) ACT 1990
LISTED BUILDING ENFORCEMENT NOTICE**

Land at Chequers Inn, Market Place, Box, Corsham, Wilts, SN13 8NZ

WHEREAS

It appears to the North Wiltshire District Council ("the Council") being the local planning authority for the purposes of Section 38 of the Planning (Listed Buildings and Conservation Areas) Act 1990 ("the Act") in this matter, that works have been or are being executed to the listed building, described in Schedule 1 overleaf, such as to involve a contravention of Section 7 of the Act.

The contravention which appears to have taken place is described in Schedule 2 overleaf.

The Council consider it expedient, having regard to the effect of the said works on the character of the listed building as one of special architectural or historic interest and to all other material considerations, to issue this listed building enforcement notice, in exercise of their powers in the said Section 38 for the reasons set out in this notice.

NOTICE IS HEREBY GIVEN that the Council require that the steps specified in Schedule 3 overleaf be taken for the purposes set out in that Schedule within the period or periods there specified from the date on which this notice takes effect.

Subject to the provisions of Section 39 of the Act
THIS NOTICE SHALL TAKE EFFECT on 17 September 2002

Signed



**Nigel Daniels, Implementation Team
Leader
Planning Services**

Date 13 August 2002

**Monkton Park, Chippenham,
Wiltshire SN15 1ER**

02.00139.ELB

SCHEDULE 1 – THE LAND TO WHICH THIS NOTICE RELATES

Chequers Inn, Market Place, Box, Corsham, Wiltshire SN13 8NZ shown hatched on the attached plan marked "Plan I".

Areas 1, 2, 2a, 2b and 3 referred to below as delineated on the attached plan marked "Plan II"

SCHEDULE 2 – THE CONTRAVENTION

- a) Removal of nineteenth century brickwork wall forming passage to beer cellar shown hatched within the area marked "Area 1" on Plan II.
- b) Laying of artificial flagstones (Areas 1, 2 and 2a).
- c) Removal of ceiling plaster (Areas 2b and 3).
- d) Erection of large metal barrier across the adjoining driveway in the position marked "Metal Barrier" on Plan II.

SCHEDULE 3 – STEPS REQUIRED TO BE TAKEN TO REMEDY THE CONTRAVENTION

- 1) Reinstate the said brick wall and lime-plaster the western face using materials to be approved in writing by the Council.
- 2) Remove the said flagstones or apply either a concrete finish or other floor covering thereto.
- 3) Replace the lath and plaster ceiling.
- 4) Remove the said barrier.

TIME FOR COMPLIANCE –

Three months from the date of this Notice.

Enforcement Notice

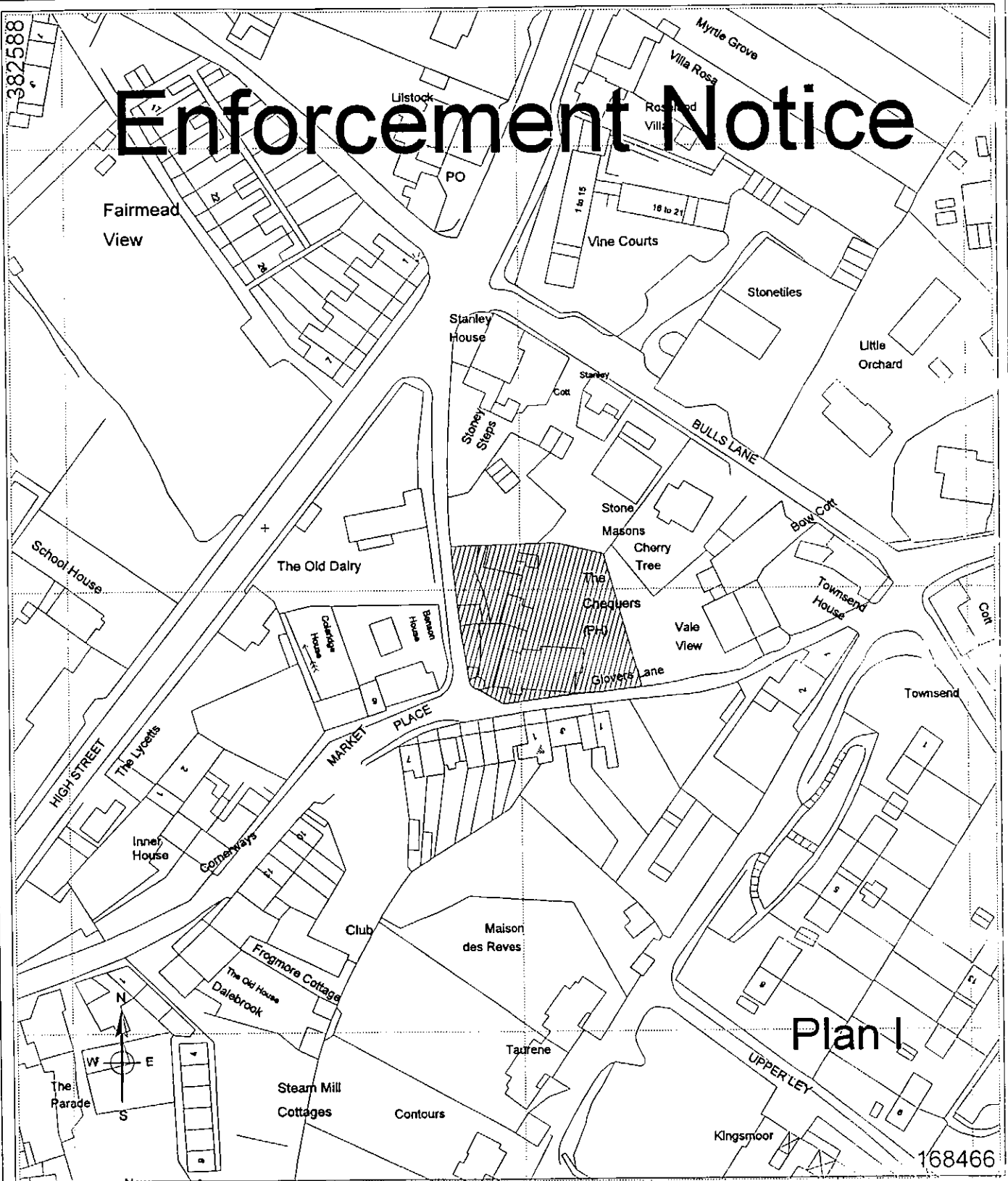

Plan I

*North
Wiltshire
District
Council*

The Chequers Inn, Market Place, Box
SCALE: 1:1250

ST8270 6859 02.00139.ELB

Planning Services

12/8/2002

Reproduced from the Ordnance Survey mapping with the permission of Her Majesty's Stationary Office
© Crown Copyright. Unauthorised reproduction infringes Crown Copyright and may lead to prosecution or civil proceedings.
NORTH WILTSHIRE DISTRICT COUNCIL - LA078840 2002

The Chequers Inn
Market Place
Box

Ref: 02/00139/ELB

