

Chief Executive: Bob Marshall

Director: Bob Gwilliam
Director: Jeff Penfold

Replies to:
P.L. Jeremiah LL.B.
Solicitor to the Council
Monkton Park
CHIPPENHAM
Wiltshire SN15 1ER

Tel: Chippenham (01249) 706111 Ext593
Fax: Chippenham (01249) 443152
DX No. 34208

Enquiries to: P Taylor
Our Ref: PT\CG E99.9134
Your Ref:

*North
Wiltshire
District
Council*

22 December 1999

Dear Sir

ENFORCEMENT NOTICE AT LAND AT CLOATLEY ROAD, HANKERTON, WILTSHIRE

The Council have issued an Enforcement Notice relating to the above Land and I now serve on you copies of this Notice, in view of your interest in the Land.

Unless an appeal is made, as set out in the Annex, the Notice will take effect on the date shown in Paragraph 7 of the Notice and you must ensure that the required steps for which you may be held responsible are taken within the period or periods specified.

Yours faithfully

Paul M. Taylor

SOLICITOR TO THE COUNCIL

To Mr P Taylor
Cloatley Manor Farm
Hankerton
Wiltshire SN16 9LQ

DEVELOPMENT CONTROL	
23 DEC 1999	
PASSED TO	DATE REC



99/134



INVESTOR IN PEOPLE

IMPORTANT - THIS COMMUNICATION AFFECTS YOUR PROPERTY

**TOWN AND COUNTRY PLANNING ACT 1990
(as amended by the Planning and Compensation Act 1991)**

ENFORCEMENT NOTICE

ISSUED BY: North Wiltshire District Council

1. **THIS NOTICE** is issued by the Council because it appears to them that there has been a breach of planning control, within paragraph (a) of section 171A(1) of the above Act, at the land described below. They consider that it is expedient to issue this notice, having regard to the provisions of the development plan and to other material planning considerations. The Annex at the end of the notice and the enclosures to which it refers contain important additional information.
2. **THE LAND TO WHICH THE NOTICE RELATES**

Land at Cloatley Road, Hankerton, Wiltshire, shown shaded on the attached plan.
3. **THE MATTERS WHICH APPEAR TO CONSTITUTE THE BREACH OF PLANNING CONTROL**

Without planning permission, the erection of a dwelling on the land.
4. **REASONS FOR ISSUING THIS NOTICE**
 - a) It appears to the Council that the above breach of planning control has occurred within the last four years.
 - b) The dwelling, which is not justified by the essential needs of agriculture or forestry, is detrimental to the rural character and amenity of the area, thereby conflicting with Policy H10 of the North Wiltshire Local Plan and Policy RH11 of the emerging North Wiltshire Local Plan Review.
 - c) Any increased use made of the existing sub-standard access to the land generated by the dwelling would be prejudicial to highway safety.

- d) The dwelling, located remote from services and employment opportunities, and being unlikely to be well served by public transport, conflicts with the key aims of Planning Policy Guidance Note No. 13, which seeks to reduce growth in the number and length of motorised journeys.

5. WHAT YOU ARE REQUIRED TO DO

- a) Demolish the dwelling and remove all resulting materials from the land.
- b) Restore the land to a condition suitable for agricultural use.

6. TIME FOR COMPLIANCE

- Step 5a) three months after this notice takes effect.
- Step 5b) four months after this notice takes effect.

7. WHEN THIS NOTICE TAKES EFFECT

This notice takes effect on 2 February 2000 unless an appeal is made against it beforehand.

Dated :22 December 1999

Signed : *P.L. Jeremiah*

on behalf of North Wiltshire District Council

ANNEX

YOUR RIGHT OF APPEAL

You can appeal against this notice, but any appeal must be received, or posted in time to be **received**, by the Secretary of State **before** the date specified in paragraph 7 of the notice. The enclosed booklet "Enforcement Notice Appeals - A Guide to Procedure" sets out your rights. You may use the enclosed appeal forms.

- (a) One is for you to send to the Secretary of State if you decide to appeal, together with a copy of this enforcement notice.
- (b) The second copy of the appeal form should be sent to the Council.
- (c) The third copy is for your own records.

WHAT HAPPENS IF YOU DO NOT APPEAL

If you do not appeal against this enforcement notice, it will take effect on the date specified in paragraph 7 of the notice and you must then ensure that the required steps for complying with it, for which you may be held responsible, are taken within the period specified in paragraph 6 of the notice. Failure to comply with an enforcement notice which has taken effect can result in prosecution and/or remedial action by the Council.

Reproduced from the Ordnance Survey mapping with the permission of Her Majesty's Stationary Office
© Crown Copyright. Unauthorised reproduction infringes Crown Copyright and may lead to prosecution or civil proceedings.
NORTH WILTSHIRE DISTRICT COUNCIL - LA078840 1996

Chief Executive: Bob Marshall

Director: Bob Gwilliam
Director: Jeff Penfold

Replies to:
P.L. Jeremiah LL.B.
Solicitor to the Council
Monkton Park
CHIPPENHAM
Wiltshire SN15 1ER

Tel: Chippenham (01249) 706111 Ext593
Fax: Chippenham (01249) 443152
DX No. 34208

Enquiries to: P Taylor
Our Ref: PT\CG E99.9134
Your Ref:

E.99.0134
*North
Wiltshire
District
Council*

22 December 1999

plotted 10/10/00

Dear Sir

ENFORCEMENT NOTICE AT LAND AT CLOATLEY ROAD, HANKERTON, WILTSHIRE

The Council have issued an Enforcement Notice relating to the above Land and I now serve on you copies of this Notice, in view of your interest in the Land.

Unless an appeal is made, as set out in the Annex, the Notice will take effect on the date shown in Paragraph 7 of the Notice and you must ensure that the required steps for which you may be held responsible are taken within the period or periods specified.

Yours faithfully

Paul M. Taylor
SOLICITOR TO THE COUNCIL

To Mr P Taylor
Cloatley Manor Farm
Hankerton
Wiltshire SN16 9LQ

DEVELOPMENT CONTROL	
23 DEC 1999	
PASSED TO	DATE REC.



IMPORTANT - THIS COMMUNICATION AFFECTS YOUR PROPERTY

**TOWN AND COUNTRY PLANNING ACT 1990
(as amended by the Planning and Compensation Act 1991)**

ENFORCEMENT NOTICE

ISSUED BY: North Wiltshire District Council

1. **THIS NOTICE** is issued by the Council because it appears to them that there has been a breach of planning control, within paragraph (a) of section 171A(1) of the above Act, at the land described below. They consider that it is expedient to issue this notice, having regard to the provisions of the development plan and to other material planning considerations. The Annex at the end of the notice and the enclosures to which it refers contain important additional information.
2. **THE LAND TO WHICH THE NOTICE RELATES**

Land at Cloatley Road, Hankerton, Wiltshire, shown shaded on the attached plan.
3. **THE MATTERS WHICH APPEAR TO CONSTITUTE THE BREACH OF PLANNING CONTROL**

Without planning permission, the erection of a dwelling on the land.
4. **REASONS FOR ISSUING THIS NOTICE**
 - a) It appears to the Council that the above breach of planning control has occurred within the last four years.
 - b) The dwelling, which is not justified by the essential needs of agriculture or forestry, is detrimental to the rural character and amenity of the area, thereby conflicting with Policy H10 of the North Wiltshire Local Plan and Policy RH11 of the emerging North Wiltshire Local Plan Review.
 - c) Any increased use made of the existing sub-standard access to the land generated by the dwelling would be prejudicial to highway safety.

- d) The dwelling, located remote from services and employment opportunities, and being unlikely to be well served by public transport, conflicts with the key aims of Planning Policy Guidance Note No. 13, which seeks to reduce growth in the number and length of motorised journeys.

5. WHAT YOU ARE REQUIRED TO DO

- a) Demolish the dwelling and remove all resulting materials from the land.
- b) Restore the land to a condition suitable for agricultural use.

6. TIME FOR COMPLIANCE

- Step 5a) three months after this notice takes effect.
- Step 5b) four months after this notice takes effect.

7. WHEN THIS NOTICE TAKES EFFECT

This notice takes effect on 2 February 2000 unless an appeal is made against it beforehand.

Dated :22 December 1999

Signed : *P.L. Jeremiah*

on behalf of North Wiltshire District Council

ANNEX

YOUR RIGHT OF APPEAL

You can appeal against this notice, but any appeal must be received, or posted in time to be **received**, by the Secretary of State **before** the date specified in paragraph 7 of the notice. The enclosed booklet "Enforcement Notice Appeals - A Guide to Procedure" sets out your rights. You may use the enclosed appeal forms.

- (a) One is for you to send to the Secretary of State if you decide to appeal, together with a copy of this enforcement notice.
- (b) The second copy of the appeal form should be sent to the Council.
- (c) The third copy is for your own records.

WHAT HAPPENS IF YOU DO NOT APPEAL

If you do not appeal against this enforcement notice, it will take effect on the date specified in paragraph 7 of the notice and you must then ensure that the required steps for complying with it, for which you may be held responsible, are taken within the period specified in paragraph 6 of the notice. Failure to comply with an enforcement notice which has taken effect can result in prosecution and/or remedial action by the Council.

9800

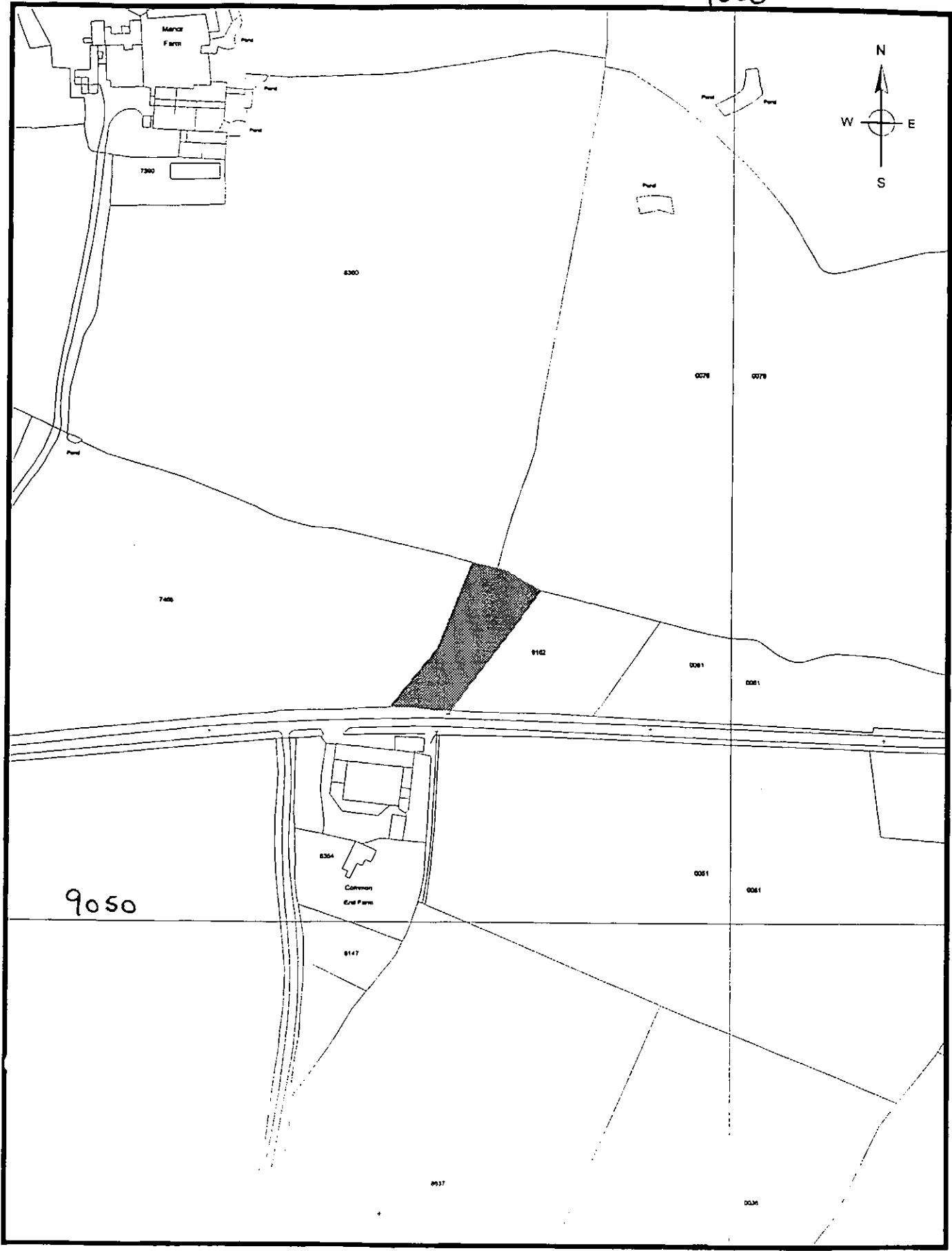

9050

*North
Wiltshire
District
Council*

Enforcement Notice - E.99.0134
SCALE: 1:2500

ST 9780-9060

Land at Cloatley Road HANKERTON
1/12/1999

Reproduced from the Ordnance Survey mapping with the permission of Her Majesty's Stationery Office
© Crown Copyright. Unauthorised reproduction infringes Crown Copyright and may lead to prosecution or civil proceedings.
NORTH WILTSHIRE DISTRICT COUNCIL - LA078840 1266