

Chief Executive: Bob Marshall

Director: Bob Gwilliam  
Director: Jeff Penfold

**Replies to:**

P.L. Jeremiah LL.B.  
Solicitor to the Council  
Bewley House  
Marshfield Road  
CHIPPENHAM  
Wiltshire SN15 1JN

*D. Auld*

*North  
Wiltshire  
District  
Council*

Tel: Chippenham (01249) 706111 Ext593  
Fax: Chippenham (01249) 443152  
DX No.34208

1 September 2000

**Enquiries to:** R J Packer  
**Our Ref:** RJP\CG E99.0050  
**Your Ref:**



Dear Sir/Madam

**ENFORCEMENT NOTICE AT GREENWAY FARM, GREENWAY, TOCKENHAM,  
WILTSHIRE**

The Council have issued an Enforcement Notice relating to the above Land and I now serve on you copies of this Notice, in view of your interest in the Land.

Unless an appeal is made, as set out in the Annex, the Notice will take effect on the date shown in Paragraph 7 of the Notice and you must ensure that the required steps for which you may be held responsible are taken within the period or periods specified.

Yours faithfully

*for* **SOLICITOR TO THE COUNCIL**

To Mr J A Ivory  
Greenway Farm  
Greenway  
Tockenham  
Wiltshire

Mrs N A Ivory  
Greenway Farm  
Greenway  
Tockenham  
Wiltshire

Mr F J Webb  
Greenway Farm  
Greenway  
Tockenham  
Wiltshire



INVESTOR IN PEOPLE

**E99.0050**

# **IMPORTANT - THIS COMMUNICATION AFFECTS YOUR PROPERTY**

**TOWN AND COUNTRY PLANNING ACT 1990  
(as amended by the Planning and Compensation Act 1991)**

## **ENFORCEMENT NOTICE**

ISSUED BY: North Wiltshire District Council

1. **THIS NOTICE** is issued by the Council because it appears to them that there has been a breach of planning control, within paragraph (a) of section 171A(1) of the above Act, at the land described below. They consider that it is expedient to issue this notice, having regard to the provisions of the development plan and to other material planning considerations. The Annex at the end of the notice and the enclosures to which it refers contain important additional information.
2. **THE LAND TO WHICH THE NOTICE RELATES**  
  
Land at Greenway Farm, Greenway, Tockenham, Wiltshire shown shaded on the attached plan.
3. **THE MATTERS WHICH APPEAR TO CONSTITUTE THE BREACH OF PLANNING CONTROL**  
  
Without planning permission, change of use of the land from agricultural use to use for equestrian purposes and for the siting of a mobile home.
4. **REASONS FOR ISSUING THIS NOTICE**
  - a) It appears to the Council that the above breach of planning control has occurred within the last ten years.
  - b) The use of the land for equestrian purposes could result in the need for a dwelling in the countryside, contrary to Policy H10 of the North Wiltshire Local Plan, Policy H19 of the North East Wiltshire Structure Plan, Policy RLF13 of the North Wiltshire Local Plan Review and Policy DP1 of the Wiltshire Structure Plan 2011.

- c) The mobile home constitutes residential accommodation in the countryside which is not justified in connection with the essential needs of agriculture or forestry, contrary to Policy H13 of the North Wiltshire Local Plan, Policies H19 and H24 of the North East Wiltshire Structure Plan and Policy RH16 of the North Wiltshire Local Plan Review.

**5. WHAT YOU ARE REQUIRED TO DO**

- a) Remove the mobile home, attached lean-to structure and concrete block plinth wall, raised wooden patio area (including supporting concrete blocks) and steps from the land.
- b) Stop using any part of the land for the siting of a mobile home.
- c) Stop using any part of the land for equestrian purposes.

**6. TIME FOR COMPLIANCE**

Twelve months after this notice takes effect.

**7. WHEN THIS NOTICE TAKES EFFECT**

This notice takes effect on 13 October 2000 unless an appeal is made against it beforehand.

Dated :1 September 2000

Signed : *P. L. Seremiah*

on behalf of North Wiltshire District Council

## **ANNEX**

### **YOUR RIGHT OF APPEAL**

You can appeal against this notice, but any appeal must be received, or posted in time to be **received**, by the Secretary of State **before** the date specified in paragraph 7 of the notice. The enclosed booklet "Enforcement Notice Appeals - A Guide to Procedure" sets out your rights. You may use the enclosed appeal forms.

- (a) One is for you to send to the Secretary of State if you decide to appeal, together with a copy of this enforcement notice.
- (b) The second copy of the appeal form should be sent to the Council.
- (c) The third copy is for your own records.

### **WHAT HAPPENS IF YOU DO NOT APPEAL**

If you do not appeal against this enforcement notice, it will take effect on the date specified in paragraph 7 of the notice and you must then ensure that the required steps for complying with it, for which you may be held responsible, are taken within the period specified in paragraph 6 of the notice. Failure to comply with an enforcement notice which has taken effect can result in prosecution and/or remedial action by the Council.

# PLANNING ENFORCEMENT

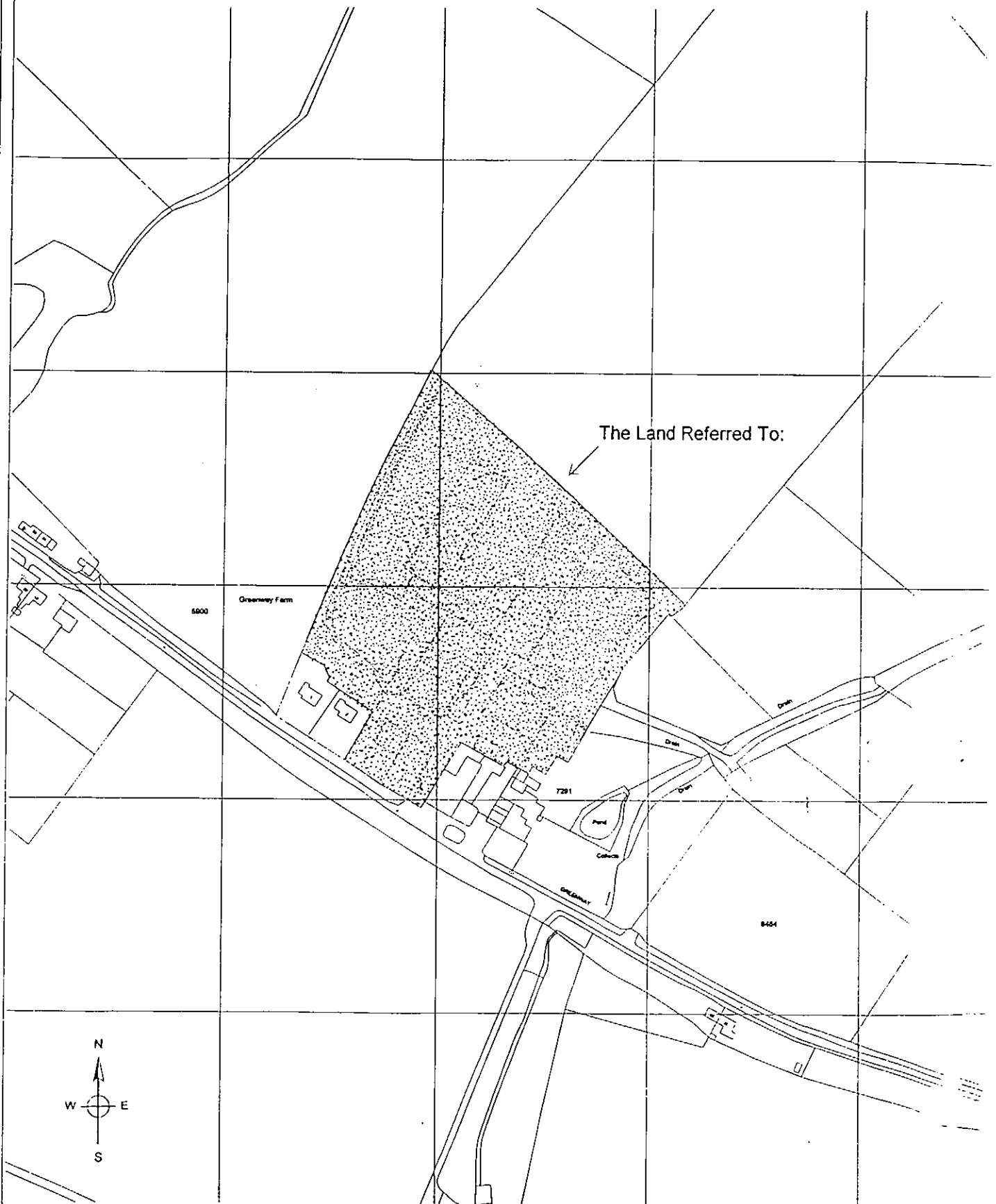

*North  
Wiltshire  
District  
Council*

Enforcement Notice  
SCALE:1:2500

E.99.00050

Legal

12/1/2000

Reproduced from the Ordnance Survey mapping with the permission of Her Majesty's Stationery Office  
© Crown Copyright. Unauthorised reproduction infringes Crown Copyright and may lead to prosecution or civil proceedings.  
NORTH WILTSHIRE DISTRICT COUNCIL 12/1/2000

E.99.0050

*North  
Wiltshire  
District  
Council*

**Chief Executive: Bob Marshall**

Director: Bob Gwilliam  
Director: Jeff Penfold

**Replies to:**

P.L. Jeremiah LL.B.  
Solicitor to the Council  
Bewley House  
Marshfield Road  
CHIPPENHAM  
Wiltshire SN15 1JN

*Plotting  
Office*

Tel: Chippenham (01249) 706111 Ext593  
Fax: Chippenham (01249) 443152  
DX No.34208

1 September 2000

**Enquiries to:** R J Packer  
**Our Ref:** RJP\CG E99.0050  
**Your Ref:**



*plotted on 10/10/00*

Dear Sir/Madam

**ENFORCEMENT NOTICE AT GREENWAY FARM, GREENWAY, TOCKENHAM,  
WILTSHIRE**

The Council have issued an Enforcement Notice relating to the above Land and I now serve on you copies of this Notice, in view of your interest in the Land.

Unless an appeal is made, as set out in the Annex, the Notice will take effect on the date shown in Paragraph 7 of the Notice and you must ensure that the required steps for which you may be held responsible are taken within the period or periods specified.

Yours faithfully

*for*

**SOLICITOR TO THE COUNCIL**

To Mr J A Ivory  
Greenway Farm  
Greenway  
Tockenham  
Wiltshire

Mrs N A Ivory  
Greenway Farm  
Greenway  
Tockenham  
Wiltshire

Mr F J Webb  
Greenway Farm  
Greenway  
Tockenham  
Wiltshire



INVESTOR IN PEOPLE

**E99.0050**

# **IMPORTANT - THIS COMMUNICATION AFFECTS YOUR PROPERTY**

**TOWN AND COUNTRY PLANNING ACT 1990  
(as amended by the Planning and Compensation Act 1991)**

## **ENFORCEMENT NOTICE**

ISSUED BY: North Wiltshire District Council

1. **THIS NOTICE** is issued by the Council because it appears to them that there has been a breach of planning control, within paragraph (a) of section 171A(1) of the above Act, at the land described below. They consider that it is expedient to issue this notice, having regard to the provisions of the development plan and to other material planning considerations. The Annex at the end of the notice and the enclosures to which it refers contain important additional information.

2. **THE LAND TO WHICH THE NOTICE RELATES**

Land at Greenway Farm, Greenway, Tockenham, Wiltshire shown shaded on the attached plan.

3. **THE MATTERS WHICH APPEAR TO CONSTITUTE THE BREACH OF PLANNING CONTROL**

Without planning permission, change of use of the land from agricultural use to use for equestrian purposes and for the siting of a mobile home.

4. **REASONS FOR ISSUING THIS NOTICE**

- a) It appears to the Council that the above breach of planning control has occurred within the last ten years.
- b) The use of the land for equestrian purposes could result in the need for a dwelling in the countryside, contrary to Policy H10 of the North Wiltshire Local Plan, Policy H19 of the North East Wiltshire Structure Plan, Policy RLF13 of the North Wiltshire Local Plan Review and Policy DP1 of the Wiltshire Structure Plan 2011.

- c) The mobile home constitutes residential accommodation in the countryside which is not justified in connection with the essential needs of agriculture or forestry, contrary to Policy H13 of the North Wiltshire Local Plan, Policies H19 and H24 of the North East Wiltshire Structure Plan and Policy RH16 of the North Wiltshire Local Plan Review.

## **5. WHAT YOU ARE REQUIRED TO DO**

- a) Remove the mobile home, attached lean-to structure and concrete block plinth wall, raised wooden patio area (including supporting concrete blocks) and steps from the land.
- b) Stop using any part of the land for the siting of a mobile home.
- c) Stop using any part of the land for equestrian purposes.

## **6. TIME FOR COMPLIANCE**

Twelve months after this notice takes effect.

## **7. WHEN THIS NOTICE TAKES EFFECT**

This notice takes effect on 13 October 2000 unless an appeal is made against it beforehand.

Dated :1 September 2000

Signed : *P.L. Seremiah*

on behalf of North Wiltshire District Council



## **ANNEX**

### **YOUR RIGHT OF APPEAL**

You can appeal against this notice, but any appeal must be received, or posted in time to be **received**, by the Secretary of State **before** the date specified in paragraph 7 of the notice. The enclosed booklet "Enforcement Notice Appeals - A Guide to Procedure" sets out your rights. You may use the enclosed appeal forms.

- (a) One is for you to send to the Secretary of State if you decide to appeal, together with a copy of this enforcement notice.
- (b) The second copy of the appeal form should be sent to the Council.
- (c) The third copy is for your own records.

### **WHAT HAPPENS IF YOU DO NOT APPEAL**

If you do not appeal against this enforcement notice, it will take effect on the date specified in paragraph 7 of the notice and you must then ensure that the required steps for complying with it, for which you may be held responsible, are taken within the period specified in paragraph 6 of the notice. Failure to comply with an enforcement notice which has taken effect can result in prosecution and/or remedial action by the Council.

# PLANNING ENFORCEMENT

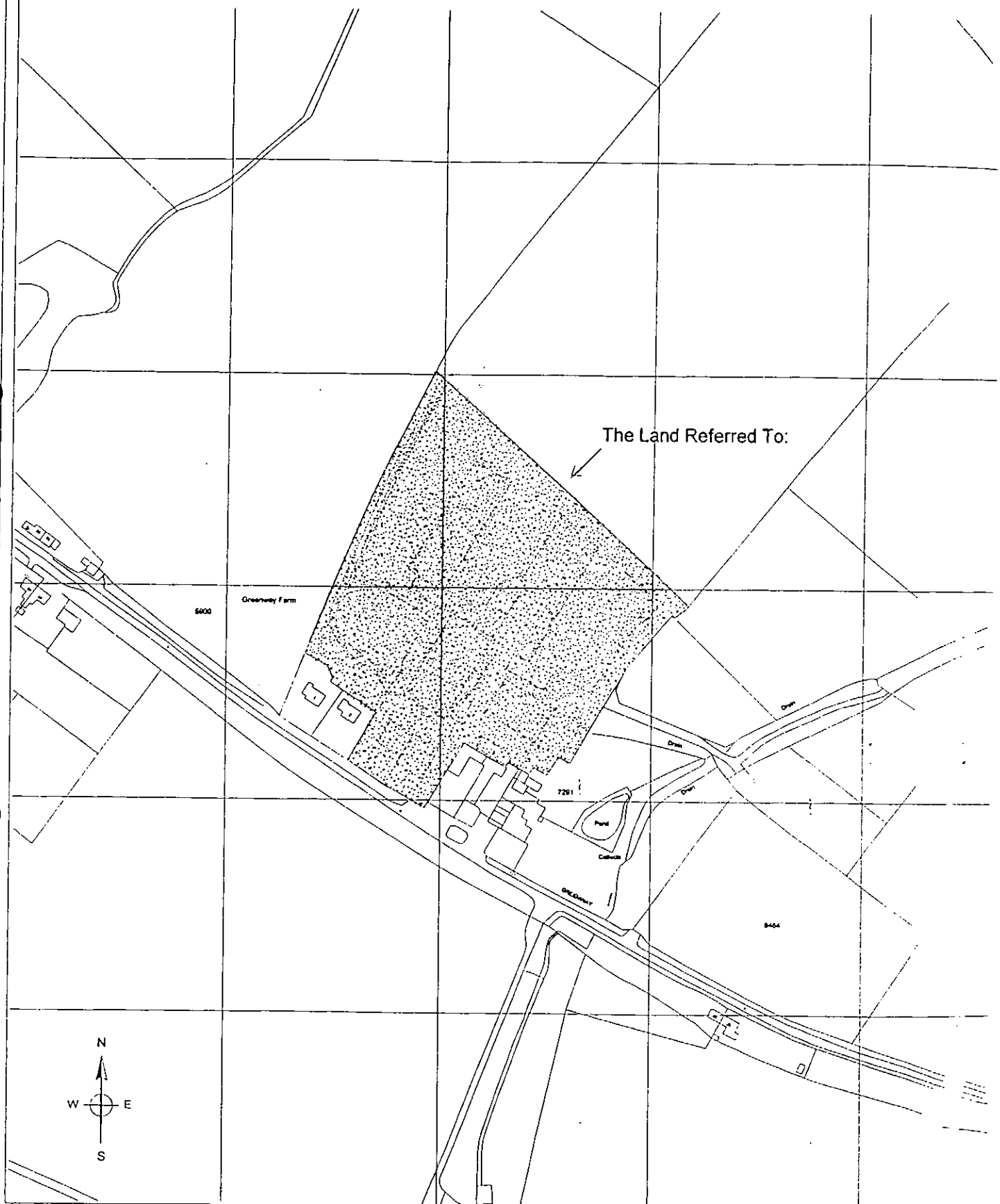

*North  
Wiltshire  
District  
Council*

Enforcement Notice  
SCALE:1:2500

E.99.00050

Legal

12/12/2000

Reproduced from the Ordnance Survey mapping with the permission of Her Majesty's Stationery Office  
© Crown Copyright. Unauthorised reproduction infringes Crown Copyright and may lead to prosecution or civil proceedings.  
NORTH WILTSHIRE DISTRICT COUNCIL 12/12/2000