

Chief Executive: Bob Marshall

Director: Bob Gwilliam
Director: Jeff Penfold

Replies to:
P.L. Jeremiah LL.B.
Solicitor to the Council
Monkton Park
CHIPPENHAM
Wiltshire SN15 1ER

Tel: Chippenham (01249) 706111 Ext 593
Fax: Chippenham (01249) 443152
DX No. 34208 Chippenham

Enquiries to: R J Packer
Our Ref: RJP\CG E98.0099
Your Ref:

E.98.0099

Planning
Register

plotted 18/4/01
*North
Wiltshire
District
Council*

27 November, 2000

DEVELOPMENT CONTROL	
28 NOV 2000	
PASSED TO	DATE REC.



Dear Sir or Madam

ENFORCEMENT NOTICE – LAND AT CHELWORTH LODGE, CRICKLADE, WILTSHIRE

The Council have issued an Enforcement Notice relating to the above Land and I now serve on you copies of this Notice, in view of your interest in the Land.

Unless an appeal is made, as set out in the Annex, the Notice will take effect on the date shown in Paragraph 7 of the Notice and you must ensure that the required steps for which you may be held responsible are taken within the period or periods specified.

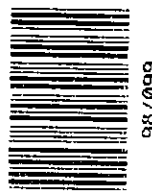
Yours faithfully



SOLICITOR TO THE COUNCIL

To Mr Alan Olding
Chelworth Lodge
Cricklade
Wiltshire
SN6 6HB

Mrs Maureen Olding
Chelworth Lodge
Cricklade
Wiltshire
SN6 6HB

Mr G Godsell
CAV Ltd
Old Mill House
Beeches Road
Cirencester
Glos GL7 1DN

Lloyds Bank plc
High Street
Cricklade
Wiltshire
SN6 3HB



INVESTOR IN PEOPLE

E98.0099

IMPORTANT - THIS COMMUNICATION AFFECTS YOUR PROPERTY

**TOWN AND COUNTRY PLANNING ACT 1990
(as amended by the Planning and Compensation Act 1991)**

ENFORCEMENT NOTICE

ISSUED BY: North Wiltshire District Council

1. **THIS NOTICE** is issued by the Council because it appears to them that there has been a breach of planning control, within paragraph (a) of section 171A(1) of the above Act, at the land described below. They consider that it is expedient to issue this notice, having regard to the provisions of the development plan and to other material planning considerations. The Annex at the end of the notice and the enclosures to which it refers contain important additional information.
2. **THE LAND TO WHICH THE NOTICE RELATES**

Land at Chelworth Lodge, Cricklade, Wiltshire shown shaded on the attached plan and marked "THE SITE REFERRED TO".
3. **THE MATTERS WHICH APPEAR TO CONSTITUTE THE BREACH OF PLANNING CONTROL**

Without planning permission, change of use of the land from agricultural use to use for the parking and storage of vehicles.
4. **REASONS FOR ISSUING THIS NOTICE**
 - a) It appears to the Council that the above breach of planning control has occurred within the last ten years.
 - b) The parking and storage of vehicles on the land is detrimental to the appearance and character of the open countryside, contrary to policies E15 and C7 of the adopted North Wiltshire Local Plan and policy RE19 of the emerging North Wiltshire Local Plan Review.

5. WHAT YOU ARE REQUIRED TO DO

- a) Stop using that part of the land to the west of the line marked X – Y on the attached plan for the parking and storage of vehicles.
- b) Erect along the whole length of the line X – Y a timber post and three rail fence with an overall height of 1.4 metres. Within this fence-line, there shall be three (3) field gates, each having a maximum width of 4.3 metres. The said three gates shall be positioned at the points marked 'a', 'b' and 'c' on the attached plan.

6. TIME FOR COMPLIANCE

- a) 5 months after this notice takes effect.
- b) 5 months after this notice takes effect.

7. WHEN THIS NOTICE TAKES EFFECT

This notice takes effect on 31 December 2000 unless an appeal is made against it beforehand.

Dated : 27 November 2000

Signed : *P. L. Teremianah*

on behalf of North Wiltshire District Council

ANNEX

YOUR RIGHT OF APPEAL

You can appeal against this notice, but any appeal must be received, or posted in time to be **received**, by the Secretary of State **before** the date specified in paragraph 7 of the notice. The enclosed booklet "Enforcement Notice Appeals - A Guide to Procedure" sets out your rights. You may use the enclosed appeal forms.

- (a) One is for you to send to the Secretary of State if you decide to appeal, together with a copy of this enforcement notice.
- (b) The second copy of the appeal form should be sent to the Council.
- (c) The third copy is for your own records.

WHAT HAPPENS IF YOU DO NOT APPEAL

If you do not appeal against this enforcement notice, it will take effect on the date specified in paragraph 7 of the notice and you must then ensure that the required steps for complying with it, for which you may be held responsible, are taken within the period specified in paragraph 6 of the notice. Failure to comply with an enforcement notice which has taken effect can result in prosecution and/or remedial action by the Council.

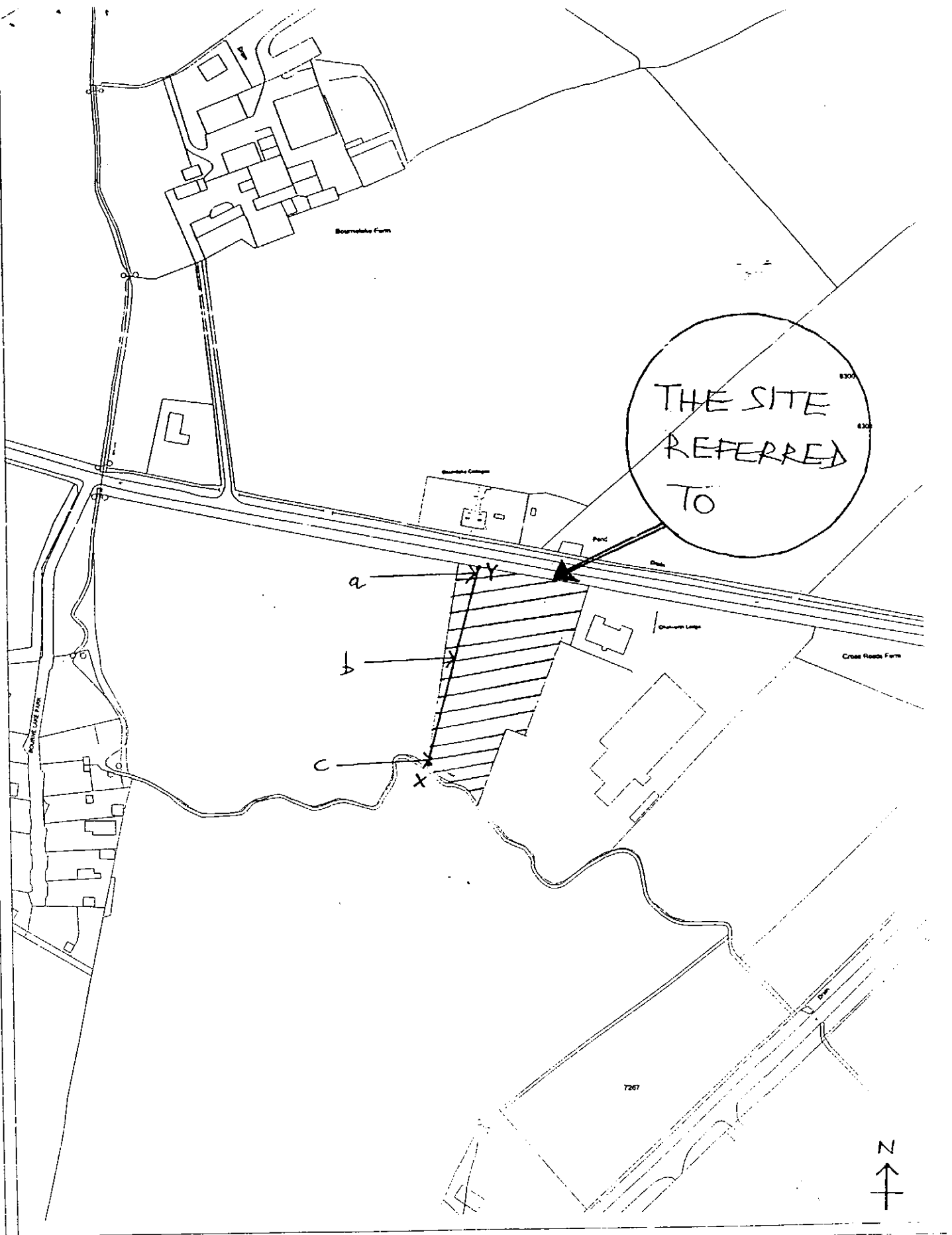

*North
Wiltshire
District
Council*

Land at Chelworth Lodge Cricklade
SCALE: 1:2500

GRID REF. SU 0767 9292

20/10/20

Reproduced from the Ordnance Survey mapping with the permission of Her Majesty's Stationary Office
© Crown Copyright. Unauthorised reproduction infringes Crown Copyright and may lead to prosecution or civil proceedings.
NORTH WILTSHIRE DISTRICT COUNCIL - LA078840 2000

Chief Executive: Bob Marshall

Director: Bob Gwilliam
Director: Jeff Penfold

Replies to:

P.L. Jeremiah LL.B.
Solicitor to the Council
Monkton Park
CHIPPENHAM
Wiltshire SN15 1ER

Tel: Chippenham (01249) 706111 Ext 593
Fax: Chippenham (01249) 443152
DX No. 34208 Chippenham

Enquiries to: R J Packer
Our Ref: RJP\CG E98.0099
Your Ref:

North Wiltshire District Council

18 January, 2000

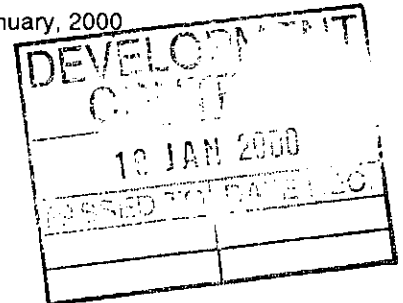

Handwritten:
S. Auld
N. Steel
JA
24/1

Dear Sir or Madam

ENFORCEMENT NOTICE – LAND AT CHELWORTH LODGE, CRICKLADE, WILTSHIRE

The Council have issued an Enforcement Notice relating to the above Land and I now serve on you copies of this Notice, in view of your interest in the Land.

Unless an appeal is made, as set out in the Annex, the Notice will take effect on the date shown in Paragraph 7 of the Notice and you must ensure that the required steps for which you may be held responsible are taken within the period or periods specified.

Yours faithfully

SOLICITOR TO THE COUNCIL

To	Mr Alan Olding Chelworth Lodge Cricklade Wiltshire SN6 6HB	Mrs Maureen Olding Chelworth Lodge Cricklade Wiltshire SN6 6HB	Mr G Godsell CAV Ltd Old Mill House Beeches Road Cirencester Glos GL7 1DN	Lloyds Bank plc High Street Cricklade Wiltshire SN6 3HB
----	--	--	--	---



INVESTOR IN PEOPLE

IMPORTANT - THIS COMMUNICATION AFFECTS YOUR PROPERTY

**TOWN AND COUNTRY PLANNING ACT 1990
(as amended by the Planning and Compensation Act 1991)**

ENFORCEMENT NOTICE

ISSUED BY: North Wiltshire District Council

1. **THIS NOTICE** is issued by the Council because it appears to them that there has been a breach of planning control, within paragraph (a) of section 171A(1) of the above Act, at the land described below. They consider that it is expedient to issue this notice, having regard to the provisions of the development plan and to other material planning considerations. The Annex at the end of the notice and the enclosures to which it refers contain important additional information.

2. **THE LAND TO WHICH THE NOTICE RELATES**

Land at Chelworth Lodge, Cricklade, Wiltshire shown shaded on the attached plan and marked "THE SITE REFERRED TO".

3. **THE MATTERS WHICH APPEAR TO CONSTITUTE THE BREACH OF PLANNING CONTROL**

Without planning permission, change of use of the land from agricultural use to use for the parking and storage of vehicles.

4. **REASONS FOR ISSUING THIS NOTICE**

- a) It appears to the Council that the above breach of planning control has occurred within the last ten years.
- b) The parking and storage of vehicles on the land is detrimental to the appearance and character of the open countryside, contrary to policies E15 and C7 of the adopted North Wiltshire Local Plan and policy RE19 of the emerging North Wiltshire Local Plan Review.

5. WHAT YOU ARE REQUIRED TO DO

- a) Remove all parked or stored vehicles from that part of the land to the west of the line marked C – D on the attached plan.
- b) Stop using that part of the land to the west of the line marked C – D on the attached plan for the parking and storage of vehicles.
- c) Reinststate that part of the land to the west of the line marked A – B on the attached plan to a condition suitable for agricultural use by restoring it as grassland.
- d) Submit to the Council, for their written approval, proposals for landscaping, including maintenance and a programme of implementation, of the area between the lines marked A – B and C – D on the attached plan.
- e) Carry out the proposals submitted in accordance with step d) above as approved in writing by the Council.

6. TIME FOR COMPLIANCE

- a) 6 months after this notice takes effect.
- b) 6 months after this notice takes effect.
- c) 12 months after this notice takes effect.
- d) 3 months after this notice takes effect.
- e) In accordance with the proposals as approved by the Council.

7. WHEN THIS NOTICE TAKES EFFECT

This notice takes effect on 29 February 2000 unless an appeal is made against it beforehand.

Dated : 18 January 2000

Signed : *P. L. Tereuriah*

on behalf of North Wiltshire District Council

ANNEX

YOUR RIGHT OF APPEAL

You can appeal against this notice, but any appeal must be received, or posted in time to be **received**, by the Secretary of State **before** the date specified in paragraph 7 of the notice. The enclosed booklet "Enforcement Notice Appeals - A Guide to Procedure" sets out your rights. You may use the enclosed appeal forms.

- (a) One is for you to send to the Secretary of State if you decide to appeal, together with a copy of this enforcement notice.
- (b) The second copy of the appeal form should be sent to the Council.
- (c) The third copy is for your own records.

WHAT HAPPENS IF YOU DO NOT APPEAL

If you do not appeal against this enforcement notice, it will take effect on the date specified in paragraph 7 of the notice and you must then ensure that the required steps for complying with it, for which you may be held responsible, are taken within the period specified in paragraph 6 of the notice. Failure to comply with an enforcement notice which has taken effect can result in prosecution and/or remedial action by the Council.

PLANNING ENFORCEMENT NOTICE

Land at Chelworth Lodge CRICKLADE

E.98.0099

