

Chief Executive: Bob Marshall

Director: David Button
Director: Bob Gwilliam
Director: Jeff Penfold

Replies to:
P.L. Jeremiah LL.B.
Solicitor to the Council
Monkton Park
CHIPPENHAM
Wiltshire SN15 1ER

Tel: Chippenham (01249) 706598
Fax: Chippenham (01249) 443152
DX No. 34208

Enquiries to: R J Packer
Our Ref: RJP\CG E98.0058
Your Ref:

E98.0058
*North
Wiltshire
District
Council*

11 June 1998

*Plotting
Office*

Dear Sir/Madam

ENFORCEMENT NOTICES AT THE OAKS, LACOCK, WILTSHIRE

The Council have issued an Enforcement Notice relating to the above Land and I now serve on you a copy of this Notice, in view of your interest in the Land.

Unless an appeal is made, as set out in the Annex, the Notice will take effect on the date shown in Paragraph 7 of the Notice and you must ensure that the required steps for which you may be held responsible are taken within the period or periods specified.

Yours faithfully



f SOLICITOR TO THE COUNCIL

Letter sent to:-

Mrs E J Hopkins
The Oaks
Melksham Road
Lacock
Wiltshire
SN15 2LW

Mr G Patterson
Hawcroft
Holt
Trowbridge
Wiltshire

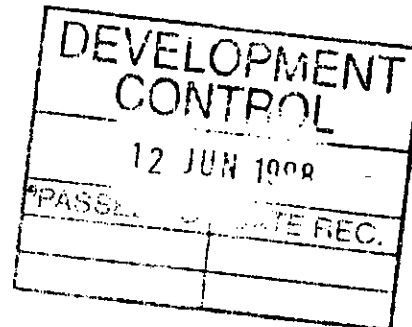

INVESTOR IN PEOPLE

Ed8.0028

E98.0058

IMPORTANT - THIS COMMUNICATION AFFECTS YOUR PROPERTY

**TOWN AND COUNTRY PLANNING ACT 1990
(as amended by the Planning and Compensation Act 1991)**

ENFORCEMENT NOTICE

ISSUED BY: North Wiltshire District Council

1. **THIS NOTICE** is issued by the Council because it appears to them that there has been a breach of planning control, within paragraph (a) of section 171A(1) of the above Act, at the land described below. They consider that it is expedient to issue this notice, having regard to the provisions of the development plan and to other material planning considerations. The Annex at the end of the notice and the enclosures to which it refers contain important additional information.

2. **THE LAND TO WHICH THE NOTICE RELATES**

Land at Melksham Road, Lacock, Wiltshire shown shaded on the attached plan.

3. **THE MATTERS WHICH APPEAR TO CONSTITUTE THE BREACH OF PLANNING CONTROL**

Without planning permission, change of use of the land from use for the storage of caravans to use for car sales and preparation of vehicles for sale, including the repair of vehicles.

4. **REASONS FOR ISSUING THIS NOTICE**

(i) It appears to the Council that the above breach of planning control has occurred within the last ten years. It is considered that use of land for vehicle preparation and car sales is inappropriate in an area of open countryside and at the side of a main traffic route into an historic settlement. The development does not, therefore, accord with the provisions of Policy C7 of the adopted North Wiltshire Local Plan, as endorsed by Policy RC9 of the North Wiltshire Local Plan Review, and adversely affects the character and setting of the nearby village of Lacock and visual amenity in an area of attractive countryside.

(ii) The development has no provision for on-site customer parking, and vehicles parking on the public highway, on a section of road where there is no speed limit in force, would be likely to interrupt the free flow of traffic and prejudice the safety of road users at this point.

5. WHAT YOU ARE REQUIRED TO DO

(i) Stop using the land for the sale, preparation for sale or repair of motor vehicles.

(ii) Remove from the land all vehicles, tools, equipment and any other item of a similar nature associated with car sales and repair, together with the mobile office and all advertisement hoardings.

6. TIME FOR COMPLIANCE

Six months after this Notice takes effect.

7. WHEN THIS NOTICE TAKES EFFECT

This notice takes effect on **21 July 1998** unless an appeal is made against it beforehand.

Dated : 9 June, 1998

Signed : *P. L. Jeremiah*

on behalf of North Wiltshire District Council

ANNEX

YOUR RIGHT OF APPEAL

You can appeal against this notice, but any appeal must be received, or posted in time to be **received**, by the Secretary of State **before** the date specified in paragraph 7 of the notice. The enclosed booklet "Enforcement Notice Appeals - A Guide to Procedure" sets out your rights. You may use the enclosed appeal forms.

- (a) One is for you to send to the Secretary of State if you decide to appeal, together with a copy of this enforcement notice.
- (b) The second copy of the appeal form and the notice should be sent to the Council.
- (c) The third copy is for your own records.

WHAT HAPPENS IF YOU DO NOT APPEAL

If you do not appeal against this enforcement notice, it will take effect on the date specified in paragraph 7 of the notice and you must then ensure that the required steps for complying with it, for which you may be held responsible, are taken within the period specified in paragraph 6 of the notice. Failure to comply with an enforcement notice which has taken effect can result in prosecution and/or remedial action by the Council.

North Wiltshire District Council

ENFORCEMENT NOTICE

SITE PLAN

PROPERTY ADDRESS:

Land At
Melksham Road
Lacock
Chippenham
Wiltshire

REFERENCE:

E.98.0058

GRID REFERENCE:

ST9159 6803

DESCRIPTION:

Change of use of land from
use for the storage of
caravans to use for car sales
and preparation of vehicles
for sale. Including the repair
of vehicles.

KEY

Site Referred To
Shaded

SCALE: 1:2500

DATE: 29/05/98

Drawn By CG/GIS

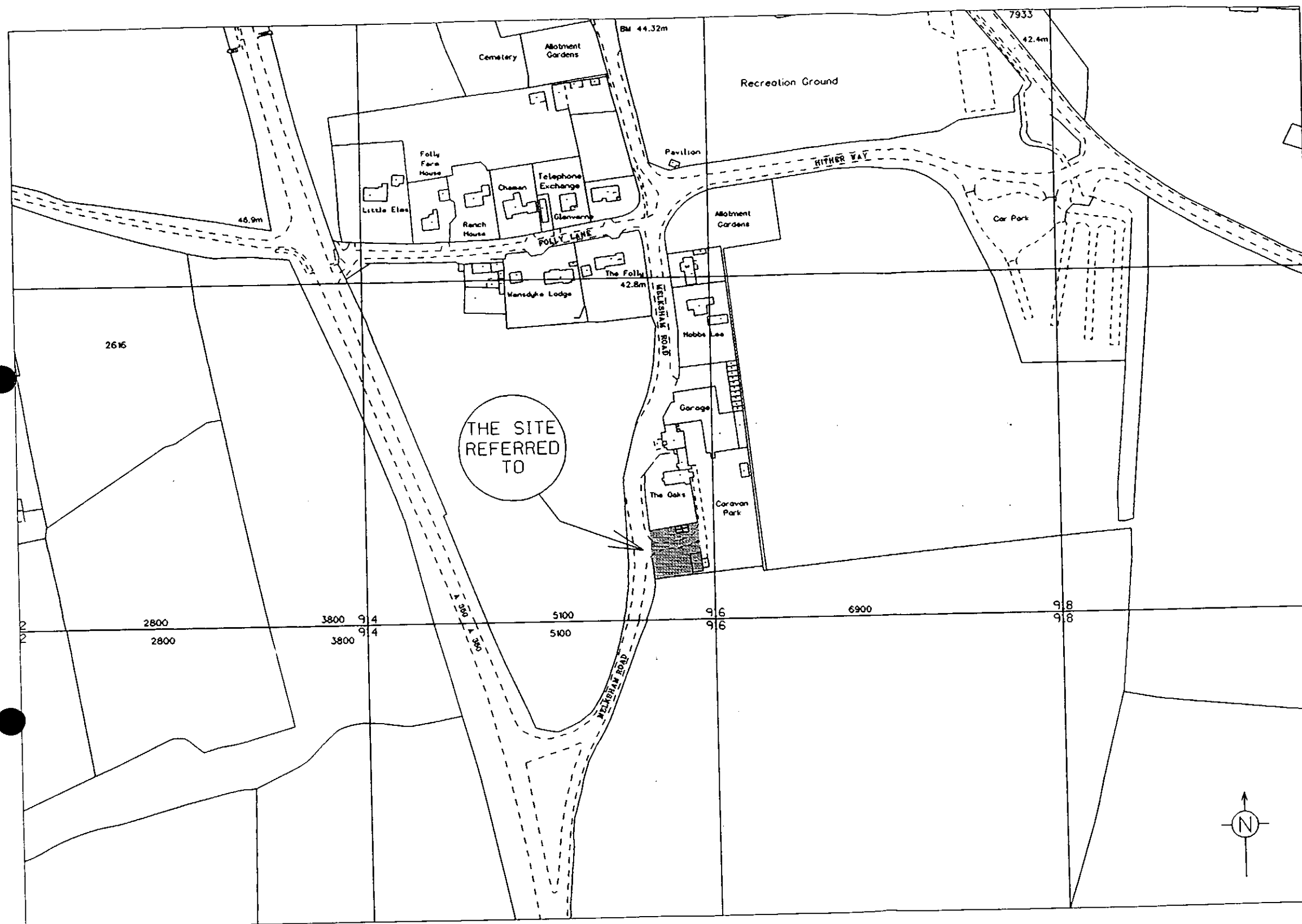

REPRODUCED FROM THE ORDNANCE SURVEY MAPPING WITH THE PERMISSION OF THE CONTROLLER OF HER MAJESTY'S STATIONERY OFFICE
CROWN COPYRIGHT

UNAUTHORISED REPRODUCTION INFRINGES CROWN COPYRIGHT AND MAY LEAD TO PROSECUTION OR CIVIL PROCEEDINGS
THIS COPY HAS BEEN PRODUCED SPECIFICALLY FOR PLANNING AND BUILDING CONTROL PURPOSES ONLY NO FURTHER COPIES MAY BE MADE
NORTH WILTSHIRE DISTRICT COUNCIL - LA078840 1997

Chief Executive: Bob Marshall

Director: David Button
Director: Bob Gwilliam
Director: Jeff Penfold

Replies to:
P.L. Jeremiah LL.B.
Solicitor to the Council
Monkton Park
CHIPPENHAM
Wiltshire SN15 1ER

Tel: Chippenham (01249) 706598
Fax: Chippenham (01249) 443152
DX No. 34208

Enquiries to: R J Packer
Our Ref: RJP/CG E98.0058
Your Ref:

Dear Sir/Madam

ENFORCEMENT NOTICES AT THE OAKS, LACOCK, WILTSHIRE

The Council have issued an Enforcement Notice relating to the above Land and I now serve on you a copy of this Notice, in view of your interest in the Land.

Unless an appeal is made, as set out in the Annex, the Notice will take effect on the date shown in Paragraph 7 of the Notice and you must ensure that the required steps for which you may be held responsible are taken within the period or periods specified.

Yours faithfully



f SOLICITOR TO THE COUNCIL

Letter sent to:-

Mrs E J Hopkins
The Oaks
Melksham Road
Lacock
Wiltshire
SN15 2LW

Mr G Patterson
Hawcroft
Holt
Trowbridge
Wiltshire



Fri - G. G. G. G. G.
**North
Wiltshire
District
Council**

11 June 1998



INVESTOR IN PEOPLE

**IMPORTANT - THIS COMMUNICATION
AFFECTS YOUR PROPERTY**

**TOWN AND COUNTRY PLANNING ACT 1990
(as amended by the Planning and Compensation Act 1991)**

ENFORCEMENT NOTICE

ISSUED BY: North Wiltshire District Council

1. **THIS NOTICE** is issued by the Council because it appears to them that there has been a breach of planning control, within paragraph (a) of section 171A(1) of the above Act, at the land described below. They consider that it is expedient to issue this notice, having regard to the provisions of the development plan and to other material planning considerations. The Annex at the end of the notice and the enclosures to which it refers contain important additional information.
2. **THE LAND TO WHICH THE NOTICE RELATES**

Land at Melksham Road, Lacock, Wiltshire shown shaded on the attached plan.
3. **THE MATTERS WHICH APPEAR TO CONSTITUTE THE BREACH OF PLANNING CONTROL**

Without planning permission, change of use of the land from use for the storage of caravans to use for car sales and preparation of vehicles for sale, including the repair of vehicles.
4. **REASONS FOR ISSUING THIS NOTICE**

(i) It appears to the Council that the above breach of planning control has occurred within the last ten years. It is considered that use of land for vehicle preparation and car sales is inappropriate in an area of open countryside and at the side of a main traffic route into an historic settlement. The development does not, therefore, accord with the provisions of Policy C7 of the adopted North Wiltshire Local Plan, as endorsed by Policy RC9 of the North Wiltshire Local Plan Review, and adversely affects the character and setting of the nearby village of Lacock and visual amenity in an area of attractive countryside.

(ii) The development has no provision for on-site customer parking, and vehicles parking on the public highway, on a section of road where there is no speed limit in force, would be likely to interrupt the free flow of traffic and prejudice the safety of road users at this point.

5. WHAT YOU ARE REQUIRED TO DO

(i) Stop using the land for the sale, preparation for sale or repair of motor vehicles.

(ii) Remove from the land all vehicles, tools, equipment and any other item of a similar nature associated with car sales and repair, together with the mobile office and all advertisement hoardings.

6. TIME FOR COMPLIANCE

Six months after this Notice takes effect.

7. WHEN THIS NOTICE TAKES EFFECT

This notice takes effect on **21 July 1998** unless an appeal is made against it beforehand.

Dated : 9 June, 1998

Signed : *P. L. Jeremiah*

on behalf of North Wiltshire District Council

ANNEX

YOUR RIGHT OF APPEAL

You can appeal against this notice, but any appeal must be received, or posted in time to be **received**, by the Secretary of State **before** the date specified in paragraph 7 of the notice. The enclosed booklet "Enforcement Notice Appeals - A Guide to Procedure" sets out your rights. You may use the enclosed appeal forms.

- (a) One is for you to send to the Secretary of State if you decide to appeal, together with a copy of this enforcement notice.
- (b) The second copy of the appeal form and the notice should be sent to the Council.
- (c) The third copy is for your own records.

WHAT HAPPENS IF YOU DO NOT APPEAL

If you do not appeal against this enforcement notice, it will take effect on the date specified in paragraph 7 of the notice and you must then ensure that the required steps for complying with it, for which you may be held responsible, are taken within the period specified in paragraph 6 of the notice. Failure to comply with an enforcement notice which has taken effect can result in prosecution and/or remedial action by the Council.

North Wiltshire District Council

ENFORCEMENT NOTICE

SITE PLAN

PROPERTY ADDRESS:

Land At
Melksham Road
Lacock
Chippenham
Wiltshire

REFERENCE:

E.98.0058

GRID REFERENCE:

ST9159 6803

DESCRIPTION:

Change of use of land from
use for the storage of
caravans to use for car sales
and preparation of vehicles
for sale. Including the repair
of vehicles.

KEY

Site Referred To
Shaded

SCALE: 1:2500

DATE: 29/05/98

Drawn By CG/GIS

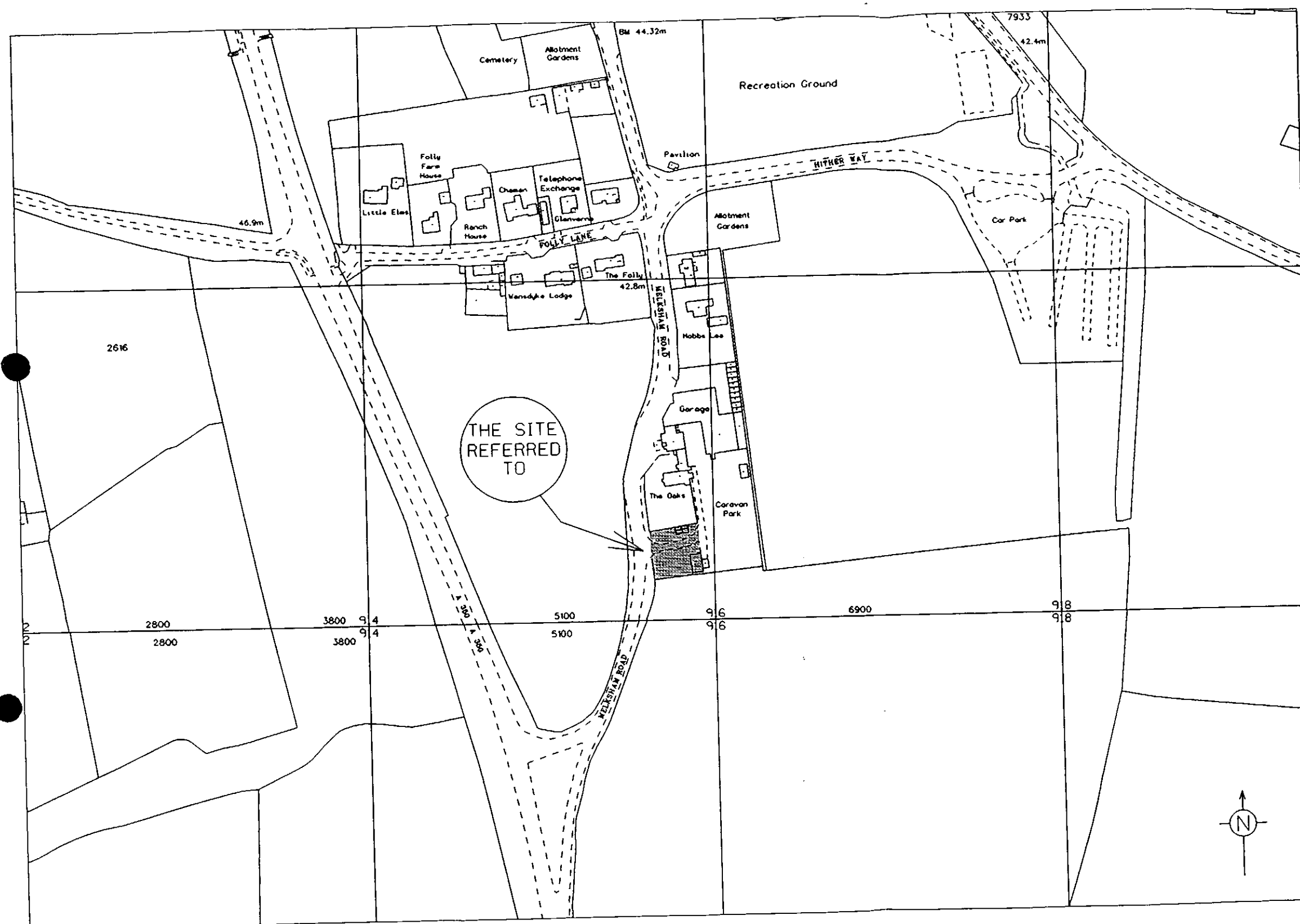

REPRODUCED FROM THE ORDNANCE SURVEY MAPPING WITH THE PERMISSION OF THE CONTROLLER OF HER MAJESTY'S STATIONERY OFFICE
CROWN COPYRIGHT

UNAUTHORISED REPRODUCTION INFRINGES CROWN COPYRIGHT AND MAY LEAD TO PROSECUTION OR CIVIL PROCEEDINGS
THIS COPY HAS BEEN PRODUCED SPECIFICALLY FOR PLANNING AND BUILDING CONTROL PURPOSES ONLY NO FURTHER COPIES MAY BE MADE
NORTH WILTSHIRE DISTRICT COUNCIL - LA078840 1997