

IMPORTANT

THIS COMMUNICATION AFFECTS YOUR PROPERTY

Solicitor to the Council
P L Jeremiah LL.B

Monkton Park, Chippenham
Wiltshire SN15 1 ER
Telephone (01249)706594
Our Ref: E97.0354



E.97.0354
Plotting
Office. *North*
Wiltshire
District
Council

plotted 10/10/00

23 December 1999

Dear Sir/Madam

PLANNING (LISTED BUILDING AND CONSERVATION AREAS) ACT 1990 LISTED BUILDING ENFORCEMENT NOTICE

Corner Farm, Purton Stoke, Purton, Wiltshire

The Council have issued an Listed Building Enforcement Notice relating to the above land and I now serve on you a copy of that Notice, in view of your interest in the land. Unless an appeal is made to the Secretary of State as described below, the Notice will take effect on the date shown below and you must then ensure that the required steps for which you may be held responsible are taken within the period or periods specified in the Notice.

If you wish to appeal against the Notice, you or your agent should complete the enclosed appeal forms and send one to the Planning Inspectorate, Room 11/11(3), Tollgate House, Houlton Street, Bristol BS2 9DJ setting out the grounds of your appeal and, in brief, the facts on which you rely for support. The statutory grounds of appeal available are set out in Section 39 of the Act, which I copy to you. Any appeal should have with it the extra copy of the Notice that I have provided. A copy of the appeal form should be sent to the Council. **AN APPEAL SHOULD BE RECEIVED BY THE PLANNING INSPECTORATE AND THE COUNCIL BEFORE THE NOTICE TAKES EFFECT OR THE APPEAL WILL BE INVALID.**

There is a requirement on the Council to specify the reasons why the local planning authority consider it expedient to issue the Notice and these reasons are set out in the Notice.

Yours faithfully

P. L. Jeremiah

SOLICITOR TO THE COUNCIL

DATE ON WHICH THE NOTICE TAKES EFFECT AND BEFORE WHICH ANY APPEAL MUST BE RECEIVED 3 February 2000

To	Mr P Araujo	Mrs B Araujo
	Corner Farm	Corner Farm
	Purton Stoke	Purton Stoke
	Purton	Purton
	Wiltshire	Wiltshire

E97.0354

PLANNING (LISTED BUILDING AND CONSERVATION AREAS) ACT 1990

LISTED BUILDING ENFORCEMENT NOTICE

CORNER FARM, PURTON STOKE, PURTON, WILTSHIRE

WHEREAS

It appears to the North Wiltshire District Council ("the Council") being the local planning authority for the purposes of Section 38 of the Planning (Listed Buildings and Conservation Areas) Act 1990 ("the Act") in this matter, that works have been or are being executed to the listed building, described in Schedule 1 overleaf, such as to involve a contravention of Section 9 of the Act.

The contravention which appears to have taken place is described in Schedule 2 overleaf.

The Council consider it expedient, having regard to the effect of the said works on the character of the listed building as one of special architectural or historic interest and to all other material considerations, to issue this listed building enforcement notice, in exercise of their powers in the said Section 38 for the reasons set out in this notice.

NOTICE IS HEREBY GIVEN that the Council require that the steps specified in Schedule 3 overleaf be taken for the purposes set out in that Schedule within the period or periods there specified from the date on which this notice takes effect.

Subject to the provisions of Section 39 of the Act

THIS NOTICE SHALL TAKE EFFECT on 3 FEBRUARY 2000

Signed *P. L. Jermin* SOLICITOR TO THE COUNCIL

Date 23 December 1999

Monkton Park, Chippenham
Wiltshire SN15 1ER

SCHEDULE 1 – THE LAND TO WHICH THIS NOTICE RELATES

Corner Farm, Purton Stoke, Purton, Wiltshire ("the Listed Building").

SCHEDULE 2 – THE CONTRAVENTION

Unauthorised works to the animal pen within the curtilage of the Listed Building (shown shaded on the attached plan) comprising the following:-

- a) alteration to the roof structure of the animal pen with a reduction in the roof pitch to the front roof slope and associated raising of the level of the eaves to the front elevation;
- b) infilling of the gable elevation and front elevation of the animal pen with stonework;
- c) replacement of the corrugated tin roof on the animal pen with natural slate roofing material.

SCHEDULE 3 – STEPS REQUIRED TO BE TAKEN TO REMEDY THE BREACH

- a) Remove the natural slate roofing materials from the front slope of the animal pen, prop the roof as necessary and remove the modern roof structure.
- b) Remove the stonework from the gable elevation and front elevation to enable the original roof structure to be reinstated.
- c) Reinststate the original roof structure in species – matching timber with detailing to match that to rear elevation including roof trusses, wall plate and ties.
- d) Re-roof the front roof slope in corrugated tin, weathered at the abutment to the cart shed with code 3 soakers and code 4 flashings; reinststate existing ridge tiles and provide and fix cast-iron rainwater goods.

TIME FOR COMPLIANCE – TWO MONTHS

North Wiltshire District Council

ENFORCEMENT NOTICE

SITE PLAN

PROPERTY ADDRESS:

Corner Farm
Purton Stoke
Purton Wiltshire

REFERENCE:
N.98.1652

KEY:
Site referred to
shaded grey

OFFICER DEALING - JE
SCALE: 1:1250
GRID REF: SU0990
DATE: 30/06/99

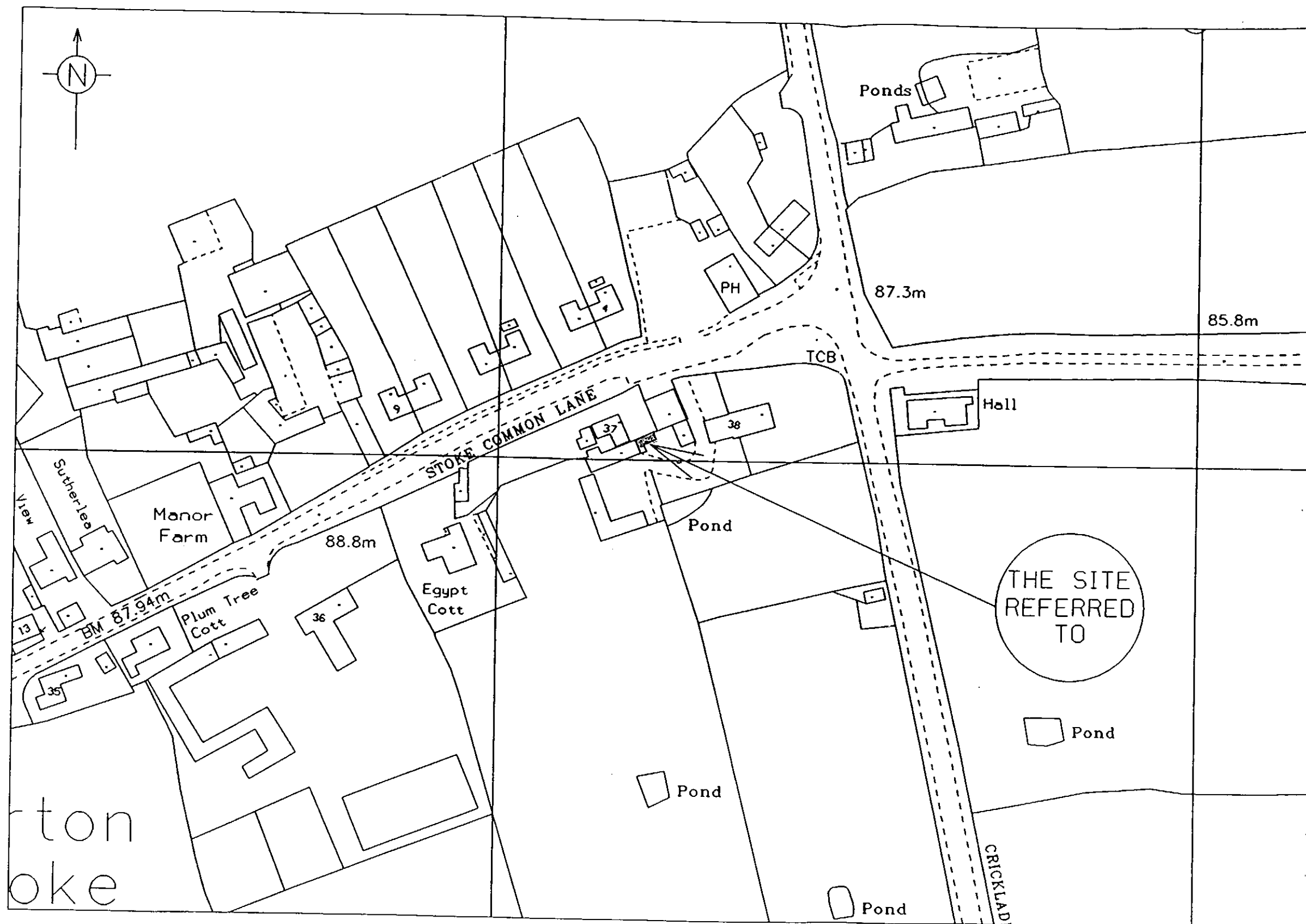

IMPORTANT

THIS COMMUNICATION AFFECTS YOUR PROPERTY

Solicitor to the Council
P L Jeremiah LL.B

Monkton Park, Chippenham
Wiltshire SN15 1 ER
Telephone (01249)706594
Our Ref: E97.0354

D Araujo *North* *→* *Fri*
Wiltshire
District
Council

23 December 1999

Dear Sir/Madam

PLANNING (LISTED BUILDING AND CONSERVATION AREAS) ACT 1990 LISTED BUILDING ENFORCEMENT NOTICE

Corner Farm, Purton Stoke, Purton, Wiltshire

The Council have issued an Listed Building Enforcement Notice relating to the above land and I now serve on you a copy of that Notice, in view of your interest in the land. Unless an appeal is made to the Secretary of State as described below, the Notice will take effect on the date shown below and you must then ensure that the required steps for which you may be held responsible are taken within the period or periods specified in the Notice.

If you wish to appeal against the Notice, you or your agent should complete the enclosed appeal forms and send one to the Planning Inspectorate, Room 11/11(3), Tollgate House, Houlton Street, Bristol BS2 9DJ setting out the grounds of your appeal and, in brief, the facts on which you rely for support. The statutory grounds of appeal available are set out in Section 39 of the Act, which I copy to you. Any appeal should have with it the extra copy of the Notice that I have provided. A copy of the appeal form should be sent to the Council. **AN APPEAL SHOULD BE RECEIVED BY THE PLANNING INSPECTORATE AND THE COUNCIL BEFORE THE NOTICE TAKES EFFECT OR THE APPEAL WILL BE INVALID.**

There is a requirement on the Council to specify the reasons why the local planning authority consider it expedient to issue the Notice and these reasons are set out in the Notice.

Yours faithfully

P. L. Jeremiah

SOLICITOR TO THE COUNCIL

DATE ON WHICH THE NOTICE TAKES EFFECT AND BEFORE WHICH ANY APPEAL MUST BE RECEIVED 3 February 2000

To	Mr P Araujo	Mrs B Araujo
	Corner Farm	Corner Farm
	Purton Stoke	Purton Stoke
	Purton	Purton
	Wiltshire	Wiltshire

E97.0354

PLANNING (LISTED BUILDING AND CONSERVATION AREAS) ACT 1990

LISTED BUILDING ENFORCEMENT NOTICE

CORNER FARM, PURTON STOKE, PURTON, WILTSHIRE

WHEREAS

It appears to the North Wiltshire District Council ("the Council") being the local planning authority for the purposes of Section 38 of the Planning (Listed Buildings and Conservation Areas) Act 1990 ("the Act") in this matter, that works have been or are being executed to the listed building, described in Schedule 1 overleaf, such as to involve a contravention of Section 9 of the Act.

The contravention which appears to have taken place is described in Schedule 2 overleaf.

The Council consider it expedient, having regard to the effect of the said works on the character of the listed building as one of special architectural or historic interest and to all other material considerations, to issue this listed building enforcement notice, in exercise of their powers in the said Section 38 for the reasons set out in this notice.

NOTICE IS HEREBY GIVEN that the Council require that the steps specified in Schedule 3 overleaf be taken for the purposes set out in that Schedule within the period or periods there specified from the date on which this notice takes effect.

Subject to the provisions of Section 39 of the Act

THIS NOTICE SHALL TAKE EFFECT on 3 FEBRUARY 2000

Signed *P. L. Jeremiah* **SOLICITOR TO THE COUNCIL**

Date 23 December 1999

Monkton Park, Chippenham
Wiltshire SN15 1ER

SCHEDULE 1 – THE LAND TO WHICH THIS NOTICE RELATES

Corner Farm, Purton Stoke, Purton, Wiltshire ("the Listed Building").

SCHEDULE 2 – THE CONTRAVENTION

Unauthorised works to the animal pen within the curtilage of the Listed Building (shown shaded on the attached plan) comprising the following:-

- a) alteration to the roof structure of the animal pen with a reduction in the roof pitch to the front roof slope and associated raising of the level of the eaves to the front elevation;
- b) infilling of the gable elevation and front elevation of the animal pen with stonework;
- c) replacement of the corrugated tin roof on the animal pen with natural slate roofing material.

SCHEDULE 3 – STEPS REQUIRED TO BE TAKEN TO REMEDY THE BREACH

- a) Remove the natural slate roofing materials from the front slope of the animal pen, prop the roof as necessary and remove the modern roof structure.
- b) Remove the stonework from the gable elevation and front elevation to enable the original roof structure to be reinstated.
- c) Reinstall the original roof structure in species – matching timber with detailing to match that to rear elevation including roof trusses, wall plate and ties.
- d) Re-roof the front roof slope in corrugated tin, weathered at the abutment to the cart shed with code 3 soakers and code 4 flashings; reinstall existing ridge tiles and provide and fix cast-iron rainwater goods.

TIME FOR COMPLIANCE – TWO MONTHS

North Wiltshire District Council

ENFORCEMENT NOTICE

SITE PLAN

PROPERTY ADDRESS:
Corner Farm
Purton Stoke
Purton Wiltshire

REFERENCE:
N.98.1652

KEY:
Site referred to
shaded grey

OFFICER DEALING - JE
SCALE: 1:1250
GRID REF: SU0990
DATE: 30/06/99

