

Chief Executive: Bob Marshall

Director: David Button
Director: Bob Gwilliam
Director: Jeff Penfold

Replies to:
P.L. Jeremiah LL.B.
Solicitor to the Council
Monkton Park
CHIPPENHAM
Wiltshire SN15 1ER

Tel: Chippenham (01249) 706598
Fax: Chippenham (01249) 443152
DX No. 34208

Enquiries to: R J Packer
Our Ref: RJP\CG E97.0039
Your Ref:

Dear Sir/Madam

ENFORCEMENT NOTICES AT THE BANKS, CHIPPENHAM ROAD, LYNEHAM, WILTSHIRE

The Council have issued an Enforcement Notice relating to the above Land and I now serve on you a copy of this Notice, in view of your interest in the Land.

Unless an appeal is made, as set out in the Annex, the Notice will take effect on the date shown in Paragraph 7 of the Notice and you must ensure that the required steps for which you may be held responsible are taken within the period or periods specified.

Yours faithfully

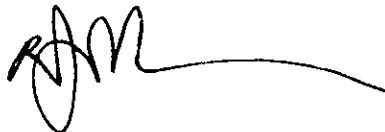

SOLICITOR TO THE COUNCIL

Letter sent to:-

Mr C R Mawlam
Over the Top
105-107 Chippenham Road
Lyneham
Wiltshire

Nationwide Building Society
47 Regent Street
Swindon
Wiltshire

North Wiltshire District Council

Planning
Office

DEVELOPMENT CONTROL	
05 MAY 1998	
PASSED TO	DATE REC.

1 May 1998



INVESTOR IN PEOPLE

E97.0039

IMPORTANT - THIS COMMUNICATION AFFECTS YOUR PROPERTY

**TOWN AND COUNTRY PLANNING ACT 1990
(as amended by the Planning and Compensation Act 1991)**

ENFORCEMENT NOTICE

ISSUED BY: North Wiltshire District Council

1. **THIS NOTICE** is issued by the Council because it appears to them that there has been a breach of planning control, within paragraph (a) of section 171A(1) of the above Act, at the land described below. They consider that it is expedient to issue this notice, having regard to the provisions of the development plan and to other material planning considerations. The Annex at the end of the notice and the enclosures to which it refers contain important additional information.

2. **THE LAND TO WHICH THE NOTICE RELATES**

Land at The Banks, Lyneham, Wiltshire shown shaded on the attached plan.

3. **THE MATTERS WHICH APPEAR TO CONSTITUTE THE BREACH OF PLANNING CONTROL**

Without planning permission, the construction of a scaffold tower in the position marked cross-hatched on the attached plan.

4. **REASONS FOR ISSUING THIS NOTICE**

It appears to the Council that the above breach of planning control has occurred within the last four years. The scaffold tower occupies a prominent and elevated location within the local landscape and, in the opinion of the Local Planning Authority, constitutes an alien and intrusive feature which is seriously detrimental to the rural character and appearance of the local environment.

5. **WHAT YOU ARE REQUIRED TO DO**

1. Dismantle the scaffold tower.

2. Remove all constituent parts of the tower (including camouflage nets) from the land.

6. TIME FOR COMPLIANCE

Eight weeks after this Notice takes effect.

7. WHEN THIS NOTICE TAKES EFFECT

This notice takes effect on 12 June 1998 unless an appeal is made against it beforehand.

Dated : 1 May 1998
Signed : P. L. Jeremiah

on behalf of North Wiltshire District Council

ANNEX

YOUR RIGHT OF APPEAL

You can appeal against this notice, but any appeal must be received, or posted in time to be received, by the Secretary of State **before** the date specified in paragraph 7 of the notice. The enclosed booklet "Enforcement Notice Appeals - A Guide to Procedure" sets out your rights. You may use the enclosed appeal forms.

- (a) One is for you to send to the Secretary of State if you decide to appeal, together with a copy of this enforcement notice.
- (b) The second copy of the appeal form and the notice should be sent to the Council.
- (c) The third copy is for your own records.

WHAT HAPPENS IF YOU DO NOT APPEAL

If you do not appeal against this enforcement notice, it will take effect on the date specified in paragraph 7 of the notice and you must then ensure that the required steps for complying with it, for which you may be held responsible, are taken within the period specified in paragraph 6 of the notice. Failure to comply with an enforcement notice which has taken effect can result in prosecution and/or remedial action by the Council.

North Wiltshire District Council

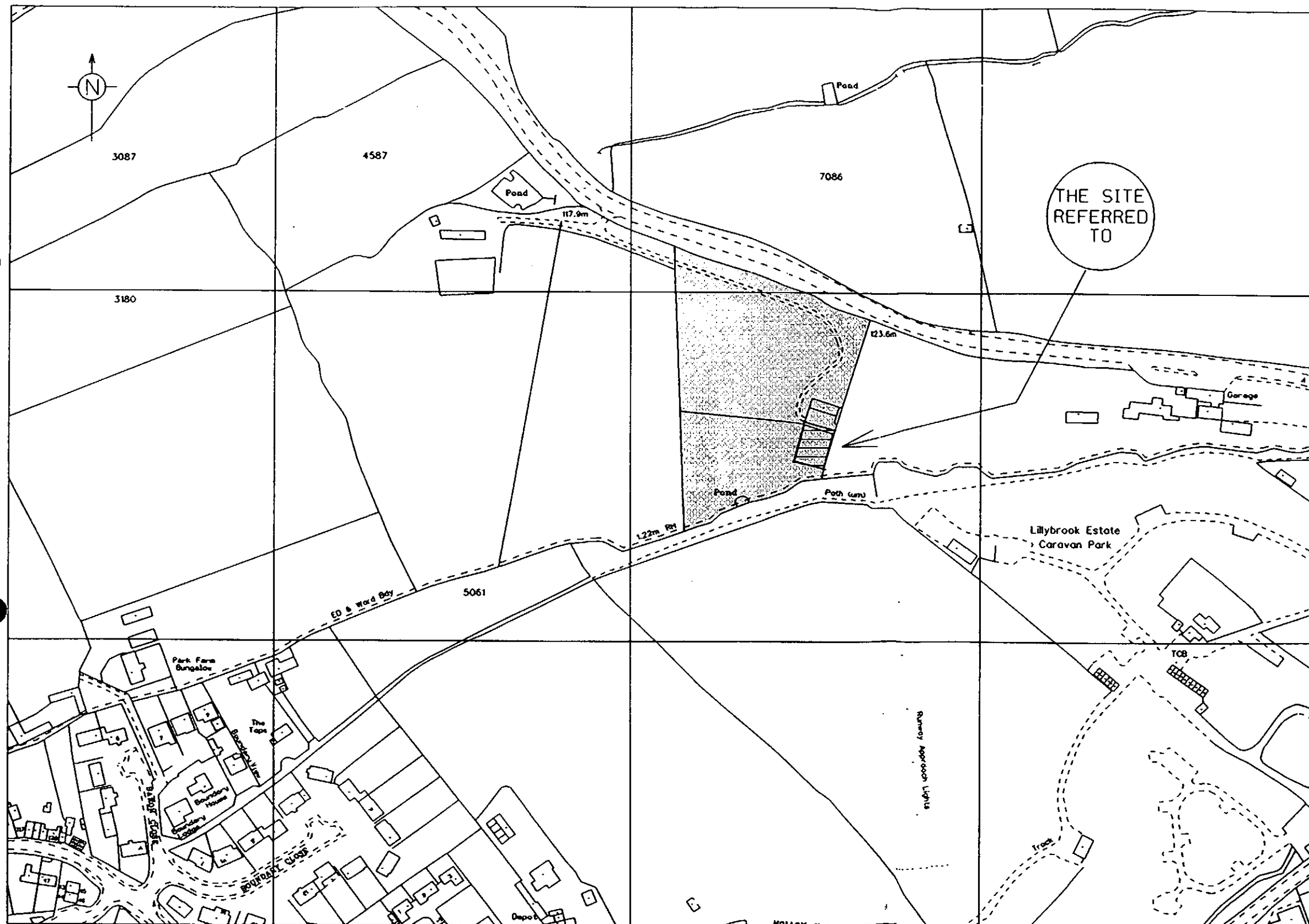

ENFORCEMENT NOTICE

SITE PLAN

PROPERTY ADDRESS:
Land comprising part of
OS Parcel 5774
B4069
Lynham
Wiltshire

REFERENCE:
E.97.0039

GRID REFERENCE:
SU 0070 7971

DESCRIPTION:

KEY

Land Referred To
Shaded
Site of Tower
Hatched

SCALE: 1:2500
DATE: 13/03/98
Drawn By JF/GIS

Chief Executive: Bob Marshall

Director: David Button
Director: Bob Gwilliam
Director: Jeff Penfold

Replies to:
P.L. Jeremiah LL.B.
Solicitor to the Council
Monkton Park
CHIPPENHAM
Wiltshire SN15 1ER

Tel: Chippenham (01249) 706598
Fax: Chippenham (01249) 443152
DX No. 34208

Enquiries to: R J Packer
Our Ref: RJP/CG E97.0039
Your Ref:

Dear Sir/Madam

ENFORCEMENT NOTICES AT THE BANKS, CHIPPENHAM ROAD, LYNEHAM, WILTSHIRE

The Council have issued an Enforcement Notice relating to the above Land and I now serve on you a copy of this Notice, in view of your interest in the Land.

Unless an appeal is made, as set out in the Annex, the Notice will take effect on the date shown in Paragraph 7 of the Notice and you must ensure that the required steps for which you may be held responsible are taken within the period or periods specified.

Yours faithfully

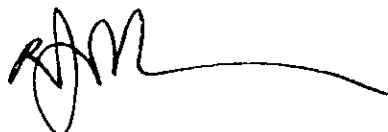

SOLICITOR TO THE COUNCIL

Letter sent to:-

Mr C R Mawlam
Over the Top
105-107 Chippenham Road
Lyneham
Wiltshire

Nationwide Building Society
47 Regent Street
Swindon
Wiltshire

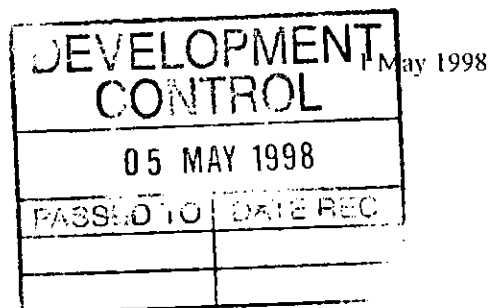

INVESTOR IN PEOPLE

E97.0039

IMPORTANT - THIS COMMUNICATION AFFECTS YOUR PROPERTY

**TOWN AND COUNTRY PLANNING ACT 1990
(as amended by the Planning and Compensation Act 1991)**

ENFORCEMENT NOTICE

ISSUED BY: North Wiltshire District Council

1. **THIS NOTICE** is issued by the Council because it appears to them that there has been a breach of planning control, within paragraph (a) of section 171A(1) of the above Act, at the land described below. They consider that it is expedient to issue this notice, having regard to the provisions of the development plan and to other material planning considerations. The Annex at the end of the notice and the enclosures to which it refers contain important additional information.

2. **THE LAND TO WHICH THE NOTICE RELATES**

Land at The Banks, Lyneham, Wiltshire shown shaded on the attached plan.

3. **THE MATTERS WHICH APPEAR TO CONSTITUTE THE BREACH OF PLANNING CONTROL**

Without planning permission, the construction of a scaffold tower in the position marked cross-hatched on the attached plan.

4. **REASONS FOR ISSUING THIS NOTICE**

It appears to the Council that the above breach of planning control has occurred within the last four years. The scaffold tower occupies a prominent and elevated location within the local landscape and, in the opinion of the Local Planning Authority, constitutes an alien and intrusive feature which is seriously detrimental to the rural character and appearance of the local environment.

5. **WHAT YOU ARE REQUIRED TO DO**

1. Dismantle the scaffold tower.

2. Remove all constituent parts of the tower (including camouflage nets) from the land.

6. TIME FOR COMPLIANCE

Eight weeks after this Notice takes effect.

7. WHEN THIS NOTICE TAKES EFFECT

This notice takes effect on 12 June 1998 unless an appeal is made against it beforehand.

Dated : 1 May 1998
Signed : P. L. Jeremiah

on behalf of North Wiltshire District Council

ANNEX

YOUR RIGHT OF APPEAL

You can appeal against this notice, but any appeal must be received, or posted in time to be **received**, by the Secretary of State **before** the date specified in paragraph 7 of the notice. The enclosed booklet "Enforcement Notice Appeals - A Guide to Procedure" sets out your rights. You may use the enclosed appeal forms.

- (a) One is for you to send to the Secretary of State if you decide to appeal, together with a copy of this enforcement notice.
- (b) The second copy of the appeal form and the notice should be sent to the Council.
- (c) The third copy is for your own records.

WHAT HAPPENS IF YOU DO NOT APPEAL

If you do not appeal against this enforcement notice, it will take effect on the date specified in paragraph 7 of the notice and you must then ensure that the required steps for complying with it, for which you may be held responsible, are taken within the period specified in paragraph 6 of the notice. Failure to comply with an enforcement notice which has taken effect can result in prosecution and/or remedial action by the Council.

North Wiltshire District Council

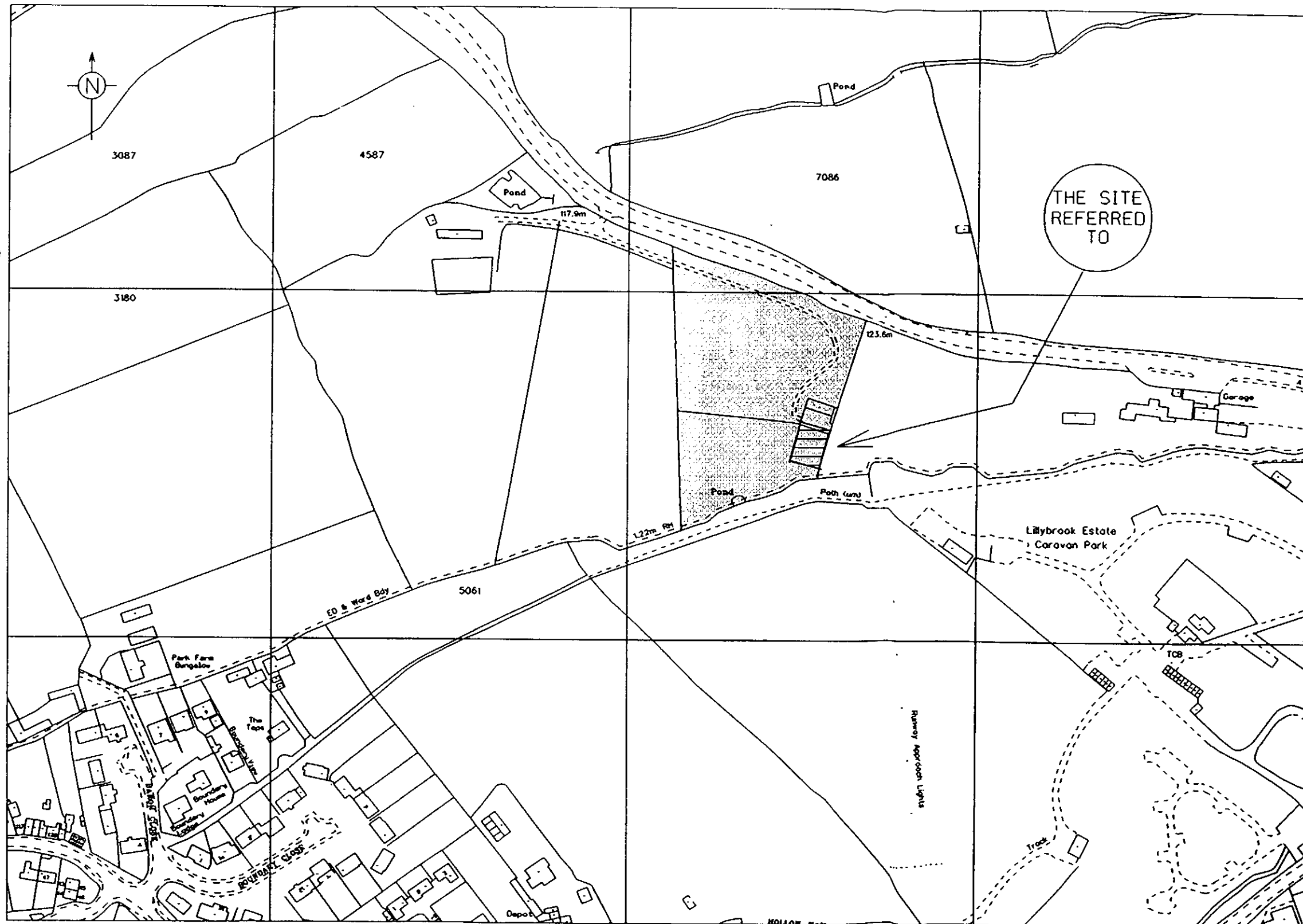

ENFORCEMENT NOTICE

SITE PLAN

PROPERTY ADDRESS:
Land comprising part of
OS Parcel 5774
B4069
Lyneham
Wiltshire

REFERENCE:

E.97.0039

GRID REFERENCE:

SU 0070 7971

DESCRIPTION:

KEY

Land Referred To
Shaded
Site of Tower
Hatched

SCALE: 1:2500

DATE: 13/03/98

Drawn By JF/GIS