

IMPORTANT

**THIS COMMUNICATION AFFECTS
YOUR PROPERTY**

Solicitor to the Council
P L Jeremiah LL.B

Our Ref: PT/CG E97.0021

25 November 1997

Dear Sir

TOWN AND COUNTY PLANNING ACT 1990

ENFORCEMENT NOTICE

Land at Barnsfield Farm, Hullavington, Wiltshire

The Council have issued an Enforcement Notice relating to the above land and I now serve on you a copy of that Notice, in view of your interest in the land. Unless an appeal is made to the Secretary of State as described below, the Notice will take effect on the date shown below and you must then ensure that the required steps for which you may be held responsible are taken within the period or periods specified in the Notice.

If you wish to appeal against the Notice, you should first read carefully the enclosed booklet entitled "Enforcement Notice Appeals - A Guide to Procedure". Then you or your agent should complete the enclosed appeal form and send it, together with the extra copy of the Enforcement Notice enclosed herewith, to the address on the appeal form. Your appeal must be received by the Planning Inspectorate before the notice takes effect.

There is a requirement on the Council to specify the reasons why the local planning authority consider it expedient to issue the Notice and these reasons are set out in the Notice.

Yours faithfully

P L Jeremiah

SOLICITOR TO THE COUNCIL

**DATE ON WHICH THE NOTICE TAKES EFFECT AND BEFORE WHICH ANY APPEAL
MUST BE RECEIVED 6 JANUARY 1998**

To Mr K Edwards
Cowbridge Farm
Malmesbury
Wiltshire
SN16 9LZ

Mr G W Small
38 Parklands
Hullavington
Wiltshire

NatWest Bank
High Street
Chippenham
Wiltshire

Monkton Park, Chippenham
Wiltshire SN15 1 ER
Telephone (01249) 706111(ex 594)

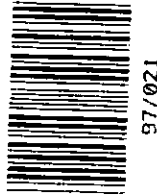

S. Hillier
*North
Wiltshire
District
Council*

E97.0021

TOWN AND COUNTRY PLANNING ACT 1990

ENFORCEMENT NOTICE

Land at Barnsfield Farm, Hullavington, Wiltshire

WHEREAS

1. It appears to the North Wiltshire District Council ("the Council") being the local planning authority for the purposes of Section 172 of the Town and Country Planning Act 1990 ("the Act") in this matter, that there has been a breach of planning control, under Section 171A(1)(a), within the last ten years on the land or premises ("the land") described in Schedule 1 below.
2. The breach of planning control which appears to have taken place consists in the carrying out of development by the making of the material change in the use of the land described in Schedule 2 overleaf without the grant of planning permission required for that development.
3. The Council consider it expedient, having regard to the provisions of the development plan and to all other material considerations, to issue this enforcement notice, in exercise of their powers in the said Section 172 for the reasons set out in this notice.

NOTICE IS HEREBY GIVEN that the Council require that the steps specified in Schedule 3 overleaf be taken in order to remedy the breach within the period of **TWO MONTHS** from the date on which this Notice takes effect.

Subject to the provisions of Section 175(4) of the Act
THIS NOTICE SHALL TAKE EFFECT on 6 JANUARY 1998

P. L. Tennant

SOLICITOR TO THE COUNCIL

DATED 25 November 1997

Schedule 1 - The Site to which this Notice relates

Land at Barnsfield Farm, Hullavington, Wiltshire shown edged by a bold black line on the attached plan ("the land").

Schedule 2 - The Contravention

Unauthorised use of the land for storage purposes not related to the agricultural use of the land.

Schedule 3 - Steps required to taken

1. Remove all vehicles, vehicle parts, machinery, equipment and any other item stored or kept at the site (other than items which can be shown to be necessary for purposes requisite to use of the land locally for agriculture).
2. Cease the use of the premises for storage for any purpose (other than storage which can be shown to be necessary for purposes requisite to use of the land locally for agriculture).

Reasons

1. There is no demonstrable local need for this development and that the use does not accord with the provisions of Policies RE18, RE19 and RC9 of the North Wiltshire Local Plan Review and that the development is to the detriment of the character and amenity of the countryside in an attractive rural area.
2. By virtue of vehicle movements to the site and parking and storage of vehicles and equipment on the forecourt of the building the use is visually intrusive and to the detriment of the amenity of adjacent dwellings and to the visual amenity of this rural area.

Time for Compliance - 2 months form the date on which the Notice takes effect..

North Wiltshire District Council

ENFORCEMENT NOTICE

SITE PLAN

PROPERTY ADDRESS

Land at Barnfield Farm
Hullavington
Wiltshire

REFERENCE

E.96.0021

DESCRIPTION

Unauthorised Use
for Storage Purposes

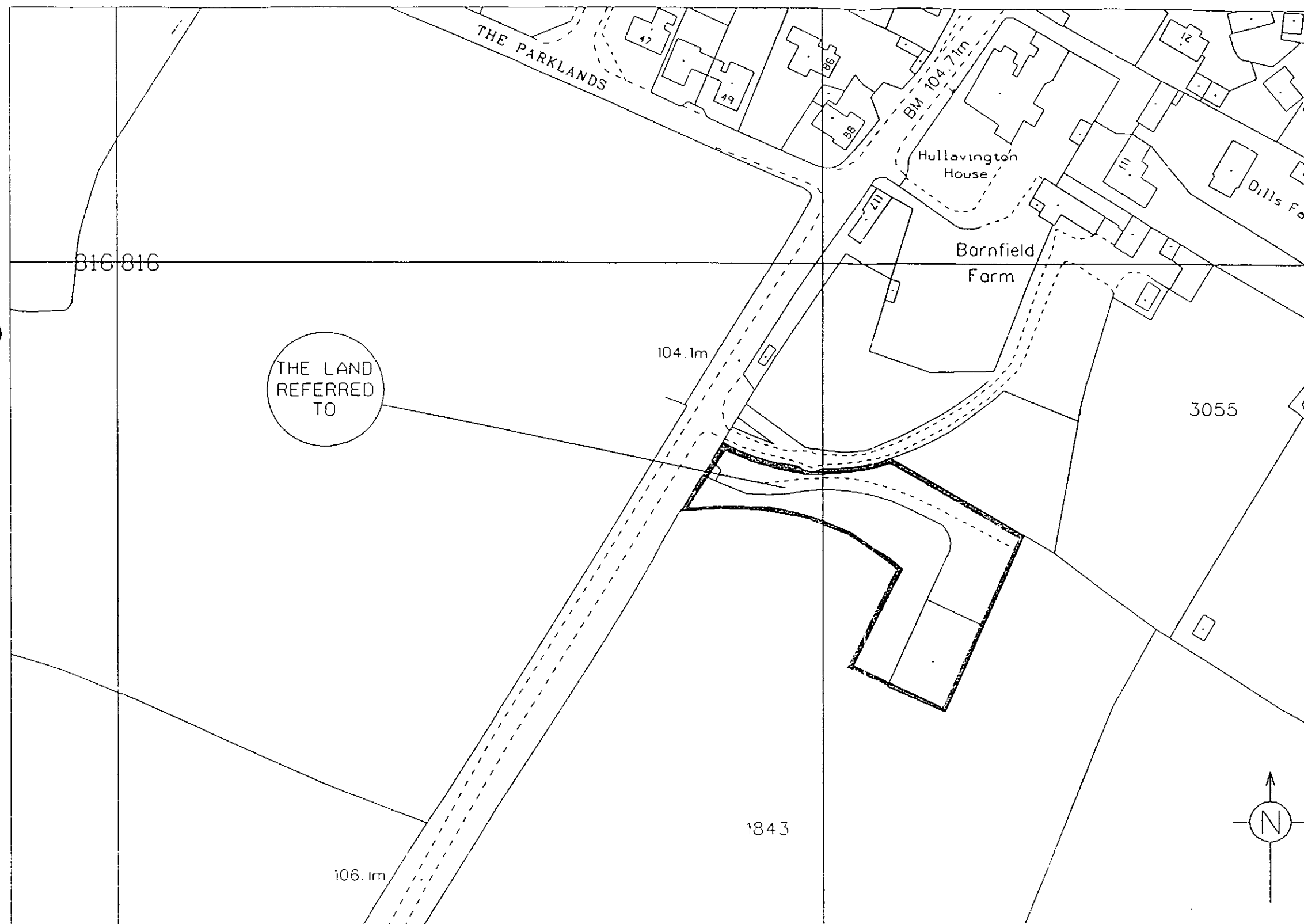

REPRODUCED FROM THE ORDINANCE SURVEY MAPPING WITH THE PERMISSION OF THE CONTROLLER OF HER MAJESTY'S STATIONERY OFFICE.
CROWN COPYRIGHT
UNAUTHORISED REPRODUCTION INFRINGES CROWN COPYRIGHT AND MAY LEAD TO PROSECUTION OR CIVIL PROCEEDINGS
THIS COPY HAS BEEN PRODUCED SPECIFICALLY FOR PLANNING AND BUILDING CONTROL PURPOSES. MAY NOT BE REPRODUCED FOR OTHER PURPOSES
NORTH WILTSHIRE DISTRICT COUNCIL TEL 01296 88301 FAX 01296 88302

OFFICER DEALING CR

SCALE 1:1250

DATE 17/09/97

*North
Wiltshire
District
Council*

ENFORCEMENT NOTICE

SITE PLAN

PROPERTY ADDRESS

**Land at Barnfield Farm
Hullavington
Wiltshire**

REFERENCE

E.96.0021

DESCRIPTION

**Unauthorised Use
for Storage Purposes**

OFFICER DEALING CR

SCALE
1:1250

DATE 17/09/97

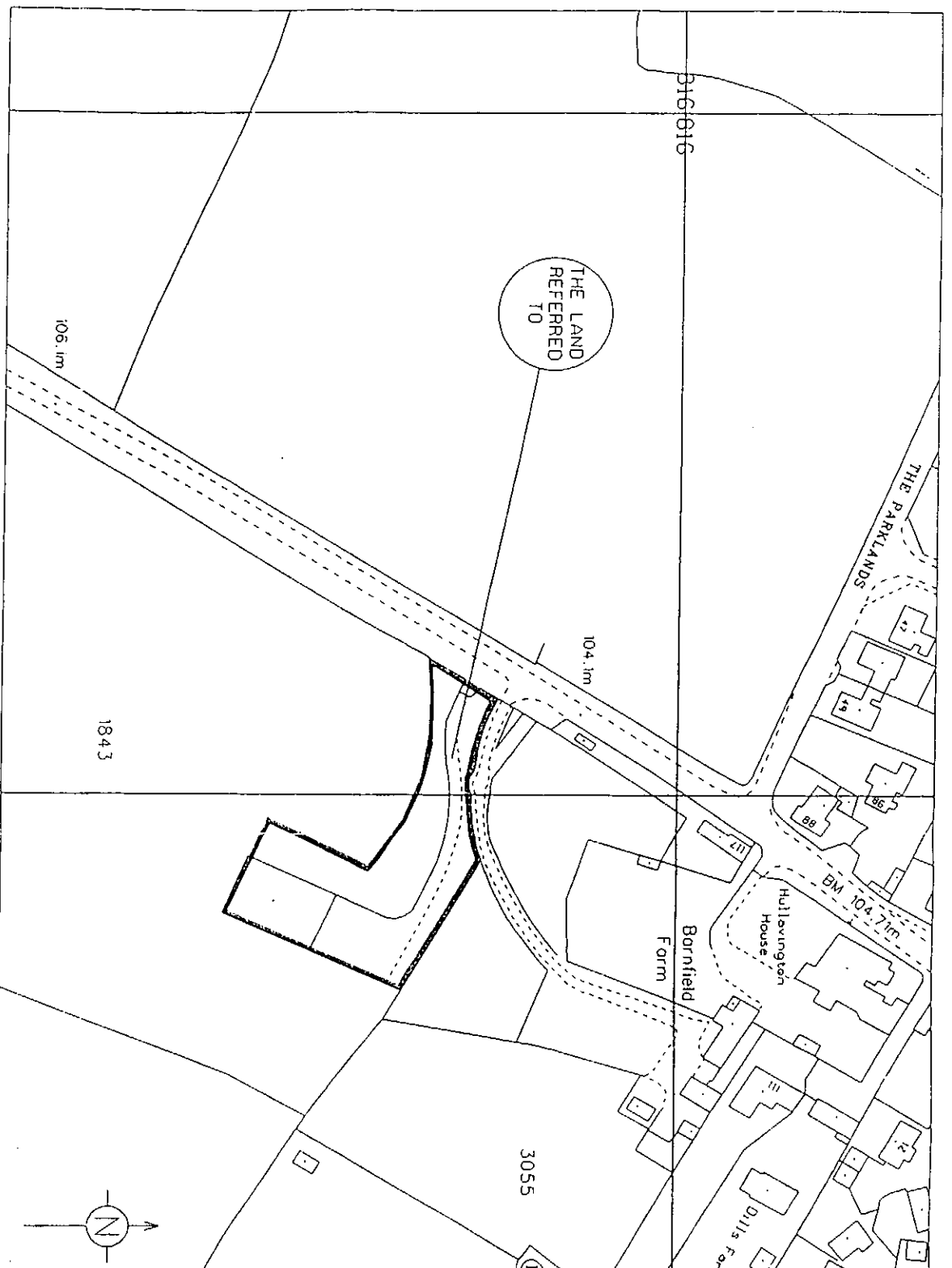

IMPORTANT

**THIS COMMUNICATION AFFECTS
YOUR PROPERTY**

Solicitor to the Council
P L Jeremiah LL.B

Our Ref: PT/CG E97.0021

25 November 1997

Dear Sir

TOWN AND COUNTY PLANNING ACT 1990

ENFORCEMENT NOTICE

Land at Barnsfield Farm, Hullavington, Wiltshire

The Council have issued an Enforcement Notice relating to the above land and I now serve on you a copy of that Notice, in view of your interest in the land. Unless an appeal is made to the Secretary of State as described below, the Notice will take effect on the date shown below and you must then ensure that the required steps for which you may be held responsible are taken within the period or periods specified in the Notice.

If you wish to appeal against the Notice, you should first read carefully the enclosed booklet entitled "Enforcement Notice Appeals - A Guide to Procedure". Then you or your agent should complete the enclosed appeal form and send it, together with the extra copy of the Enforcement Notice enclosed herewith, to the address on the appeal form. Your appeal must be received by the Planning Inspectorate before the notice takes effect.

There is a requirement on the Council to specify the reasons why the local planning authority consider it expedient to issue the Notice and these reasons are set out in the Notice.

Yours faithfully

P L Jeremiah

SOLICITOR TO THE COUNCIL

**DATE ON WHICH THE NOTICE TAKES EFFECT AND BEFORE WHICH ANY APPEAL
MUST BE RECEIVED 6 JANUARY 1998**

To Mr K Edwards
Cowbridge Farm
Malmesbury
Wiltshire
SN16 9LZ

Mr G W Small
38 Parklands
Hullavington
Wiltshire

NatWest Bank
High Street
Chippenham
Wiltshire

*North
Wiltshire
District
Council*

Monkton Park, Chippenham
Wiltshire SN15 1 ER
Telephone (01249) 706111(ex 594)

E97.0021

TOWN AND COUNTRY PLANNING ACT 1990

ENFORCEMENT NOTICE

Land at Barnsfield Farm, Hullavington, Wiltshire

WHEREAS

1. It appears to the North Wiltshire District Council ("the Council") being the local planning authority for the purposes of Section 172 of the Town and Country Planning Act 1990 ("the Act") in this matter, that there has been a breach of planning control, under Section 171A(1)(a), within the last ten years on the land or premises ("the land") described in Schedule 1 below.
2. The breach of planning control which appears to have taken place consists in the carrying out of development by the making of the material change in the use of the land described in Schedule 2 overleaf without the grant of planning permission required for that development.
3. The Council consider it expedient, having regard to the provisions of the development plan and to all other material considerations, to issue this enforcement notice, in exercise of their powers in the said Section 172 for the reasons set out in this notice.

NOTICE IS HEREBY GIVEN that the Council require that the steps specified in Schedule 3 overleaf be taken in order to remedy the breach within the period of **TWO MONTHS** from the date on which this Notice takes effect.

Subject to the provisions of Section 175(4) of the Act

THIS NOTICE SHALL TAKE EFFECT on 6 JANUARY 1998

P L. Tennant

SOLICITOR TO THE COUNCIL

DATED 25 November 1997

Schedule 1 - The Site to which this Notice relates

Land at Barnsfield Farm, Hullavington, Wiltshire shown edged by a bold black line on the attached plan ("the land").

Schedule 2 - The Contravention

Unauthorised use of the land for storage purposes not related to the agricultural use of the land.

Schedule 3 - Steps required to taken

1. Remove all vehicles, vehicle parts, machinery, equipment and any other item stored or kept at the site (other than items which can be shown to be necessary for purposes requisite to use of the land locally for agriculture).
2. Cease the use of the premises for storage for any purpose (other than storage which can be shown to be necessary for purposes requisite to use of the land locally for agriculture).

Reasons

1. There is no demonstrable local need for this development and that the use does not accord with the provisions of Policies RE18, RE19 and RC9 of the North Wiltshire Local Plan Review and that the development is to the detriment of the character and amenity of the countryside in an attractive rural area.
2. By virtue of vehicle movements to the site and parking and storage of vehicles and equipment on the forecourt of the building the use is visually intrusive and to the detriment of the amenity of adjacent dwellings and to the visual amenity of this rural area.

Time for Compliance - 2 months form the date on which the Notice takes effect..

North Wiltshire District Council

ENFORCEMENT NOTICE

SITE PLAN

PROPERTY ADDRESS

Land at Barnfield Farm
Hullavington
Wiltshire

REFERENCE

E.96.0021

DESCRIPTION

Unauthorised Use
for Storage Purposes

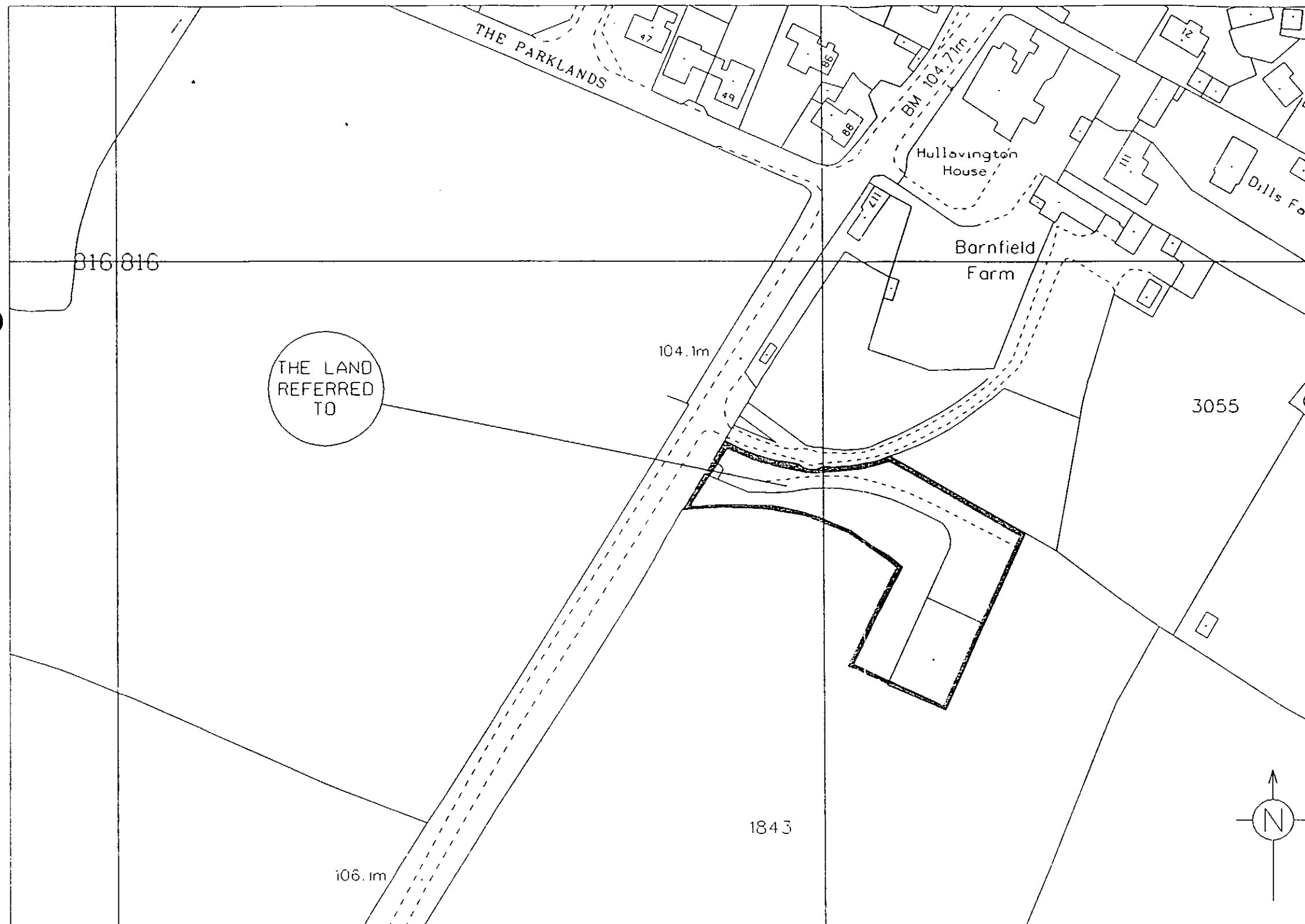

REPRODUCED FROM THE ORDNANCE SURVEY MAPS AT THE PERMISSION OF THE CONTROLLER OF HER MAJESTY'S STATIONERY OFFICE
CROWN COPYRIGHT
UNAUTHORISED REPRODUCTION INFRINGES CROWN COPYRIGHT AND MAY LEAD TO PROSECUTION OR CIVIL PROCEEDINGS
THIS COPY HAS BEEN PRODUCED SPECIFICALLY FOR PLANNING AND BUILDING CONTROL PURPOSES ONLY. NO FURTHER COPIES MAY BE MADE
NORTH WILTSHIRE DISTRICT COUNCIL E.96.0021 1997

OFFICER DEALING CR

SCALE 1:1250

DATE 17/09/97