

Made and published by the Director General of the Ordnance Survey, Southampton.

COMPILED DATA Levelled 1958.59 Boundaries Oct 1972

Abbreviations list including Beer House, Bench Mark, Boundary Post, etc.

SYMBOLS list including Non-coniferous trees, Coniferous trees, Surveyed trees, etc.

VEGETATION CLASSIFICATION: Wooded areas, tree and scrub symbols in woodlands shown.



Table with columns for 'England & Wales' and 'Scotland' detailing boundary symbols.

NATIONAL GRID REFERENCE: The grid lines form part of the national grid and are 100 metres apart.

EASTING: Take west edge of 100 metre square and read the figure.

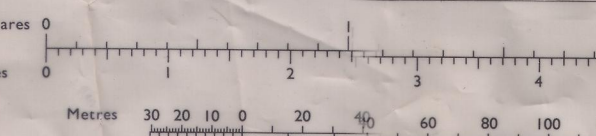

Table with columns for 'England & Wales' and 'Scotland' detailing boundary symbols.

NATIONAL GRID REFERENCE: The grid lines form part of the national grid and are 100 metres apart.

EASTING: Take west edge of 100 metre square and read the figure.

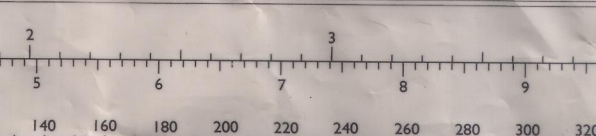

Table with columns for 'England & Wales' and 'Scotland' detailing boundary symbols.

NATIONAL GRID REFERENCE: The grid lines form part of the national grid and are 100 metres apart.

EASTING: Take west edge of 100 metre square and read the figure.

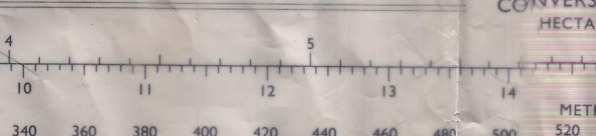

Table with columns for 'England & Wales' and 'Scotland' detailing boundary symbols.

NATIONAL GRID REFERENCE: The grid lines form part of the national grid and are 100 metres apart.

EASTING: Take west edge of 100 metre square and read the figure.

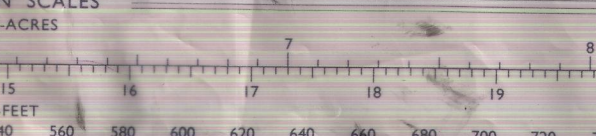

Table with columns for 'England & Wales' and 'Scotland' detailing boundary symbols.

NATIONAL GRID REFERENCE: The grid lines form part of the national grid and are 100 metres apart.

EASTING: Take west edge of 100 metre square and read the figure.

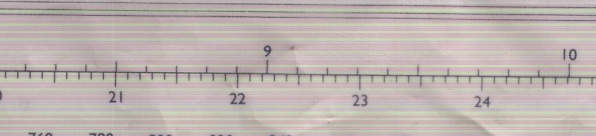

Table with columns for 'England & Wales' and 'Scotland' detailing boundary symbols.

NATIONAL GRID REFERENCE: The grid lines form part of the national grid and are 100 metres apart.

EASTING: Take west edge of 100 metre square and read the figure.

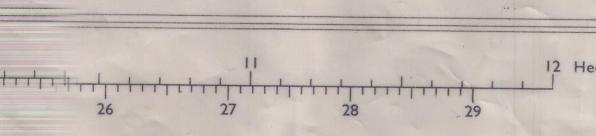

Table with columns for 'England & Wales' and 'Scotland' detailing boundary symbols.

NATIONAL GRID REFERENCE: The grid lines form part of the national grid and are 100 metres apart.

EASTING: Take west edge of 100 metre square and read the figure.

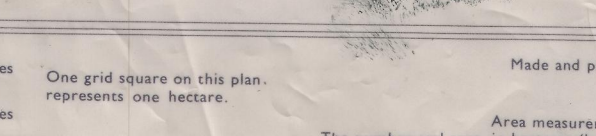

Table with columns for 'England & Wales' and 'Scotland' detailing boundary symbols.

NATIONAL GRID REFERENCE: The grid lines form part of the national grid and are 100 metres apart.

EASTING: Take west edge of 100 metre square and read the figure.

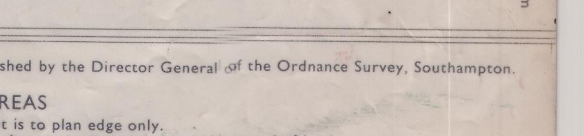

Table with columns for 'England & Wales' and 'Scotland' detailing boundary symbols.

NATIONAL GRID REFERENCE: The grid lines form part of the national grid and are 100 metres apart.

EASTING: Take west edge of 100 metre square and read the figure.